



Western Michigan University  
ScholarWorks at WMU

---

Legacy Scout Tickets from Pure Oil Company

---

8-20-2021

## MGRRE\_PureOilScoutTickets\_State Easement\_1\_21143607897000

MGRRE

*Western Michigan University*

Follow this and additional works at: <https://scholarworks.wmich.edu/pure>



Part of the Geology Commons

---

### WMU ScholarWorks Citation

MGRRE, "MGRRE\_PureOilScoutTickets\_State Easement\_1\_21143607897000" (2021). *Legacy Scout Tickets from Pure Oil Company*. 9195.

<https://scholarworks.wmich.edu/pure/9195>

This Document is brought to you for free and open access via ScholarWorks at WMU. It has been accepted for inclusion in Legacy Scout Tickets from Pure Oil Company by an authorized administrator of ScholarWorks at WMU. See the National Digital Catalogue - Science Base Catalogue for more collections submitted by MGRRE.



---

**MGRRE\_PureOilScoutTickets\_State Easement\_1\_21143607897000**

API 21143607897000

Permit Number GTNP06

Lease Name State Easement

Well Number 1

County Roscommon

Township 21N

Range 04W

Section 31

2021 DEQ or Pure co\_name Pure Oil Company

Pure Number 14

Latitude 44.163748

Longitude -84.851177

THE PURE OIL COMPANY

LOCATION REPORT

No. 14

DATE \_\_\_\_\_

STATE \_\_\_\_\_ COUNTY Roscommon DIST. Roscommon SEC. 31 TOWN 21N RANGE 4W

WELL No. 1 (SERIAL No. 14) FARM State Easement. ACRES \_\_\_\_\_

NAME OF STREAM OR WATERS \_\_\_\_\_ QUADRANGLE NW-SW-SW.

OPERATOR \_\_\_\_\_ Map \_\_\_\_\_

\_\_\_\_\_ Feet from North Line of Farm

\_\_\_\_\_ " " East " " "

\_\_\_\_\_ " " South " " "

\_\_\_\_\_ " " West " " "

\_\_\_\_\_ Feet from North Line of Section

\_\_\_\_\_ " " East " " "

910 " " South " " "

140 " " West " " "

LEGEND

- LOCATION
- ⊙ RIG
- ⊕ DRILLING
- ☀ GAS WELL
- OIL WELL
- ⦿ SMALL OIL WELL
- ⊖ DRY HOLE
- ⦿ DRY SHOWING OIL
- ☀ DRY SHOWING GAS
- ⊖ ABANDONED LOCATION
- ☀ ABANDONED GAS WELL
- ⦿ ABANDONED OIL WELL

NOTE: Below make tracing from map, (when no map is obtainable make sketch) showing farm, center of section, this location with measurements and also wells, dry holes, or other locations in the vicinity of this location.

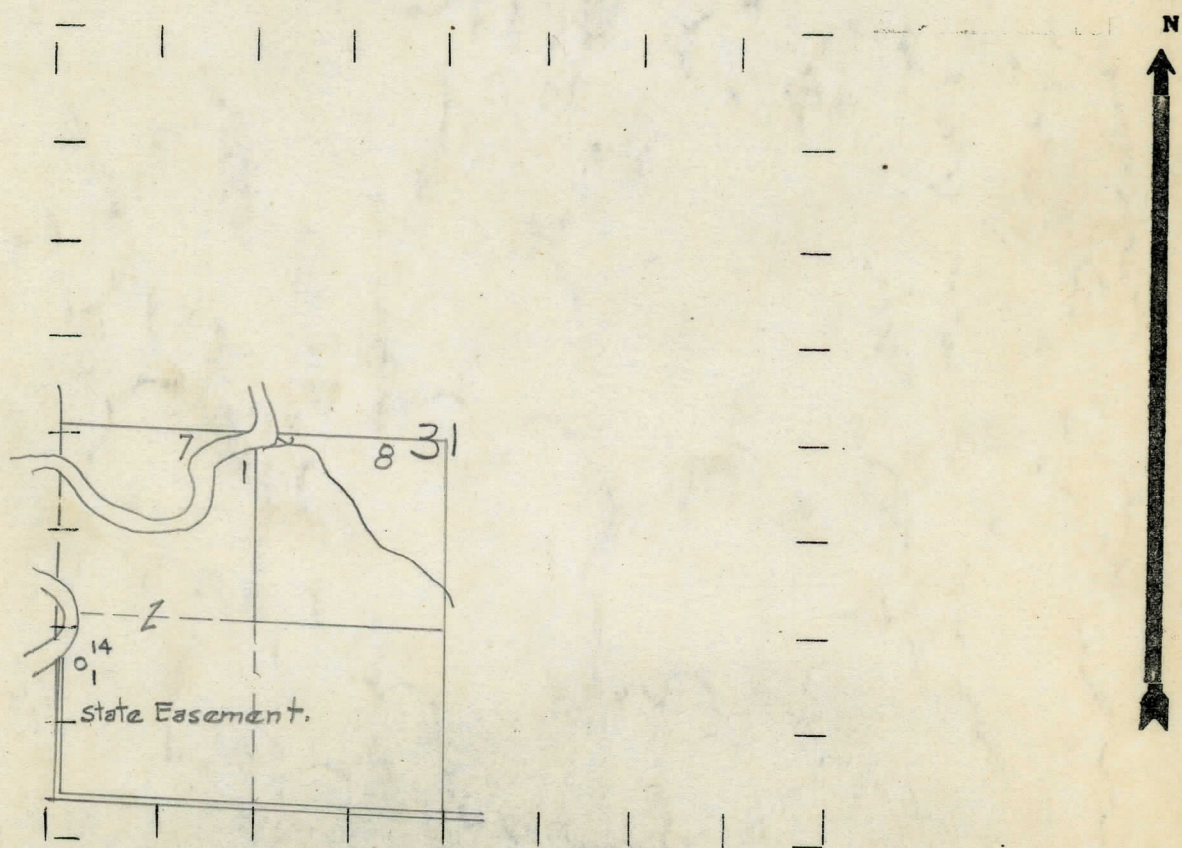

REMARKS: \_\_\_\_\_

SIGNED \_\_\_\_\_

Superintendent or Foreman.