



Western Michigan University
ScholarWorks at WMU

Legacy Scout Tickets from Pure Oil Company

8-20-2021

MGRRE_PureOilScoutTickets_State Easement (Pure core test 43)_13_None

MGRRE

Western Michigan University

Follow this and additional works at: <https://scholarworks.wmich.edu/pure>



Part of the Geology Commons

WMU ScholarWorks Citation

MGRRE, "MGRRE_PureOilScoutTickets_State Easement (Pure core test 43)_13_None" (2021). *Legacy Scout Tickets from Pure Oil Company*. 9211.
<https://scholarworks.wmich.edu/pure/9211>

This Document is brought to you for free and open access via ScholarWorks at WMU. It has been accepted for inclusion in Legacy Scout Tickets from Pure Oil Company by an authorized administrator of ScholarWorks at WMU. See the National Digital Catalogue - Science Base Catalogue for more collections submitted by MGRRE.



MGRRE_PureOilScoutTickets_State Easement (Pure core test 43)_13_None

API None

Permit Number None

Lease Name State Easement (Pure core test 43)

Well Number 13

County Roscommon

Township 24N

Range 01W

Section 20

2021 DEQ or Pure co_name Pure Oil Company

Pure Number 30

Latitude 44.4591721

Longitude -84.461533

THE PURE OIL COMPANY

LOCATION REPORT

DATE March 3, 1939

No. 30

STATE Mich COUNTY Rosecommon DIST. Richfield SEC. 20 TOWN 24 N RANGE 1 W

WELL No. 13 (SERIAL No. 30) FARM State-Easement ACRES _____

NAME OF STREAM OR WATERS _____ QUADRANGLE NE-NW-SE

OPERATOR Pure Oil Co. (Cora Test) Map Richfield Twp - Ros. Co.

100 Feet from North Line of Farm
120 " " East " " "
 " " South " " "
 " " West " " "

100 Feet from North Line of Section
 " " East " " "
 " " South " " "
1200 " " West " " $\frac{1}{4}$ "

LEGEND

○ LOCATION

⊙ RIG

⊕ DRILLING

☀ GAS WELL

● OIL WELL

⦿ SMALL OIL WELL

⊖ DRY HOLE

◆ DRY SHOWING OIL

⊖ DRY SHOWING GAS

⊖ ABANDONED LOCATION

☀ ABANDONED GAS WELL

⦿ ABANDONED OIL WELL

NOTE: Below make tracing from map, (when no map is obtainable make sketch) showing farm, center of section, this location with measurements and also wells, dry holes, or other locations in the vicinity of this location.

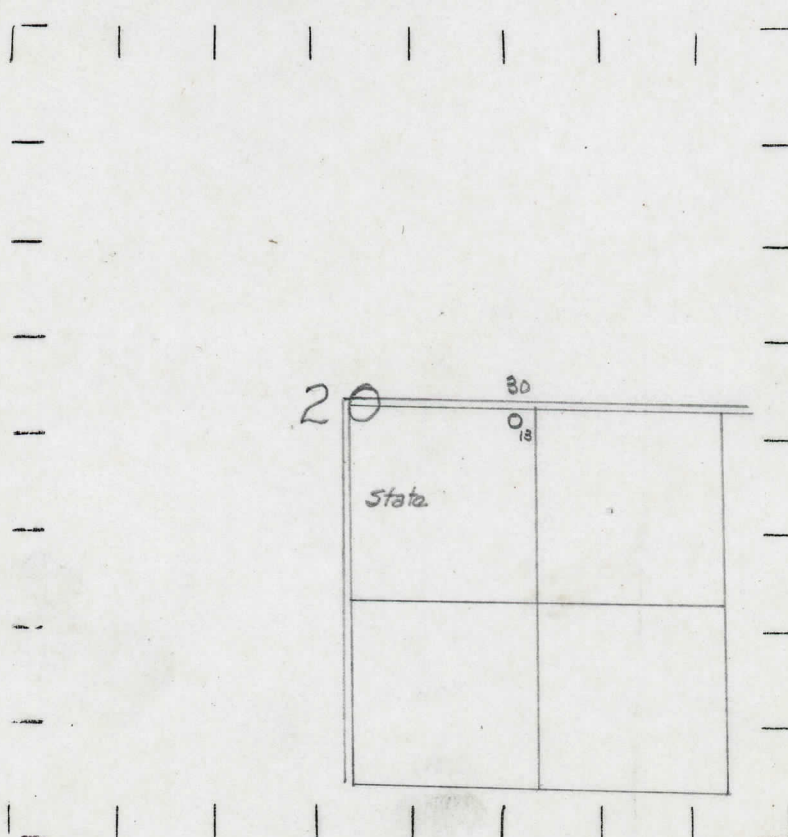

REMARKS:

SIGNED

R. L. Yeager
 Superintendent or Foreman.