



Western Michigan University  
ScholarWorks at WMU

---

Legacy Scout Tickets from Pure Oil Company

---

8-20-2021

## MGRRE\_PureOilScoutTickets\_State Easement\_17\_None

MGRRE

*Western Michigan University*

Follow this and additional works at: <https://scholarworks.wmich.edu/pure>



Part of the Geology Commons

---

### WMU ScholarWorks Citation

MGRRE, "MGRRE\_PureOilScoutTickets\_State Easement\_17\_None" (2021). *Legacy Scout Tickets from Pure Oil Company*. 9219.

<https://scholarworks.wmich.edu/pure/9219>

This Document is brought to you for free and open access via ScholarWorks at WMU. It has been accepted for inclusion in Legacy Scout Tickets from Pure Oil Company by an authorized administrator of ScholarWorks at WMU. See the National Digital Catalogue - Science Base Catalogue for more collections submitted by MGRRE.



---

## MGRRE\_PureOilScoutTickets\_State Easement\_17\_None

API None

Permit Number GT0053

Lease Name State Easement

Well Number 17

County Roscommon

Township 22N

Range 02W

Section 18

2021 DEQ or Pure co\_name Pure Oil Company

Pure Number 38

Latitude 42.300221

Longitude -84.611144

THE PURE OIL COMPANY

LOCATION REPORT

No. 38

DATE Dec. 29, 1939

STATE Mich COUNTY Roscommon DIST. TWP. Backus SEC. 18 TOWN 22N RANGE 2W

WELL No. 17 (SERIAL No. 38) FARM State Easement ACRES

NAME OF STREAM OR WATERS QUADRANGLE NW-SW-NW

OPERATOR Pure Oil Co. (Core Test) Map Backus Twp - Ros. Co.

540 Feet from North Line of Farm

" " East " " "

" " South " " "

160 " " West " " "

Feet from North Line of Section

" " East " " "

780 " " South " "  $\frac{1}{4}$  "

160 " " West " " "

LEGEND

- LOCATION
- ⊕ RIG
- ⊕ DRILLING
- ☀ GAS WELL
- OIL WELL
- ⊕ SMALL OIL WELL
- ⊖ DRY HOLE
- ⊕ DRY SHOWING OIL
- ☀ DRY SHOWING GAS
- ⊖ ABANDONED LOCATION
- ☀ ABANDONED GAS WELL
- ⊖ ABANDONED OIL WELL

NOTE: Below make tracing from map. (when no map is obtainable make sketch) showing farm, center of section, this location with measurements and also wells, dry holes, or other locations in the vicinity of this location.

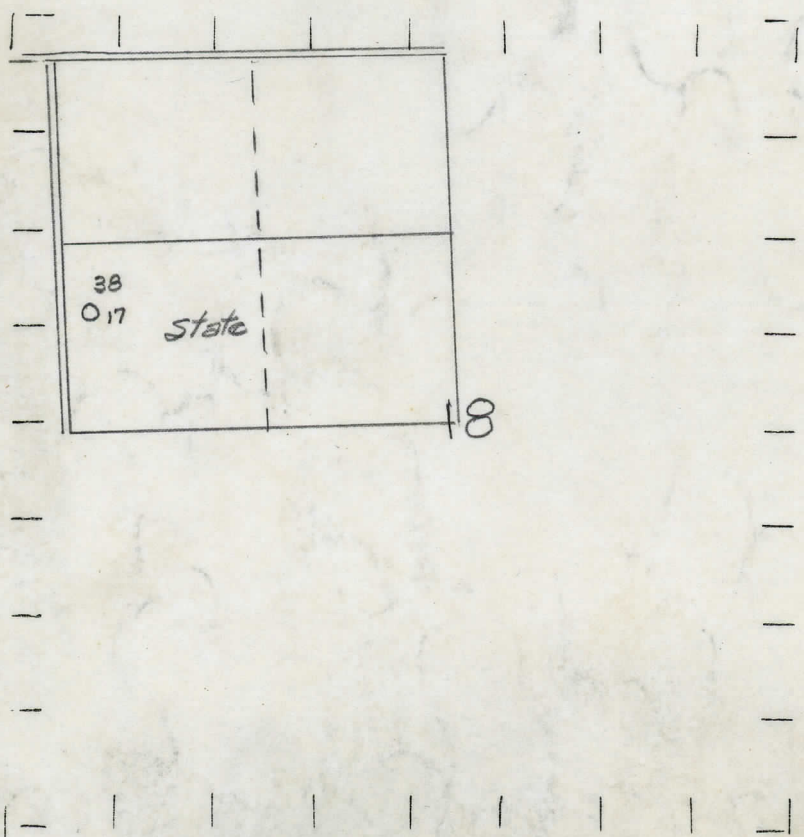

REMARKS:

SIGNED R. L. Yeager  
Superintendent or Foreman.