



Western Michigan University  
ScholarWorks at WMU

---

Legacy Scout Tickets from Pure Oil Company

---

8-20-2021

## MGRRE\_PureOilScoutTickets\_State of Michigan\_D-6\_na

MGRRE

*Western Michigan University*

Follow this and additional works at: <https://scholarworks.wmich.edu/pure>



Part of the Geology Commons

---

### WMU ScholarWorks Citation

MGRRE, "MGRRE\_PureOilScoutTickets\_State of Michigan\_D-6\_na" (2021). *Legacy Scout Tickets from Pure Oil Company*. 9325.

<https://scholarworks.wmich.edu/pure/9325>

This Document is brought to you for free and open access via ScholarWorks at WMU. It has been accepted for inclusion in Legacy Scout Tickets from Pure Oil Company by an authorized administrator of ScholarWorks at WMU. See the National Digital Catalogue - Science Base Catalogue for more collections submitted by MGRRE.



---

**MGRRE\_PureOilScoutTickets\_State of Michigan\_D-6\_na**

API na

Permit Number na

Lease Name State of Michigan

Well Number D-6

County Roscommon

Township 21N

Range 03W

Section 16

2021 DEQ or Pure co\_name Hilliard, Eugene

Pure Number 166

Latitude 44.2112531

Longitude -84.6804525

# THE PURE OIL COMPANY LOCATION REPORT

Date November 20, 1946 A.F.E. No. State Michigan  
 Division Mich. Producing District \_\_\_\_\_ Lease State Michigan  
 Acres \_\_\_\_\_ Lease No. \_\_\_\_\_ Elevation \_\_\_\_\_ Well No. D-6 (Serial No. 166)  
 Quadrangle C SW Sec. 16 Twp. 21 N Rge. 3 W ~~OSK~~ ~~OSK~~ Roscommon  
 Survey \_\_\_\_\_ County Roscommon State Michigan  
 Operator Eugene Hilliard Map Roscommon Township, Roscommon County

Feet from North Line of Lease	
<u>1320</u>	<u>1320</u>
" "	East " " "
" "	South " " "
" "	West " " "
Feet from North Line of Section	
<u>1320</u>	<u>1320</u>
" "	East " " "
" "	South " <u>1/4</u> "
" "	West " " "

*Low*

**LEGEND**

- ☀ Gas Well
- Oil Well
- ☀ Gas - Distillate Well
- ⊙ or ○ Dry Hole
- Dry Showing Oil
- Location
- ☀ Dry Showing Gas
- ⊙ Abandoned Location
- ☀ or ☀ Abandoned Gas Well
- or ● Abandoned Oil Well
- ⊙ or ⊙ Input Well

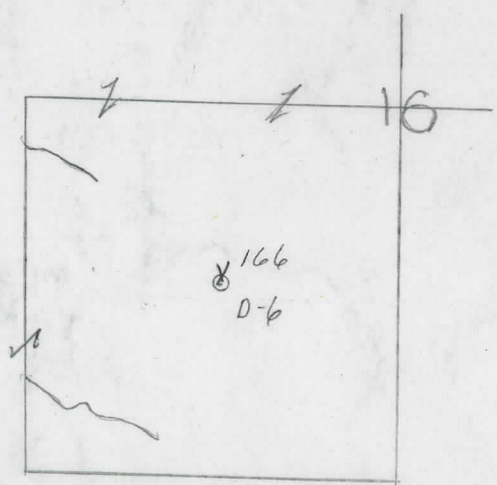

*Loc. Abandoned 4-26-48*

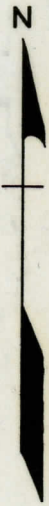

Remarks: \_\_\_\_\_ Scale \_\_\_\_\_

Submitted by \_\_\_\_\_ Civil Engineer Approved by \_\_\_\_\_ Division Manager  
 Approved by \_\_\_\_\_ Vice-President - General Manager