



Western Michigan University  
ScholarWorks at WMU

---

Legacy Scout Tickets from Pure Oil Company

---

8-20-2021

## MGRRE\_PureOilScoutTickets\_State of Michigan, State Roscommon\_D7\_21143127960000

MGRRE

*Western Michigan University*

Follow this and additional works at: <https://scholarworks.wmich.edu/pure>



Part of the Geology Commons

---

### WMU ScholarWorks Citation

MGRRE, "MGRRE\_PureOilScoutTickets\_State of Michigan, State Roscommon\_D7\_21143127960000" (2021). *Legacy Scout Tickets from Pure Oil Company*. 9326.  
<https://scholarworks.wmich.edu/pure/9326>

This Document is brought to you for free and open access via ScholarWorks at WMU. It has been accepted for inclusion in Legacy Scout Tickets from Pure Oil Company by an authorized administrator of ScholarWorks at WMU. See the National Digital Catalogue - Science Base Catalogue for more collections submitted by MGRRE.



---

**MGRRE\_PureOilScoutTickets\_State of Michigan, State  
Roscommon\_D7\_21143127960000**

API 21143127960000

Permit Number 12796

Lease Name State of Michigan, State Roscommon

Well Number D7

County Roscommon

Township 21N

Range 03W

Section 21

2021 DEQ or Pure co\_name Farmers Crude Production Company

Pure Number 167

Latitude 44.19985

Longitude -84.68555

WELL REPORT—OUTSIDE OPERATIONS

THE PURE O

Headquarters Gas 1946 SERIAL NO. 167

STATE Michigan MSH CO. Roscommon

OPERATOR Eugene Hilliard

FARM State-Roscommon WELL NO. D-7

TWP. Roscommon SURVEY S. 21 T. 21N R. 3W

LOC. C NW - 1090' from south and 1270' from west line of quarter section.

MAP NO. CO-ORD. ELEV.

STATUS

12,120,000 CF

Previously located in C NW

NORTH

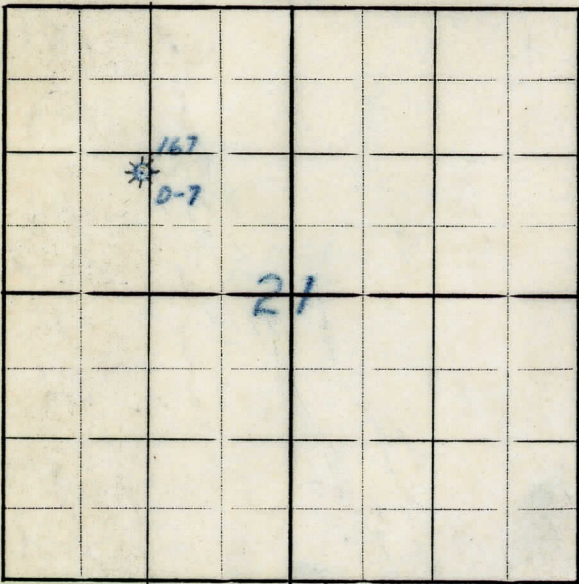

DATE 10-20-47 SCOUT H. J. G.

OBSERVATION  
 DIVISION  
 DATE

L COMPANY

LOCATION REPORT

A.F.E. No. State-Roscommon  
 Lease State-Roscommon

Division Mich. Producing District \_\_\_\_\_ Lease \_\_\_\_\_  
 Acres \_\_\_\_\_ Lease No. \_\_\_\_\_ Elevation \_\_\_\_\_ Well No. D-7 (Serial No. 167)  
 Quadrangle C NW Sec. 21 Twp. 21 N Rge. 3 W Twp. Roscommon  
 Survey \_\_\_\_\_ County Roscommon State Michigan  
 Operator Eugene Hilliard Map Roscommon Township, Roscommon County

<u>1320</u>	<u>1320</u>	Feet from North Line of Lease
<u>1320</u>	<u>1320</u>	" " East " " "
		" " South " " "
		" " West " " "
		Feet from North Line of Section
<u>1320</u>	<u>1320</u>	" " East " " "
<u>1320</u>	<u>1320</u>	" " South " <u>1/4</u> "
		" " West " " "

- LEGEND**
- Location
  - ☀ Gas Well
  - Oil Well
  - ☀ Gas - Distillate Well
  - ∅ or ○ Dry Hole
  - Dry Showing Oil
  - ☀ Dry Showing Gas
  - ⊗ Abandoned Location
  - ☀ or ⊗ Abandoned Gas Well
  - or ● Abandoned Oil Well
  - or ○ Input Well

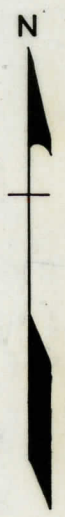
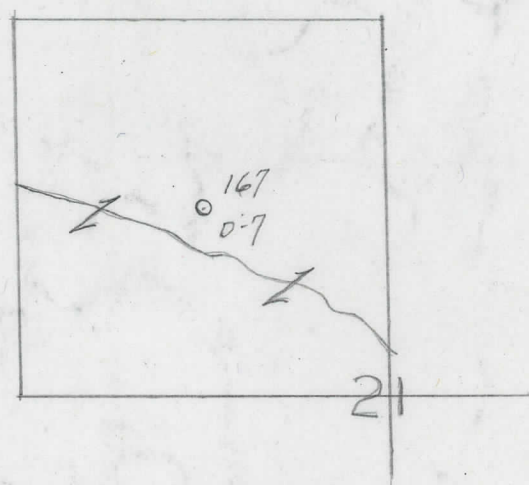

Remarks: \_\_\_\_\_  
 \_\_\_\_\_  
 \_\_\_\_\_

Scale \_\_\_\_\_

Submitted by CB Civil Engineer Approved by \_\_\_\_\_ Division Manager  
 Approved by \_\_\_\_\_ Vice-President - General Manager