



Western Michigan University
ScholarWorks at WMU

Legacy Scout Tickets from Pure Oil Company

8-20-2021

MGRRE_PureOilScoutTickets_State of Michigan, State Roscommon_E-5_21143127970000

MGRRE

Western Michigan University

Follow this and additional works at: <https://scholarworks.wmich.edu/pure>



Part of the Geology Commons

WMU ScholarWorks Citation

MGRRE, "MGRRE_PureOilScoutTickets_State of Michigan, State Roscommon_E-5_21143127970000" (2021). *Legacy Scout Tickets from Pure Oil Company*. 9327.
<https://scholarworks.wmich.edu/pure/9327>

This Document is brought to you for free and open access via ScholarWorks at WMU. It has been accepted for inclusion in Legacy Scout Tickets from Pure Oil Company by an authorized administrator of ScholarWorks at WMU. See the National Digital Catalogue - Science Base Catalogue for more collections submitted by MGRRE.



**MGRRE_PureOilScoutTickets_State of Michigan, State
Roscommon_E-5_21143127970000**

API 21143127970000

Permit Number 12797

Lease Name State of Michigan, State Roscommon

Well Number E-5

County Roscommon

Township 21N

Range 03W

Section 17

2021 DEQ or Pure co_name Hilliard, Eugene

Pure Number 168

Latitude 44.20767

Longitude -84.70552

WELL REPORT - OUTSIDE OPERATIONS

SERIAL NO. 168

STATE Michigan ~~XXXX~~ ^{PSH} Roscommon _{CO.}

OPERATOR Eugene Hilliard

FARM State-Roscommon "E" WELL NO. 5

~~XXXX~~ TWP Roscommon S. 17 T. 21N R. 3W

LOC. C SW

WILDCAT FIELD FIELD NAME _____

MAP NO. _____ CO-ORD. _____ ELEV. _____

STATUS Total Depth 1351'.

Plugged and abandoned 11-3-49.

NORTH

DATE 12-19-49 SCOUT H. J. G.

**THE PURE OIL COMPANY
LOCATION REPORT**

Date November 20, 1946

A.F.E. No. State-Roscommon
State-Roscommon

Division Mich. Producing District _____

Lease _____

Acres _____ Lease No. _____ Elevation _____ Well No. E-5 (Serial No. 168)

Quadrangle C SW SW Sec. 17 Twp. 21 N Rge. 3 W Twp. Roscommon

Survey _____ County Roscommon State Michigan

Operator Eugene Hilliard Map Roscommon Township, Roscommon County

<u>1320</u>	<u>1320</u>	Feet from North Line of Lease
<u>1320</u>	<u>1320</u>	" " East " " "
		" " South " " "
		" " West " " "
		Feet from North Line of Section
<u>1320</u>	<u>1320</u>	" " East " " "
<u>1320</u>	<u>1320</u>	" " South " <u>1/4</u> "
		" " West " " "

LEGEND

- Location
- ☀ Gas Well
- Oil Well
- ☀ Gas - Distillate Well
- ∅ or ○ Dry Hole
- Dry Showing Oil
- ☀ Dry Showing Gas
- ⊗ Abandoned Location
- ☀ or ☀ Abandoned Gas Well
- or ● Abandoned Oil Well
- or ○ Input Well

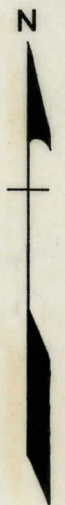
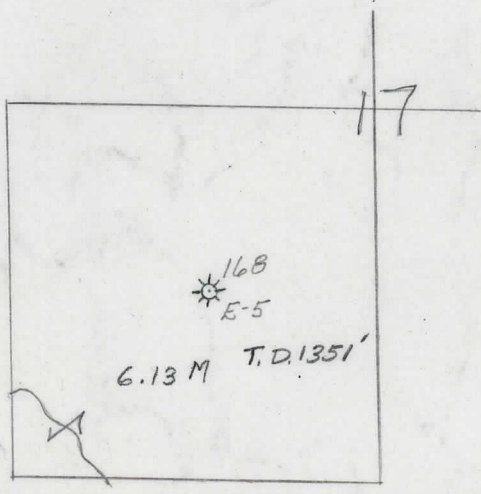

Remarks: _____

Scale _____

Submitted by CB Civil Engineer Approved by _____ Division Manager

Approved by _____ Vice-President - General Manager