



Western Michigan University
ScholarWorks at WMU

Legacy Scout Tickets from Pure Oil Company

8-20-2021

MGRRE_PureOilScoutTickets_Loesel, Conrad_1_21145005219000

MGRRE

Western Michigan University

Follow this and additional works at: <https://scholarworks.wmich.edu/pure>



Part of the Geology Commons

WMU ScholarWorks Citation

MGRRE, "MGRRE_PureOilScoutTickets_Loesel, Conrad_1_21145005219000" (2021). *Legacy Scout Tickets from Pure Oil Company*. 9335.

<https://scholarworks.wmich.edu/pure/9335>

This Document is brought to you for free and open access via ScholarWorks at WMU. It has been accepted for inclusion in Legacy Scout Tickets from Pure Oil Company by an authorized administrator of ScholarWorks at WMU. See the National Digital Catalogue - Science Base Catalogue for more collections submitted by MGRRE.



MGRRE_PureOilScoutTickets_Loesel, Conrad_1_21145005219000

API 21145005219000

Permit Number None

Lease Name Loesel, Conrad

Well Number 1

County Saginaw

Township 11N

Range 06E

Section 9

2021 DEQ or Pure co_name McClure, Charles, W.

Pure Number 7

Latitude 43.3721268

Longitude -83.768792

THE PURE OIL COMPANY
LOCATION REPORT

No. 7

DATE February 19 1934

STATE Michigan COUNTY Saginaw DIST. Frankenmuth SEC. 9 TOWN 11 N RANGE 6 E
WELL No. 1 (SERIAL No. 7) FARM Conrad Loesel ACRES

NAME OF STREAM OR WATERS _____ QUADRANGLE C.-W.L.-SW

OPERATOR McClure MAP Frankenmuth Township, Saginaw County

_____ Feet from North Line of Farm

_____ " " East " " "
_____ " " South " " "
_____ " " West " " "

_____ Feet from North Line of Section

_____ " " East " " "
1400 " " South " " "
300 " " West " " "

LEGEND

- LOCATION
- ① RIG
- ⊕ DRILLING
- ⊛ GAS WELL
- OIL WELL
- ⦿ SMALL OIL WELL
- ⊛ DRY HOLE
- ⦿ DRY SHOWING OIL
- ⊛ DRY SHOWING GAS
- ⦿ ABANDONED LOCATION
- ⊛ ABANDONED GAS WELL
- ⦿ ABANDONED OIL WELL

NOTE: Below make tracing from map, (when no map is obtainable make sketch) showing farm, center of section, this location with measurements and also wells, dry holes, or other locations in the vicinity of this location. Make copy to keep for reference and send original to Columbus office.

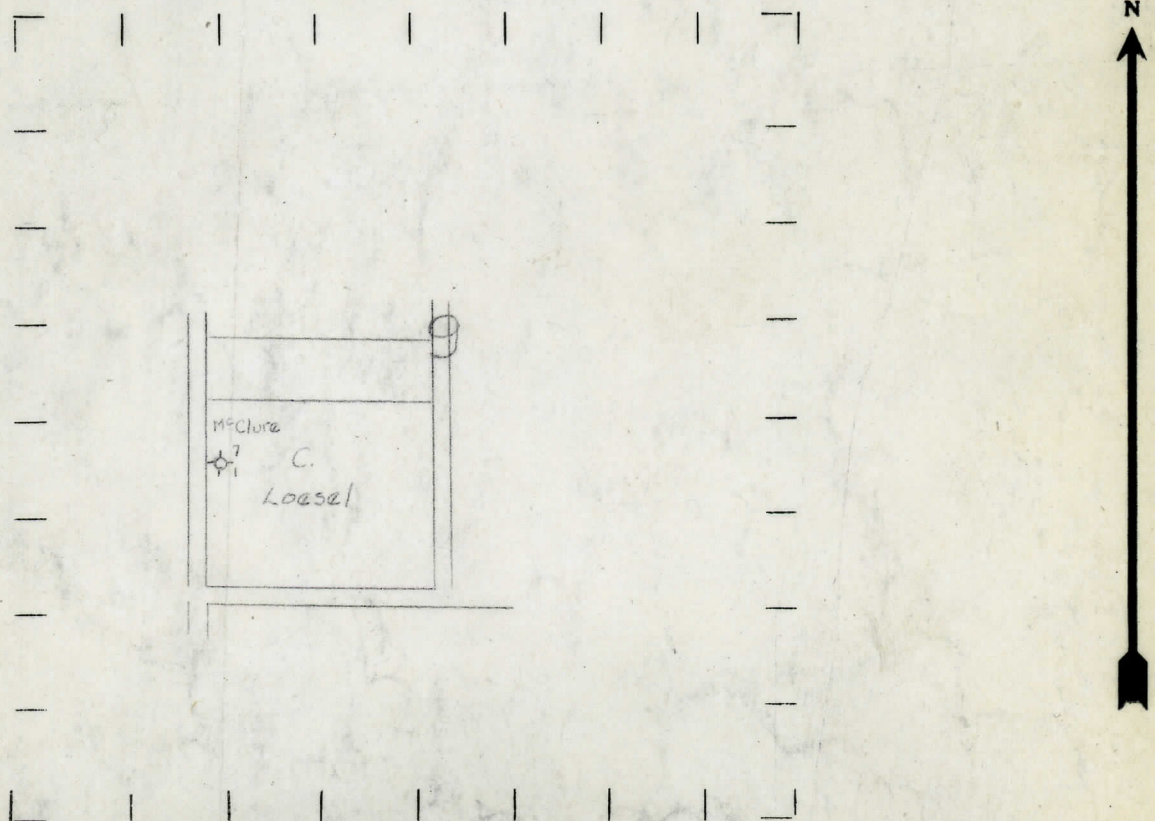

REMARKS: Elevation 638' - Total Depth 2930' - Marshall 629-693' - Berea 1826-1905' - Water 1834'
Traverse 2300' - Dundee 2886' - Water 2930'

SIGNED

R. d. Yea
Superintendent or Foreman.