



Western Michigan University  
ScholarWorks at WMU

---

Legacy Scout Tickets from Pure Oil Company

---

8-20-2021

**MGRRE\_PureOilScoutTickets\_Marshall, Jane\_1\_21145004059000**

MGRRE

*Western Michigan University*

Follow this and additional works at: <https://scholarworks.wmich.edu/pure>



Part of the Geology Commons

---

#### **WMU ScholarWorks Citation**

MGRRE, "MGRRE\_PureOilScoutTickets\_Marshall, Jane\_1\_21145004059000" (2021). *Legacy Scout Tickets from Pure Oil Company*. 9350.

<https://scholarworks.wmich.edu/pure/9350>

This Document is brought to you for free and open access via ScholarWorks at WMU. It has been accepted for inclusion in Legacy Scout Tickets from Pure Oil Company by an authorized administrator of ScholarWorks at WMU. See the National Digital Catalogue - Science Base Catalogue for more collections submitted by MGRRE.



---

**MGRRE\_PureOilScoutTickets\_Marshall, Jane\_1\_21145004059000**

API 21145004059000

Permit Number 405

Lease Name Marshall, Jane

Well Number 1

County Saginaw

Township 12N

Range 04E

Section 16

2021 DEQ or Pure co\_name Vorhees, V.M. and Company

Pure Number 89

Latitude 43.43689

Longitude -84.0146

THE PURE OIL COMPANY

LOCATION REPORT

No. 89

DATE February 19, 1934

STATE Michigan COUNTY Saginaw DIST. TWP. Saginaw SEC. 16 TOWN 12 N. RANGE 4 E

WELL No. 1 (SERIAL No. 89) FARM Marshall ACRES

NAME OF STREAM OR WATERS QUADRANGLE C.N.L.-SE-NW

OPERATOR R. W. Webb et al (Voorhies Test) MAP Saginaw Township, Saginaw County

Feet from North Line of Farm

East " " "

South " " "

West " " "

Feet from North Line of Section

East " " "

1120

South " " "

1950

West " " "

LEGEND

- LOCATION
- ⊙ RIG
- ⊕ DRILLING
- ⊗ GAS WELL
- OIL WELL
- ⊖ SMALL OIL WELL
- ⊛ DRY HOLE
- ⊕ DRY SHOWING OIL
- ⊗ DRY SHOWING GAS
- ⊖ ABANDONED LOCATION
- ⊗ ABANDONED GAS WELL
- ⊖ ABANDONED OIL WELL

NOTE: Below make tracing from map, (when no map is obtainable make sketch) showing farm, center of section, this location with measurements and also wells, dry holes, or other locations in the vicinity of this location. Make copy to keep for reference and send original to Columbus office.

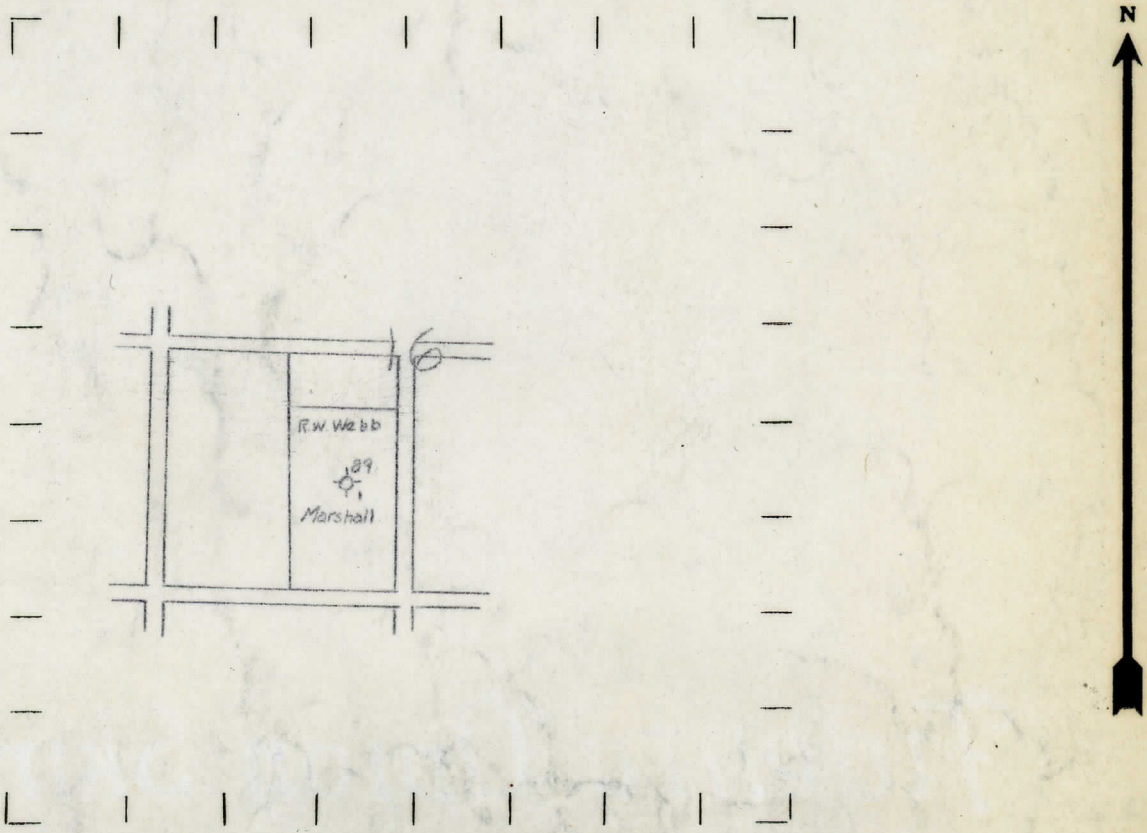

REMARKS: Elevation 628' - Completed 10/22/26 - Dry Hole - Total Depth 2056' - Marshall 825' - Berea 2031-2056' -

SIGNED

R. A. Meager

Superintendent or Foreman.