



Western Michigan University  
ScholarWorks at WMU

---

Legacy Scout Tickets from Pure Oil Company

---

8-20-2021

## MGRRE\_PureOilScoutTickets\_Hemmeter (Saginaw Props Co E#21)\_1\_21145004049000

MGRRE

*Western Michigan University*

Follow this and additional works at: <https://scholarworks.wmich.edu/pure>



Part of the Geology Commons

---

### WMU ScholarWorks Citation

MGRRE, "MGRRE\_PureOilScoutTickets\_Hemmeter (Saginaw Props Co E#21)\_1\_21145004049000" (2021).  
*Legacy Scout Tickets from Pure Oil Company*. 9351.  
<https://scholarworks.wmich.edu/pure/9351>

This Document is brought to you for free and open access via ScholarWorks at WMU. It has been accepted for inclusion in Legacy Scout Tickets from Pure Oil Company by an authorized administrator of ScholarWorks at WMU. See the National Digital Catalogue - Science Base Catalogue for more collections submitted by MGRRE.



---

**MGRRE\_PureOilScoutTickets\_Hemmeter (Saginaw Props Co  
E#21)\_1\_21145004049000**

API 21145004049000

Permit Number 404

Lease Name Hemmeter (Saginaw Props Co E#21)

Well Number 1

County Saginaw

Township 12N

Range 04E

Section 21

2021 DEQ or Pure co\_name Saginaw Prospecting Company

Pure Number 96

Latitude 43.42257

Longitude -84.01462

THE PURE OIL COMPANY

DATE February 19, 1934

LOCATION REPORT

No. 96

STATE Michigan COUNTY Saginaw DIST. Saginaw TWP. Saginaw SEC. 21 TOWN 12 N RANGE 4 E

WELL No. 1 (SERIAL No. 96) FARM Wm. Hemmeter PREC. \_\_\_\_\_ ACRES \_\_\_\_\_

NAME OF STREAM OR WATERS \_\_\_\_\_ QUADRANGLE C-NE-SW

OPERATOR Saginaw Prospecting Company (#21) MAP Saginaw Township, Saginaw County

\_\_\_\_\_ Feet from North Line of Farm

\_\_\_\_\_ " " East " " "

\_\_\_\_\_ " " South " " "

\_\_\_\_\_ " " West " " "

\_\_\_\_\_ Feet from North Line of Section

\_\_\_\_\_ " " East " " "

2030 " " South " " "

1850 " " West " " "

LEGEND

- O LOCATION
- ① RIG
- ⊕ DRILLING
- ⊛ GAS WELL
- OIL WELL
- ⊙ SMALL OIL WELL
- ⊛ DRY HOLE
- ⊛ DRY SHOWING OIL
- ⊛ DRY SHOWING GAS
- ⊙ ABANDONED LOCATION
- ⊛ ABANDONED GAS WELL
- ⊙ ABANDONED OIL WELL

NOTE: Below make tracing from map, (when no map is obtainable make sketch) showing farm, center of section, this location with measurements and also wells, dry holes, or other locations in the vicinity of this location. Make copy to keep for reference and send original to Columbus office.

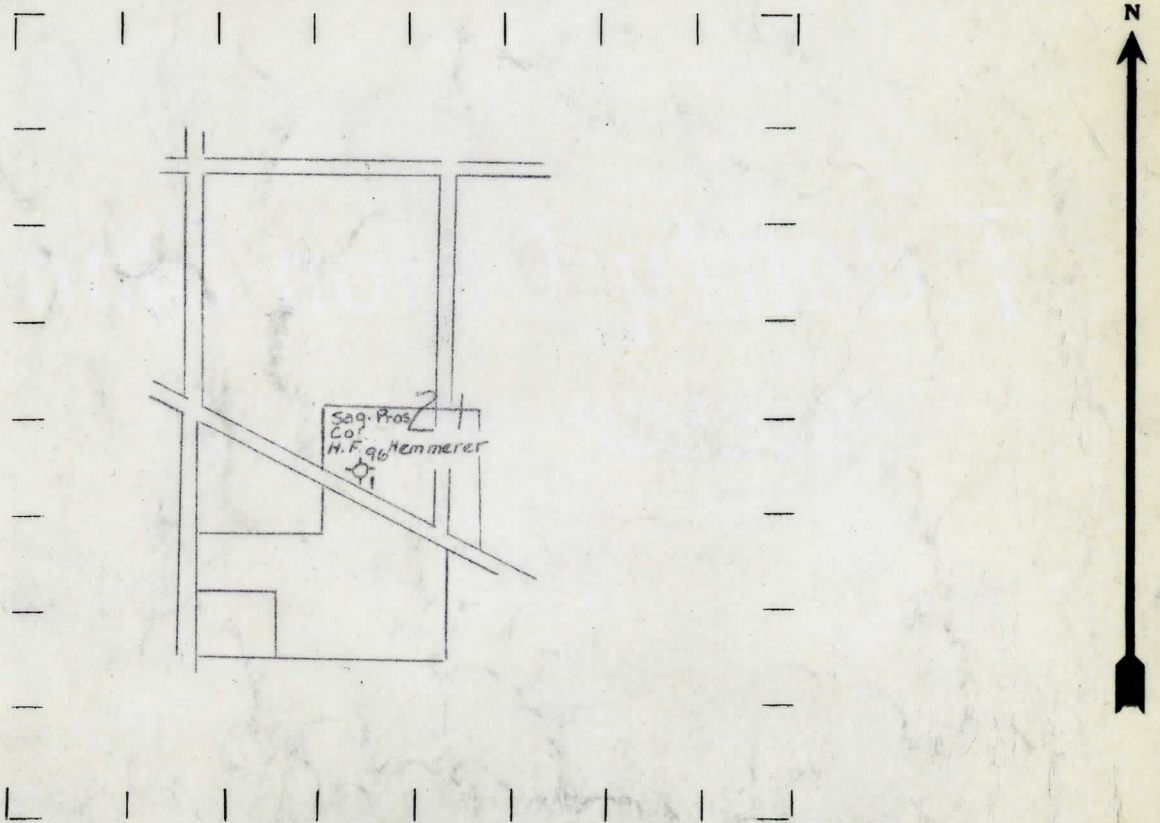

REMARKS: Information from O. & G. Journal 1/13/27 & 12/29/26 - Elevation 627' - Completed 1926  
Total Depth 3395' - Berea 2056' - Saginaw Sand 2528' - Dundee 3120' - Water 3395'

SIGNED R. A. Yeager  
 Superintendent or Foreman.