



Western Michigan University
ScholarWorks at WMU

Legacy Scout Tickets from Pure Oil Company

8-20-2021

**MGRRE_PureOilScoutTickets_CRANDALL S
S_1_21011036890000**

MGRRE
Western Michigan University

Follow this and additional works at: <https://scholarworks.wmich.edu/pure>



Part of the Geology Commons

WMU ScholarWorks Citation

MGRRE, "MGRRE_PureOilScoutTickets_CRANDALL S S_1_21011036890000" (2021). *Legacy Scout Tickets from Pure Oil Company*. 42.
<https://scholarworks.wmich.edu/pure/42>

This Document is brought to you for free and open access via ScholarWorks at WMU. It has been accepted for inclusion in Legacy Scout Tickets from Pure Oil Company by an authorized administrator of ScholarWorks at WMU. See the National Digital Catalogue - Science Base Catalogue for more collections submitted by MGRRE.



MGRRE_PureOilScoutTickets_CRANDALL S S_1_21011036890000

API 21011036890000

Permit Number 3689

Lease Name CRANDALL S S

Well Number 1

County Arenac

Township 20N

Range 4E

Section 10

2021 DEQ or Pure co_name SUMMIT PETROLEUM CORP

Pure Number 47

Latitude 44.1516904

Longitude -83.9760208

THE PURE OIL COMPANY
THE PURE OIL COMPANY

Date Dec. 21, 1946 Corrected LOCATION REPORT A.F.E. No. _____
 Division Mich. Producing District _____ Lease S. S. Crandall
 Acres _____ Lease No. _____ Elevation _____ Well No. 1 (Serial No. 47)
 Quadrangle NW SW NE Sec. 10 Twp. 20 N Rge. 4 E ~~SW NE~~ ~~SW NE~~ Twp. Clayton
 Survey _____ County Arenac State Michigan
 Operator Turner Petroleum Corp. Map Clayton Township, Arenac County

____ Feet from North Line of Lease
 " " East " " "
 " " South " " "
 " " West " " "
 ____ Feet from North Line of Section
 " " East " " "
 " " South " " "
 " " West " " "

LEGEND

○ Location

☀ Gas Well
 ● Oil Well
 ☀ Gas - Distillate Well
 ☉ or ○ Dry Hole
 ☉ Dry Showing Oil
 ☉ Dry Showing Gas
 ☉ Abandoned Location
 ☉ or ☉ Abandoned Gas Well
 ● or ● Abandoned Oil Well
 ● or ○ Input Well

See plat - Arenac #47.

N

Remarks: Change of operator.

Scale _____

Submitted by Scouting Dept.

Approved by _____

Division Manager

Approved by _____

Vice-President - General Manager

DATE June 5, 1939 Corrected LOCATION REPORT No. 47
 STATE Michigan COUNTY Arenac DIST. Clayton SEC. 16 TOWN 20 N RANGE 4 E
 WELL No. 1 (SERIAL No. 47) FARM S. S. Crandall ACRES 4 E
 NAME OF STREAM OR WATERS _____ QUADRANGLE NW-SW-NE

OPERATOR Great Western Petroleum Corp. Map Clayton Township, Arenac County
33830 Feet from North Line of Farm Clayton - Arenac

“ “ East “ “ “
 “ “ South “ “ “
33830 “ “ West “ “ “
 Feet from North Line of Section
 “ “ East “ “ “
990990 “ “ South “ 1/4 “
33830 “ “ West “ 1/4 “

- LOCATION
 ⊕ RIG
 ⊕ DRILLING
 ☼ GAS WELL
 ● OIL WELL
 ⊕ SMALL OIL WELL

- LEGEND
 ⊕ DRY HOLE
 ⊕ DRY SHOWING OIL
 ⊕ DRY SHOWING GAS
 ⊕ ABANDONED LOCATION
 ☼ ABANDONED GAS WELL
 ⊕ ABANDONED OIL WELL

NOTE: Below make tracing from map, (when no map is obtainable make sketch) showing farm, center of section, this location with measurements and also wells, dry holes, or other locations in the vicinity of this location.

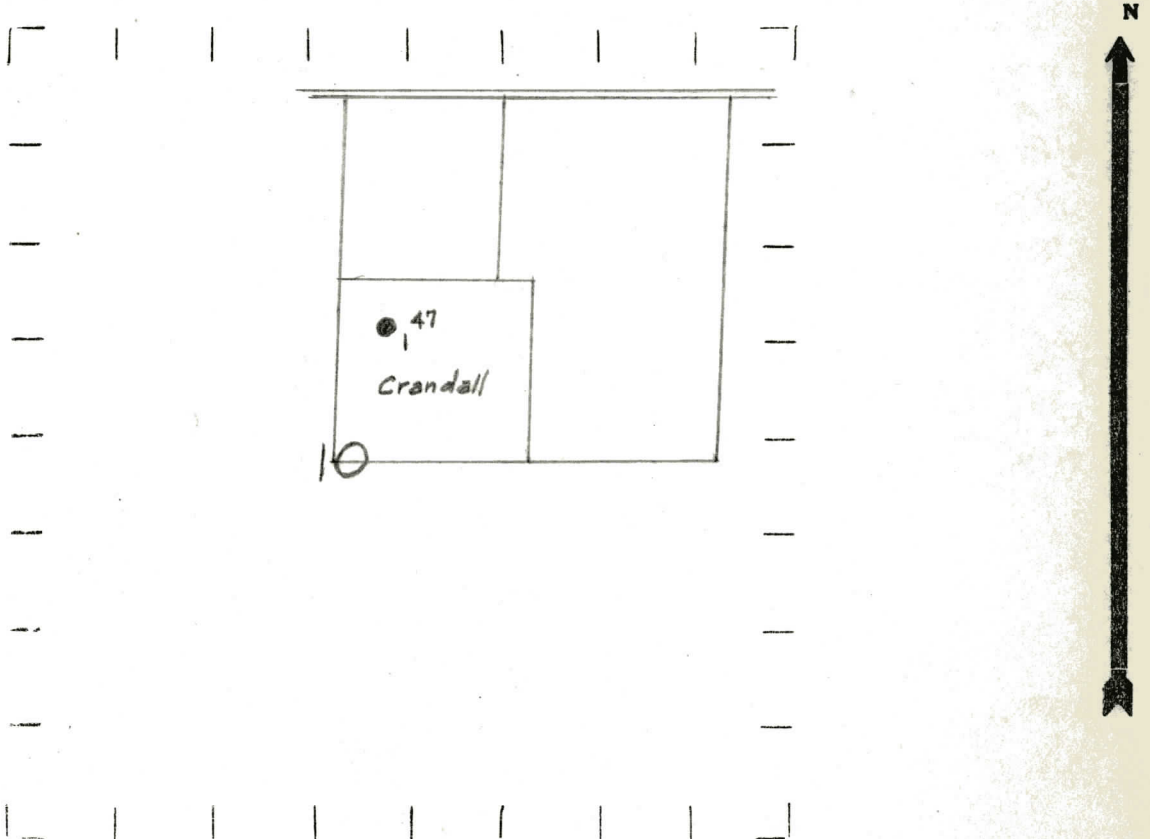

REMARKS:

SIGNED

R. L. Yeager

Superintendent or Foreman.

DATE November 27, 1936

LOCATION REPORT

No. 47

STATE Michigan COUNTY Arenac DIST. Clayton SEC 10 TOWNSHIP 20 N RANGE 4 E
WELL No. 1 (SERIAL No. 47) FARM S. S. Crandall ACRES

NAME OF STREAM OR WATERS QUADRANGLE NW-SW-NE

OPERATOR Charles E. Weller Map Clayton Township, Arenac County

330 330 Charles E. Weller. Clayton - Arenac Co.
Feet from North Line of Farm

" " East " " "

" " South " " "

330 330 " " West " " "

Feet from North Line of Section

" " East " " "

990 990 " " South " 1/4 "

330 330 " " West " 1/4 "

LEGEND

- LOCATION
- ⊙ RIG
- ⊕ DRILLING
- ☼ GAS WELL
- OIL WELL
- ⬮ SMALL OIL WELL
- ⊙ DRY HOLE
- ⬮ DRY SHOWING OIL
- ☼ DRY SHOWING GAS
- ⊙ ABANDONED LOCATION
- ☼ ABANDONED GAS WELL
- ⬮ ABANDONED OIL WELL

NOTE: Below make tracing from map, (when no map is obtainable make sketch) showing farm, center of section, this location with measurements and also wells, dry holes, or other locations in the vicinity of this location.

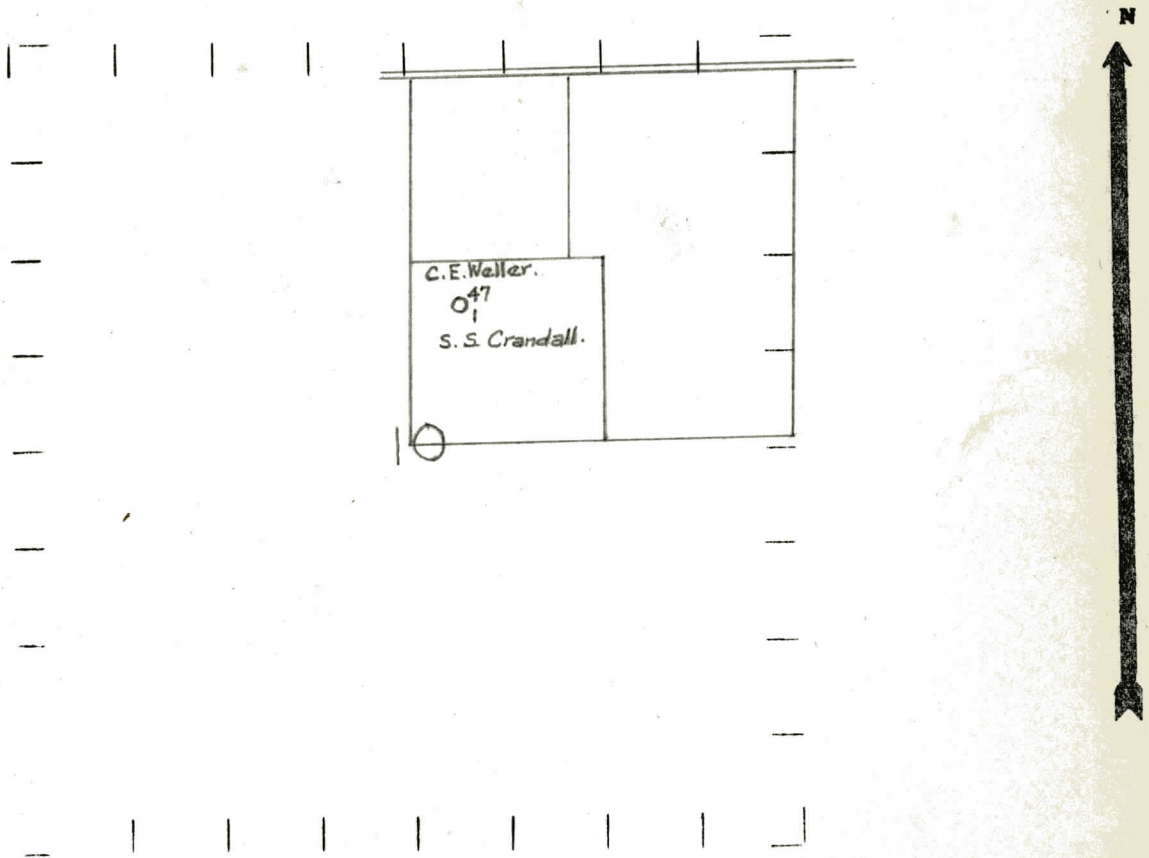

REMARKS:

SIGNED

A. L. Yeager
Superintendent or Foreman

Geo. H. Bell