



Western Michigan University
ScholarWorks at WMU

Legacy Scout Tickets from Pure Oil Company

8-20-2021

**MGRRE_PureOilScoutTickets_BUFFALO LAND
CO_3_21011037110000**

MGRRE
Western Michigan University

Follow this and additional works at: <https://scholarworks.wmich.edu/pure>



Part of the Geology Commons

WMU ScholarWorks Citation

MGRRE, "MGRRE_PureOilScoutTickets_BUFFALO LAND CO_3_21011037110000" (2021). *Legacy Scout Tickets from Pure Oil Company*. 49.
<https://scholarworks.wmich.edu/pure/49>

This Document is brought to you for free and open access via ScholarWorks at WMU. It has been accepted for inclusion in Legacy Scout Tickets from Pure Oil Company by an authorized administrator of ScholarWorks at WMU. See the National Digital Catalogue - Science Base Catalogue for more collections submitted by MGRRE.



MGRRE_PureOilScoutTickets_BUFFALO LAND CO_3_21011037110000

API 21011037110000

Permit Number 3711

Lease Name BUFFALO LAND CO

Well Number 3

County Arenac

Township 20N

Range 4E

Section 10

2021 DEQ or Pure co_name SUMMIT PETROLEUM CORP AND MUSKEGON DEVELOPMENT C

Pure Number 54

Latitude 44.1556316

Longitude -83.978641

THE PURE OIL COMPANY

DATE August 26, 1937

Corrected

LOCATION REPORT

No. 54STATE Michigan

COUNTY

Arenac

DIST.

Clayton

TWP.

Clayton

SEC.

10

TOWN

20 N

RANGE

4 EWELL No. 33 (SERIAL No. 54) FARMBuffalo Land Company

ACRES

NAME OF STREAM OR WATERS

QUADRANGLE

NE NE NWOPERATOR McClanahan Oil Company - Will C. Mee

Map

Clayton Township, Arenac County3330

Feet from North Line of Farm

10-8-513330

" " East " " "

" " South " " "

" " West " " "

330 330

Feet from North Line of Section

330 330" " East 1/4 "

" " South " " "

" " West " " "

LEGEND

O LOCATION

① RIG

⊕ DRILLING

☼ GAS WELL

● OIL WELL

⬤ SMALL OIL WELL

⊙ DRY HOLE

⬤ DRY SHOWING OIL

⊙ DRY SHOWING GAS

⊙ ABANDONED LOCATION

☼ ABANDONED GAS WELL

⬤ ABANDONED OIL WELL

NOTE: Below make tracing from map, (when no map is obtainable make sketch) showing farm, center of section, this location with measurements and also wells, dry holes, or other locations in the vicinity of this location.



REMARKS:

SIGNED

R. L. Yeager
Superintendent or Foreman

DATE December 3, 1936

LOCATION REPORT

No. 54

STATE Michigan COUNTY Arenac DIST. Clayton SEC. 10 TOWN 20 N RANGE 4 E
 WELL No. 33 (SERIAL No. 54) FARM Buffalo Land Company ACRES

NAME OF STREAM OR WATERS QUADRANGLE SE NE NW

OPERATOR McClanahan Oil Company Map Clayton Township, Arenac County
McClanahan Oil Co Clayton - Arenac.

Feet from North Line of Farm

330 330 " " East " " "

360 360 " " South " " "

" " West " " "

Feet from North Line of Section

330 330 " " East " 1/4 "

" " South " " "

" " West " " "

○ LOCATION

① RIG

⊕ DRILLING

☼ GAS WELL

● OIL WELL

◆ SMALL OIL WELL

LEGEND

⊙ DRY HOLE

◆ DRY SHOWING OIL

☼ DRY SHOWING GAS

⊙ ABANDONED LOCATION

☼ ABANDONED GAS WELL

◆ ABANDONED OIL WELL

NOTE: Below make tracing from map, (when no map is obtainable make sketch) showing farm, center of section, this location with measurements and also wells, dry holes, or other locations in the vicinity of this location.

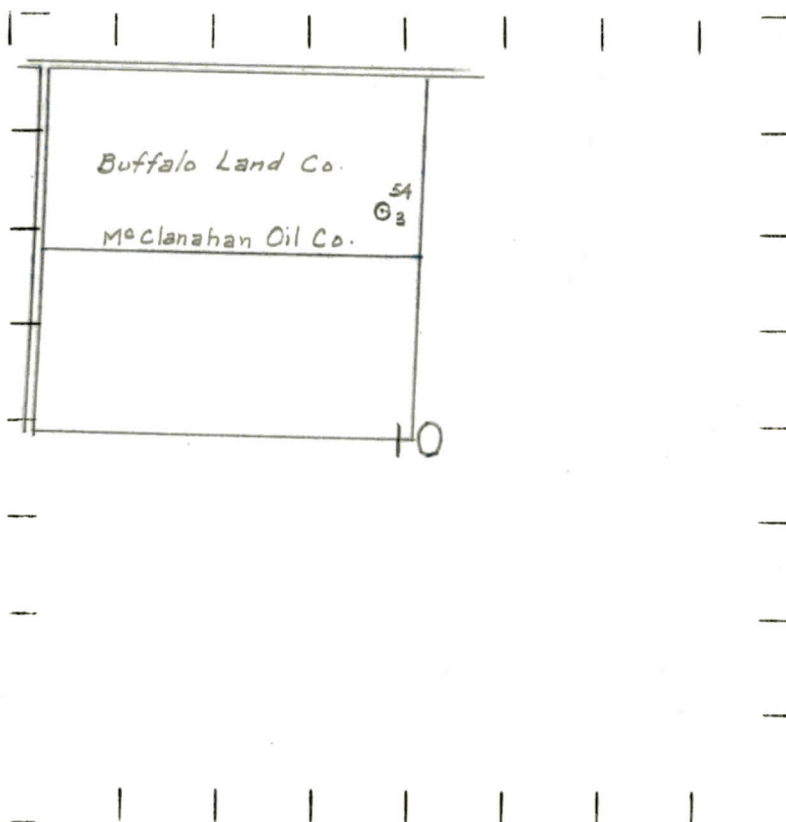

REMARKS:

SIGNED

Superintendent or Foreman.

Michigan Producing Division

Date **December 2, 1937**

No. 54

State **Michigan** County **Arenac** Dist. **Clayton** Twp. **10** Sec. **20 N** Rge. **4 E**

Well No. **3** (Serial No.) **54** Farm **Buffalo Land Company** Acres

Operator **McClanahan Oil Company** Information secured ^{by} ~~from~~ **Scouting Department**

Date well started 9-15-37 Date well completed 11-9-37 Elevation 810.6

PRODUCTION RECORD

1st 24 hours natural Filled up 300 ft.

2nd 24 hours natural

Date of shot	No. of quarts	From	to	From	to
1900					
1901					
1902					
1903					
1904					
1905					
1906					
1907					
1908					
1909					
1910					
1911					
1912					
1913					
1914					
1915					
1916					
1917					
1918					
1919					
1920					
1921					
1922					
1923					
1924					
1925					
1926					
1927					
1928					
1929					
1930					
1931					
1932					
1933					
1934					
1935					
1936					
1937					
1938					
1939					
1940					
1941					
1942					
1943					
1944					
1945					
1946					
1947					
1948					
1949					
1950					
1951					
1952					
1953					
1954					
1955					
1956					
1957					
1958					
1959					
1960					
1961					
1962					
1963					
1964					
1965					
1966					
1967					
1968					
1969					
1970					
1971					
1972					
1973					
1974					
1975					
1976					
1977					
1978					
1979					
1980					
1981					
1982					
1983					
1984					
1985					
1986					
1987					
1988					
1989					
1990					
1991					
1992					
1993					
1994					
1995					</

Date of acid **11-22-37** No. of gallons **1000**

1st 24 hours after acid 120 Barrels

shot

2nd 24 hours after acid

FORMATION AND CASING RECORD

Formation	Top	Bottom	Top Pay	Bottom Pay	Remarks	Casing	
						Size	Set At
Sunbury	1115					8-1/4"	1220
Berea	1126	1205	1235	1262	Show oil	6-5/8"	2135
Antrim	1295					5-3/16"	2424
Traverse	1660			1670	Salt water		
Dundee	2423			2428	Show oil		
				2530	Show oil and water		
			2537	2560	" "		
			2613	2622			
Total Depth		2622					

Remarks

Signed D. C. Shackelford