



Western Michigan University
ScholarWorks at WMU

Legacy Scout Tickets from Pure Oil Company

8-20-2021

MGRRE_PureOilScoutTickets_Hayward Brothers_1_21145125470000

MGRRE

Western Michigan University

Follow this and additional works at: <https://scholarworks.wmich.edu/pure>



Part of the Geology Commons

WMU ScholarWorks Citation

MGRRE, "MGRRE_PureOilScoutTickets_Hayward Brothers_1_21145125470000" (2021). *Legacy Scout Tickets from Pure Oil Company*. 9494.

<https://scholarworks.wmich.edu/pure/9494>

This Document is brought to you for free and open access via ScholarWorks at WMU. It has been accepted for inclusion in Legacy Scout Tickets from Pure Oil Company by an authorized administrator of ScholarWorks at WMU. See the National Digital Catalogue - Science Base Catalogue for more collections submitted by MGRRE.



MGRRE_PureOilScoutTickets_Hayward Brothers_1_21145125470000

API 21145125470000

Permit Number 12547

Lease Name Hayward Brothers

Well Number 1

County Saginaw

Township 11N

Range 03E

Section 35

2021 DEQ or Pure co_name McEvoy, Henry L.

Pure Number 386

Latitude 43.30858

Longitude -84.08319

THE PURE OIL COMPANY LOCATION REPORT

Date August 28, 1946 A.F.E. No. Hayward Brothers
 Division Mich. Producing District _____ Lease Hayward Brothers
 Acres _____ Lease No. 35 Elevation 111 Well No. 1 (Serial No. 386)
 Quadrangle SE SE SW Sec. 35 Twp. 11 N Rge. 3 E 386 Dist. James
 Survey _____ County Saginaw State Michigan
 Operator Henry L. McEvoy Map James Township, Saginaw County

Feet from North Line of Lease			
<u>330</u>	<u>330</u>	" "	East " "
<u>330</u>	<u>330</u>	" "	South " "
		" "	West " "
Feet from North Line of Section			
<u>330</u>	<u>330</u>	" "	East <u>1/4</u> "
<u>330</u>	<u>330</u>	" "	South " "
		" "	West " "

LEGEND

○ Location

- ☀ Gas Well
- Oil Well
- ☀ Gas - Distillate Well
- ∅ or ○ Dry Hole
- Dry Showing Oil
- ☀ Dry Showing Gas
- ⊗ Abandoned Location
- ☀ or ⊗ Abandoned Gas Well
- or ● Abandoned Oil Well
- or ○ Input Well

Low.

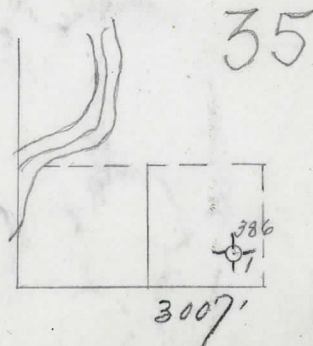
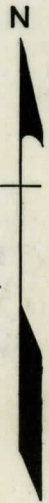

Remarks: _____ Scale _____

Submitted by CB Civil Engineer Approved by _____ Division Manager
 Approved by _____ Vice-President - General Manager