



Western Michigan University  
ScholarWorks at WMU

---

Legacy Scout Tickets from Pure Oil Company

---

8-20-2021

## MGRRE\_PureOilScoutTickets\_Merrill Palmer School of Motherhood (Whittier)\_5\_21145006149000

MGRRE

*Western Michigan University*

Follow this and additional works at: <https://scholarworks.wmich.edu/pure>



Part of the Geology Commons

---

### WMU ScholarWorks Citation

MGRRE, "MGRRE\_PureOilScoutTickets\_Merrill Palmer School of Motherhood (Whittier)\_5\_21145006149000" (2021). *Legacy Scout Tickets from Pure Oil Company*. 9502. <https://scholarworks.wmich.edu/pure/9502>

This Document is brought to you for free and open access via ScholarWorks at WMU. It has been accepted for inclusion in Legacy Scout Tickets from Pure Oil Company by an authorized administrator of ScholarWorks at WMU. See the National Digital Catalogue - Science Base Catalogue for more collections submitted by MGRRE.



---

**MGRRE\_PureOilScoutTickets\_Merrill Palmer School of Motherhood  
(Whittier)\_5\_21145006149000**

API 21145006149000

Permit Number None

Lease Name Merrill Palmer School of Motherhood (Whittier)

Well Number 5

County Saginaw

Township 12N

Range 04E

Section 13

2021 DEQ or Pure co\_name Wells-Schmidt Oil Company

Pure Number N06

Latitude 43.43643

Longitude -83.95557

THE PURE OIL COMPANY  
LOCATION REPORT

No.

DATE \_\_\_\_\_  
 STATE \_\_\_\_\_ COUNTY \_\_\_\_\_ DIST. *Sag* TWP. *City of Sag* SEC. \_\_\_\_\_ TOWN \_\_\_\_\_ RANGE \_\_\_\_\_  
 WELL No. *5* (SERIAL No. *200*) FARM *N6* PREC. *Whittier* *Whittier* ACRES \_\_\_\_\_  
 NAME OF STREAM OR WATERS \_\_\_\_\_ QUADRANGLE \_\_\_\_\_  
 OPERATOR *Wells-Schmidt* MAP \_\_\_\_\_  
*780* Feet from North Line of Farm *Corporation*

\_\_\_\_\_ " " East " " "  
 \_\_\_\_\_ " " South " " "  
*200* " " West " " " *Sag River*  
 \_\_\_\_\_ Feet from North Line of Section  
 \_\_\_\_\_ " " East " " "  
 \_\_\_\_\_ " " South " " "  
 \_\_\_\_\_ " " West " " "

**LEGEND**

- LOCATION
- ⊕ DRY HOLE
- ① RIG
- ⊖ DRY SHOWING OIL
- ⊕ DRILLING
- ⊙ DRY SHOWING GAS
- ⊗ GAS WELL
- ⊖ ABANDONED LOCATION
- OIL WELL
- ⊗ ABANDONED GAS WELL
- ⊖ SMALL OIL WELL
- ⊖ ABANDONED OIL WELL

NOTE: Below make tracing from map, (when no map is obtainable make sketch) showing farm, center of section, this location with measurements and also wells, dry holes, or other locations in the vicinity of this location. Make copy to keep for reference and send original to Chicago office.

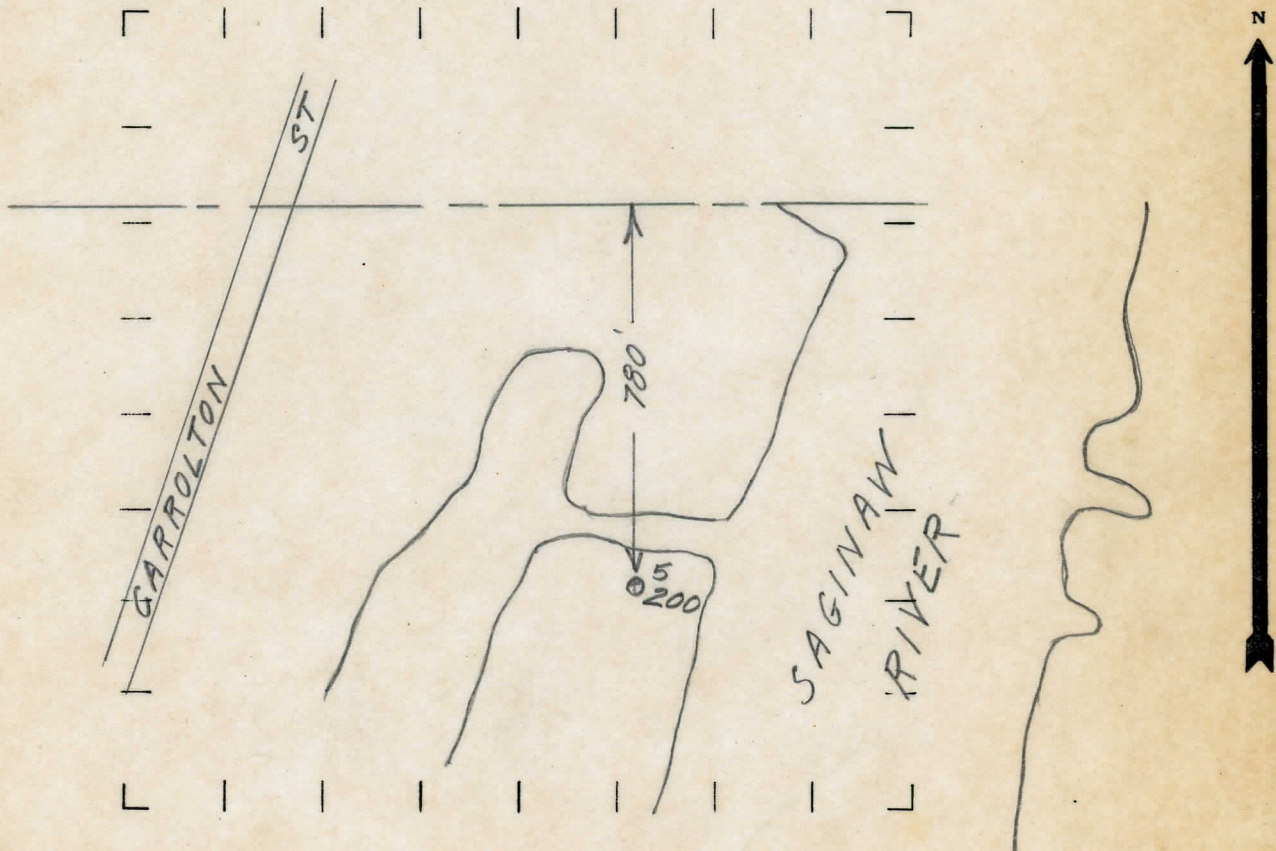

REMARKS:

\_\_\_\_\_  
 \_\_\_\_\_  
 \_\_\_\_\_

SIGNED

Superintendent or Foreman.