



Western Michigan University  
ScholarWorks at WMU

---

Legacy Scout Tickets from Pure Oil Company

---

8-20-2021

**MGRRE\_PureOilScoutTickets\_MUTCH, J.\_1\_21011035270000**

MGRRE

*Western Michigan University*

Follow this and additional works at: <https://scholarworks.wmich.edu/pure>



Part of the Geology Commons

---

#### **WMU ScholarWorks Citation**

MGRRE, "MGRRE\_PureOilScoutTickets\_MUTCH, J.\_1\_21011035270000" (2021). *Legacy Scout Tickets from Pure Oil Company*. 52.

<https://scholarworks.wmich.edu/pure/52>

This Document is brought to you for free and open access via ScholarWorks at WMU. It has been accepted for inclusion in Legacy Scout Tickets from Pure Oil Company by an authorized administrator of ScholarWorks at WMU. See the National Digital Catalogue - Science Base Catalogue for more collections submitted by MGRRE.



---

**MGRRE\_PureOilScoutTickets\_MUTCH, J.\_1\_21011035270000**

API 21011035270000

Permit Number 3527

Lease Name MUTCH, J.

Well Number 1

County Arenac

Township 20N

Range 4E

Section 11

2021 DEQ or Pure co\_name GORDON OIL CO

Pure Number 57

Latitude 44.1518

Longitude -83.96112

THE PURE OIL COMPANY

DATE December 3, 1936

LOCATION REPORT

No. 57

STATE Michigan COUNTY Arenac DIST. Clayton TWP. Clayton SEC. 11 TOWN 20 N RANGE 4 E

WELL No. 1 (SERIAL No. 57) FARM J. Mutch ACRES

NAME OF STREAM OR WATERS QUADRANGLE NW SE NW

OPERATOR Gordon Oil Company Map Clayton Township, Arenac County

330 330 Feet from North Line of Farm

" " East " " "

" " South " " "

330 330 " " West " " "

Feet from North Line of Section

990 990 " " East " 1/4 "

990 990 " " South " 1/4 "

" " West " " "

LEGEND

- LOCATION
- ⊙ RIG
- ⊕ DRILLING
- ☀ GAS WELL
- OIL WELL
- ⬮ SMALL OIL WELL
- ⊖ DRY HOLE
- ◆ DRY SHOWING OIL
- ⊖ DRY SHOWING GAS
- ⊖ ABANDONED LOCATION
- ☀ ABANDONED GAS WELL
- ⬮ ABANDONED OIL WELL

NOTE: Below make tracing from map, (when no map is obtainable make sketch) showing farm, center of section, this location with measurements and also wells, dry holes, or other locations in the vicinity of this location.

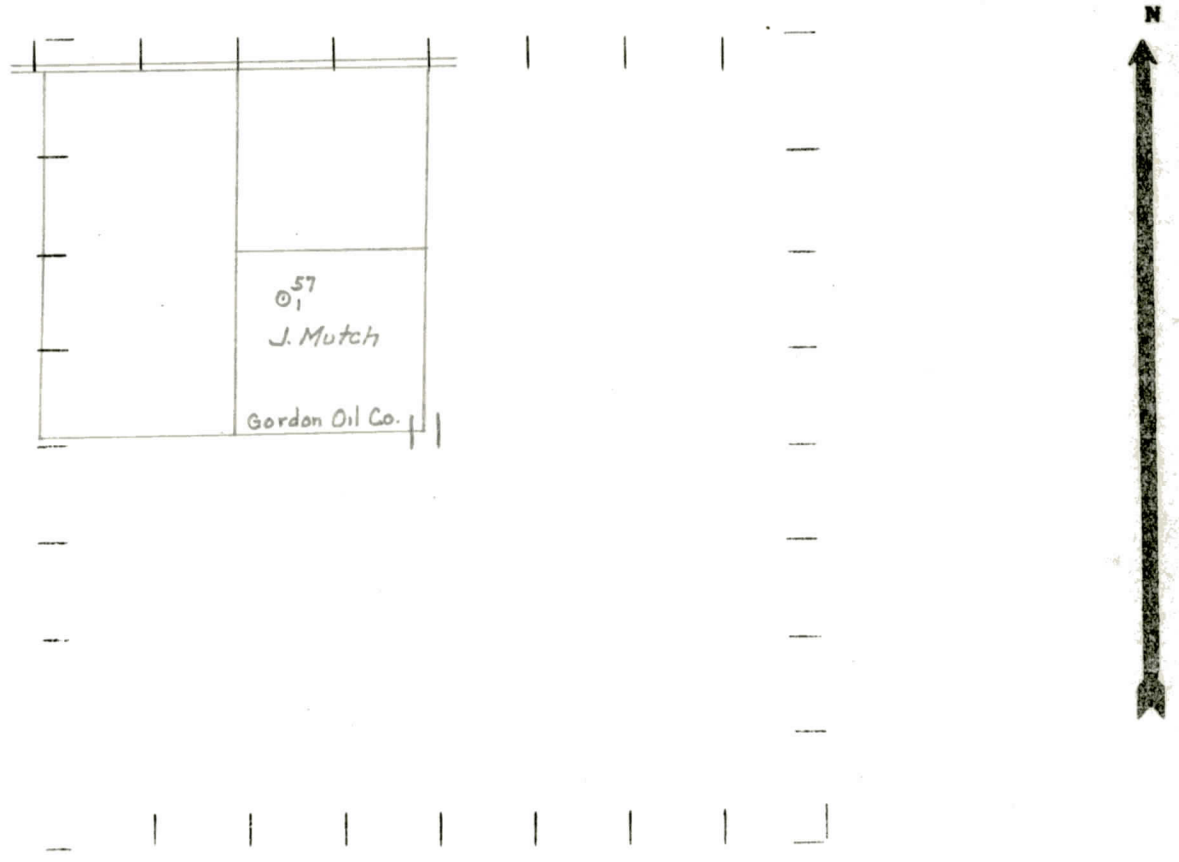

REMARKS:

SIGNED

Superintendent or Foreman.

Michigan Producing Division

Date February 4, 1937 No. 57  
 State Michigan County Arenac Dist. Clayton  
 (Serial No.) Twp. Clayton Sec. 11 Twp. 20 N Rge. 4 E  
 Well No. 1 (County No.) 57 Farm J. Mutch Acres \_\_\_\_\_  
 Operator Gordon Oil Company Information secured ~~from~~ <sup>by</sup> Scouting Department  
 Date well started 12-4-36 Date well completed 1-31-37 Elevation 815.9

PRODUCTION RECORD

1st 24 hours natural Dry Hole  
 2nd 24 hours natural \_\_\_\_\_  
 Date of shot \_\_\_\_\_ No. of quarts \_\_\_\_\_ From \_\_\_\_\_ to \_\_\_\_\_ From \_\_\_\_\_ to \_\_\_\_\_  
 Date of acid \_\_\_\_\_ No. of gallons \_\_\_\_\_  
 1st 24 hours after acid \_\_\_\_\_ shot  
 2nd 24 hours after acid \_\_\_\_\_ shot

FORMATION AND CASING RECORD

Formation	Top	Bottom	Top Pay	Bottom Pay	Remarks	Casing	
						Size	Set At
Sunbury	1175	1189				10"	275
Berea	1189	1275				8 1/2"	1302
Antrim	1330	1720				5-3/16"	2495
Traverse	1720						
Dundee	2496						
Total Depth		2707					

Remarks Show gas 575 - show oil 991 - salt water 1224 - 2 bailers per hour-show gas 1720-  
salt water 1720-1725-black water 2696.

Signed G. H. Bell