



Western Michigan University
ScholarWorks at WMU

Legacy Scout Tickets from Pure Oil Company

8-20-2021

MGRRE_PureOilScoutTickets_Brown aka Eddy Estate (Savignaw Prospecting No. #47)_47_21145004739000

MGRRE

Western Michigan University

Follow this and additional works at: <https://scholarworks.wmich.edu/pure>



Part of the Geology Commons

WMU ScholarWorks Citation

MGRRE, "MGRRE_PureOilScoutTickets_Brown aka Eddy Estate (Savignaw Prospecting No. #47)_47_21145004739000" (2021). *Legacy Scout Tickets from Pure Oil Company*. 9529. <https://scholarworks.wmich.edu/pure/9529>

This Document is brought to you for free and open access via ScholarWorks at WMU. It has been accepted for inclusion in Legacy Scout Tickets from Pure Oil Company by an authorized administrator of ScholarWorks at WMU. See the National Digital Catalogue - Science Base Catalogue for more collections submitted by MGRRE.



MGRRE_PureOilScoutTickets_Brown aka Eddy Estate (Savignaw Prospecting No. #47)_47_21145004739000

API 21145004739000

Permit Number None

Lease Name Brown aka Eddy Estate (Savignaw Prospecting No. #47)

Well Number 47

County Saginaw

Township 12N

Range 04E

Section 13

2021 DEQ or Pure co_name Smith and Martin

Pure Number N33

Latitude 43.43643

Longitude -83.95557

THE PURE OIL COMPANY
LOCATION REPORT

No. _____

DATE _____

STATE SP 47 COUNTY Sag DIST. City of Sag TWP. _____ SEC. _____ TOWN _____ RANGE _____

WELL No. _____ (SERIAL No. N33) FARM _____ ACRES _____

NAME OF STREAM OR WATERS _____ QUADRANGLE _____

OPERATOR Sag. Pros Co. MAP _____

Feet from North Line of Farm
 " " East " " " Davenport Av.
50 " " South " " "
 " " West " " "

Feet from North Line of Section
 " " East " " "
 " " South " " "
 " " West " " "

LEGEND

- LOCATION
- ① RIG
- ⊕ DRILLING
- ☼ GAS WELL
- OIL WELL
- ⊙ SMALL OIL WELL
- ⊕ DRY HOLE
- ◆ DRY SHOWING OIL
- ☼ DRY SHOWING GAS
- ⊙ ABANDONED LOCATION
- ☼ ABANDONED GAS WELL
- ⊙ ABANDONED OIL WELL

NOTE: Below make tracing from map, (when no map is obtainable make sketch) showing farm, center of section, this location with measurements and also wells, dry holes, or other locations in the vicinity of this location. Make copy to keep for reference and send original to Chicago office.

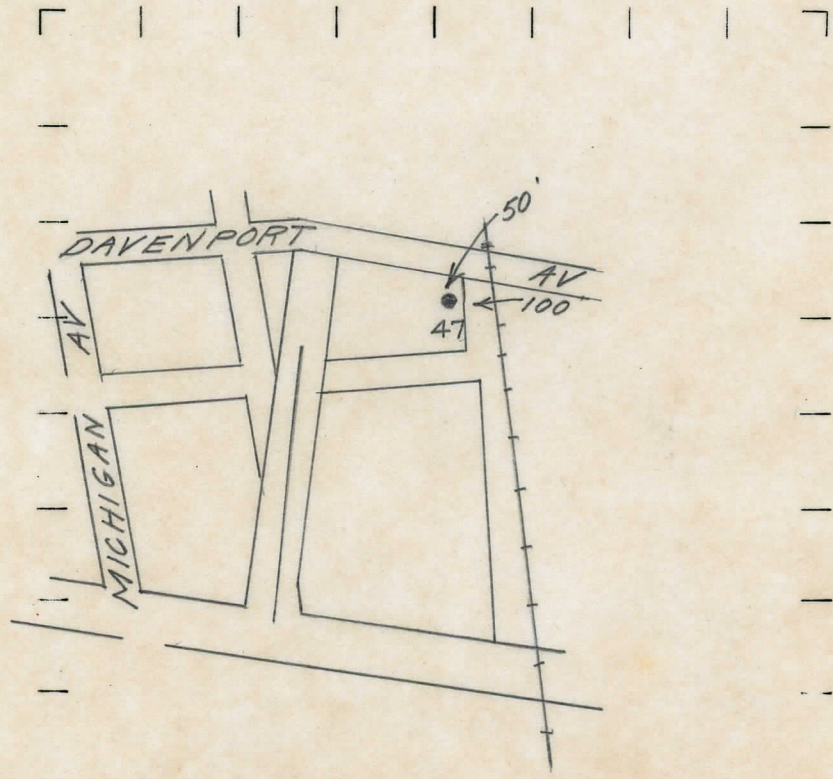

REMARKS: Berea 25 bbls
1801-1820

SIGNED _____

Superintendent or Foreman.