



Western Michigan University  
ScholarWorks at WMU

---

Legacy Scout Tickets from Pure Oil Company

---

8-20-2021

**MGRRE\_PureOilScoutTickets\_CRANDALL,  
WESLEY\_2\_21011038860000**

MGRRE  
*Western Michigan University*

Follow this and additional works at: <https://scholarworks.wmich.edu/pure>



Part of the Geology Commons

---

#### WMU ScholarWorks Citation

MGRRE, "MGRRE\_PureOilScoutTickets\_CRANDALL, WESLEY\_2\_21011038860000" (2021). *Legacy Scout Tickets from Pure Oil Company*. 69.

<https://scholarworks.wmich.edu/pure/69>

This Document is brought to you for free and open access via ScholarWorks at WMU. It has been accepted for inclusion in Legacy Scout Tickets from Pure Oil Company by an authorized administrator of ScholarWorks at WMU. See the National Digital Catalogue - Science Base Catalogue for more collections submitted by MGRRE.



---

MGRRE\_PureOilScoutTickets\_CRANDALL, WESLEY\_2\_21011038860000

API 21011038860000

Permit Number 3886

Lease Name CRANDALL, WESLEY

Well Number 2

County Arenac

Township 20N

Range 4E

Section 10

2021 DEQ or Pure co\_name SUMMIT PETROLEUM CORP

Pure Number 74

Latitude 44.1463423

Longitude -83.9707449

## THE PURE OIL COMPANY

## LOCATION REPORT

Date Dec. 21, 1946 Corrected

A.F.E. No. \_\_\_\_\_

Division Mich. Producing District \_\_\_\_\_Lease W. GrandallAcres \_\_\_\_\_ Lease No. \_\_\_\_\_ Elevation \_\_\_\_\_ Well No. 2 (Serial No. 74)Quadrangle SW NE SE Sec. 10 Twp. 20 N Rge. 4 E ~~SW NE SE~~ ~~SW NE SE~~ ClaytonSurvey \_\_\_\_\_ County Arenac State MichiganOperator Turner Petroleum Corp. Map Clayton Township, Arenac County

\_\_\_\_ Feet from North Line of Lease

\_\_\_\_ " " East " " "

\_\_\_\_ " " South " " "

\_\_\_\_ " " West " " "

\_\_\_\_ Feet from North Line of Section



\_\_\_\_ " " East " " "

\_\_\_\_ " " South " " "

\_\_\_\_ " " West " " "

## LEGEND

○ Location

 Gas Well Oil Well Gas - Distillate Well or  Dry Hole Dry Showing Oil Dry Showing Gas Abandoned Location or  Abandoned Gas Well or  Abandoned Oil Well or  Input Well

See plat - Arenac #74.

Remarks: Change of operator.

Scale \_\_\_\_\_

Submitted by Scouting Dept.

Approved by \_\_\_\_\_

Division Manager

Approved by \_\_\_\_\_

Vice-President - General Manager

DATE March 4, 1937 Corrected LOCATION REPORT No. 74  
STATE Michigan COUNTY Arenac DIST. Clayton SEC. 10 TOWN 20 N RANGE 4 E  
WELL No. 22 (SERIAL No. 74) FARM W. Crandell ACRES  
NAME OF STREAM OR WATERS QUADRANGLE SW NE SE

OPERATOR Gordon Oil Company Map Clayton Township, Arenac County  
Gordon Oil Co. Clayton - Arenac.

		Feet from North Line of Farm
	" "	East " " "
330	330	" " South " " "
330	330	" " West " " "
990	990	Feet from North Line of Section 1/4
990	990	" " East " " "
	" "	South " " "
	" "	West " " "

- LEGEND
- LOCATION
  - ① RIG
  - ⊕ DRILLING
  - ☼ GAS WELL
  - OIL WELL
  - ⬮ SMALL OIL WELL
  - ⊙ DRY HOLE
  - ◆ DRY SHOWING OIL
  - ⊙ DRY SHOWING GAS
  - ⊙ ABANDONED LOCATION
  - ☼ ABANDONED GAS WELL
  - ⬮ ABANDONED OIL WELL

NOTE: Below make tracing from map, (when no map is obtainable make sketch) showing farm, center of section, this location with measurements and also wells, dry holes, or other locations in the vicinity of this location.

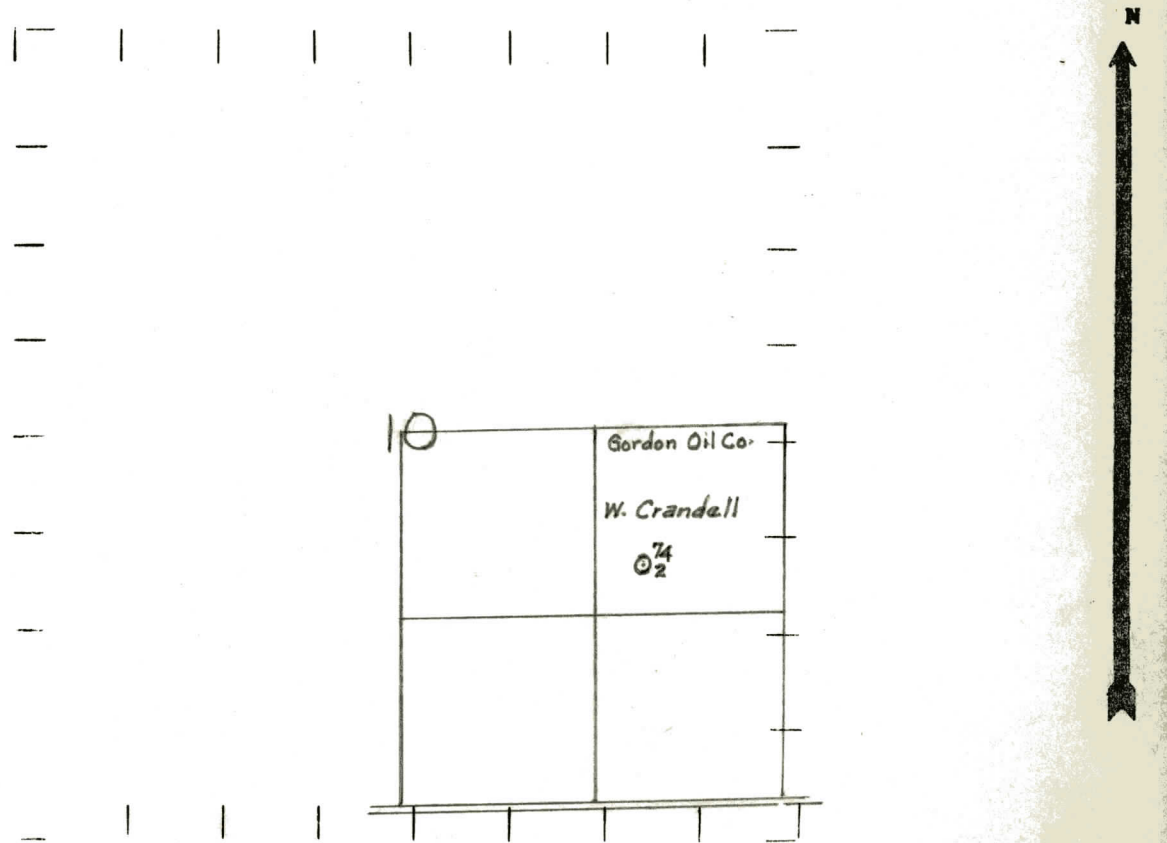

REMARKS:

SIGNED  
Superintendent or Foreman.



DATE February 18, 1937

Collected

LOCATION REPORT

No. 74

STATE Michigan

COUNTY

Arenac

DIST.

Clayton

SEC.

10

TOWN

20 N

RANGE

4 E

WELL No. 22

(SERIAL No. 74)

FARM

ACRES

NAME OF STREAM OR WATERS

QUADRANGLE

NW-NE-SE  
NW NE SE

OPERATOR

Gordon Oil Company

Map

Clayton Township, Arenac County

330 330

Gordon Oil Co.

Feet from North Line of Farm

" " East " " "

" " South " " "

330 330

" " West " " "

330 330

Feet from North Line of Section

990 990

" " East " " "

" " South " " "

" " West " " "

O LOCATION

① RIG

⊕ DRILLING

☀ GAS WELL

● OIL WELL

◆ SMALL OIL WELL

## LEGEND

⊙ DRY HOLE

◆ DRY SHOWING OIL

⊙ DRY SHOWING GAS

⊙ ABANDONED LOCATION

☀ ABANDONED GAS WELL

◆ ABANDONED OIL WELL

NOTE: Below make tracing from map, (when no map is obtainable make sketch) showing farm, center of section, this location with measurements and also wells, dry holes, or other locations in the vicinity of this location.

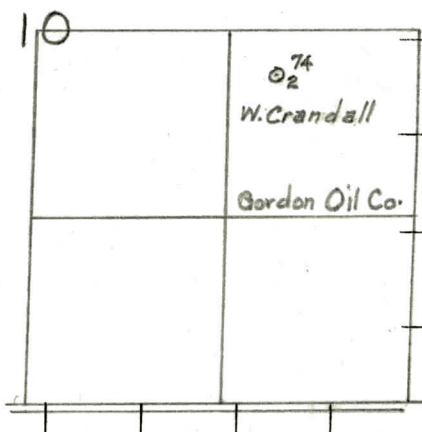

REMARKS:

SIGNED

R. L. Yenga.  
Superintendent or Foreman.



No. 74

Dist.

Sec. 10

Twp. 20 N Rge. 4 E

(Serial No.)

Farm W. Crandall

Acres

Information secured <sup>by</sup> ~~from~~ Scouting Department

Date well completed.....4-18-37

Elevation 814.5

1st 24 hours natural 57 Barrels

2nd 24 hours natural

Date of shot	No. of quarts	From	to	From	to
--------------	------------------	------	----	------	----

Date of acid 5-3-37 No. of gallons 1000

1st 24 hours after acid 250 Barrels

2nd 24 hours after acid

Formation	Top	Bottom	Top Pay	Bottom Pay	Remarks	Casing	
						Size	Set
Sunbury	1090	1125		939	Show oil	10"	243
Berea	1125			1143	Show gas	8 1/2"	1245
Antrim	1280	1680				6-5/8"	2072
Traverse	1680	S.L.M.				5-3/16"	2438
Dundee	2437	S.L.M.		2476	Show oil		
			2565	2567			
			2586	2595			
Total Depth		2610					

Remarks Show gas 1143 - gas pay 1165-1169 - gas pay 1173-1175 - gas pay 1180-1186-gauged  
15,276,000 cubic feet at 1186.

Signed

Dean C. Shackelford