



Western Michigan University
ScholarWorks at WMU

Legacy Scout Tickets from Pure Oil Company

8-20-2021

**MGRRE_PureOilScoutTickets_BERGERON,
ERENEST_1_21011040950000**

MGRRE
Western Michigan University

Follow this and additional works at: <https://scholarworks.wmich.edu/pure>



Part of the Geology Commons

WMU ScholarWorks Citation

MGRRE, "MGRRE_PureOilScoutTickets_BERGERON, ERENEST_1_21011040950000" (2021). *Legacy Scout Tickets from Pure Oil Company*. 80.

<https://scholarworks.wmich.edu/pure/80>

This Document is brought to you for free and open access via ScholarWorks at WMU. It has been accepted for inclusion in Legacy Scout Tickets from Pure Oil Company by an authorized administrator of ScholarWorks at WMU. See the National Digital Catalogue - Science Base Catalogue for more collections submitted by MGRRE.



MGRRE_PureOilScoutTickets_BERGERON, ERENEST_1_21011040950000

API 21011040950000

Permit Number 4095

Lease Name BERGERON, ERENEST

Well Number 1

County Arenac

Township 20N

Range 4E

Section 15

2021 DEQ or Pure co_name SOVEREIGN W J

Pure Number 85

Latitude 44.13731

Longitude -83.97318

Form 24-1-1 WELL REPORT - OUTSIDE OPERATIONS

SERIAL NO. 85

STATE Michigan PSK Arenac
 CO.
 OPERATOR W. J. Sovereign
 FARM Bergeron WELL NO. 1
 TWP. Clayton S. 15 T. 20N R. 4E
~~SURVEY~~
 LOC. NE SW NE

WILDCAT ☐ FIELD ☐ FIELD NAME _____
 MAP NO. _____ CO-ORD. _____ ELEV. _____
 STATUS Total Depth 1262'.
Plugged and Abandoned 12-8-48.

NORTH

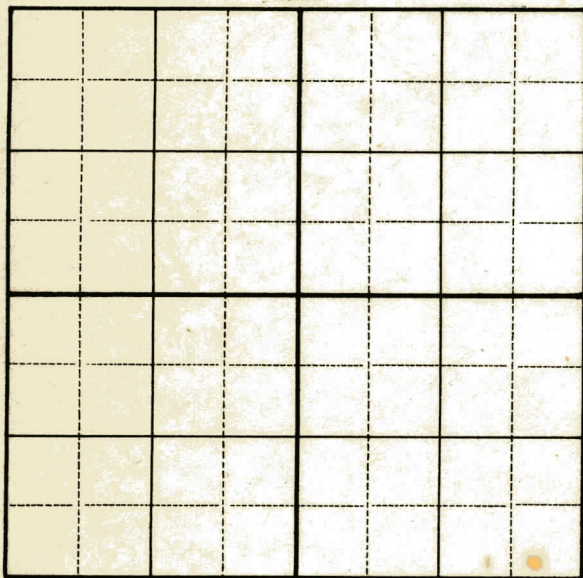

DATE 2-1-49 SCOUT H. J. G.

DVALE HOA 34 1938

Collection

LOCATION REPORT

No. 85

DATE May 6, 1937

LOCATION REPORT

No. 85

STATE Michigan

COUNTY

Arenac

DIST.

Clayton

SEC. 15

TOWN

20 N

20 N

RANGE

4 E

WELL No. 1

(SERIAL No. 85) FARM

PREC.

Ernest Bergeron

ACRES

NAME OF STREAM OR WATERS

QUADRANGLE NE-SW-NE

OPERATOR Hal-Be-Oyle & Gas Corporation

Map

Clayton Township, Arenac County

330 330

Hal-Be-Oyle & Gas Corp.

Clayton - Arenac.

Feet from North Line of Farm

330 330

" " East " " "

" " South " " "

" " West " " "

Feet from North Line of Section

" " East " " "

990 990

" " South " 1 1/4 "

990 990

" " West " 1 1/4 "

O LOCATION

① RIG

⊕ DRILLING

☼ GAS WELL

● OIL WELL

⦿ SMALL OIL WELL

LEGEND

⦿ DRY HOLE

⦿ DRY SHOWING OIL

⦿ DRY SHOWING GAS

⦿ ABANDONED LOCATION

⦿ ABANDONED GAS WELL

⦿ ABANDONED OIL WELL

NOTE: Below make tracing from map, (when no map is obtainable make sketch) showing farm, center of section, this location with measurements and also wells, dry holes, or other locations in the vicinity of this location.

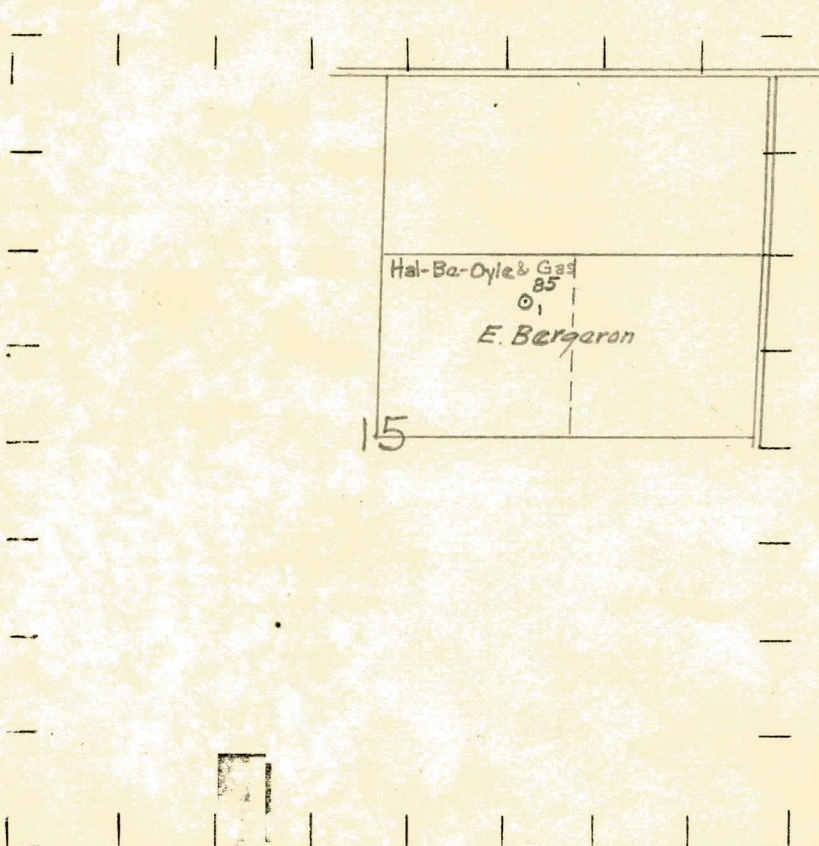

REMARKS:

SIGNED

Superintendent or Foreman.

Signed Dean C. Shackelford