



Western Michigan University  
ScholarWorks at WMU

---

Legacy Scout Tickets from Pure Oil Company

---

8-20-2021

MGRRE\_PureOilScoutTickets\_DECKER, F. ET  
AL\_1\_21011043100000

MGRRE  
*Western Michigan University*

Follow this and additional works at: <https://scholarworks.wmich.edu/pure>



Part of the Geology Commons

---

#### WMU ScholarWorks Citation

MGRRE, "MGRRE\_PureOilScoutTickets\_DECKER, F. ET AL\_1\_21011043100000" (2021). *Legacy Scout Tickets from Pure Oil Company*. 92.  
<https://scholarworks.wmich.edu/pure/92>

This Document is brought to you for free and open access via ScholarWorks at WMU. It has been accepted for inclusion in Legacy Scout Tickets from Pure Oil Company by an authorized administrator of ScholarWorks at WMU. See the National Digital Catalogue - Science Base Catalogue for more collections submitted by MGRRE.



---

MGRRE\_PureOilScoutTickets\_DECKER, F. ET AL\_1\_21011043100000

API 21011043100000

Permit Number 4310

Lease Name DECKER, F. ET AL

Well Number 1

County Arenac

Township 20N

Range 4E

Section 11

2021 DEQ or Pure co\_name FLETCHER AND LEMAN

Pure Number 97

Latitude 44.14547

Longitude -83.96207

## THE PURE OIL COMPANY

COMPLETION RECORD OF WELLS DRILLED BY OTHER OPERATORS  
LOCATION REPORTDATE July 15, 1937No. 97

STATE Michigan COUNTY Arenac DIST. Clayton SEC. 11 TOWN 20 N RANGE 4 E  
 WELL No. 1 (SERIAL No. 97) FARM \_\_\_\_\_ ACRES \_\_\_\_\_  
 PREC. F. Decker, et al.

NAME OF STREAM OR WATERS \_\_\_\_\_ QUADRANGLE C-SW

OPERATOR Fletcher & Leman Map Clayton Township, Arenac County  
Fletcher-Leman Clayton-Arenac

Feet from North Line of Farm

" " East " " "

1320 1320 " " South " " "

1320 1320 " " West " " "

Feet from North Line of Section

" " East " " "

1320 1320 " " South " " "

1320 1320 " " West " " "

## LEGEND

○ LOCATION

⊙ RIG

⊕ DRILLING

☼ GAS WELL

● OIL WELL

⦿ SMALL OIL WELL

⊖ DRY HOLE

⦿ DRY SHOWING OIL

⊖ DRY SHOWING GAS

⦿ ABANDONED LOCATION

☼ ABANDONED GAS WELL

⦿ ABANDONED OIL WELL

NOTE: Below make tracing from map, (when no map is obtainable make sketch) showing farm, center of section, this location with measurements and also wells, dry holes, or other locations in the vicinity of this location.

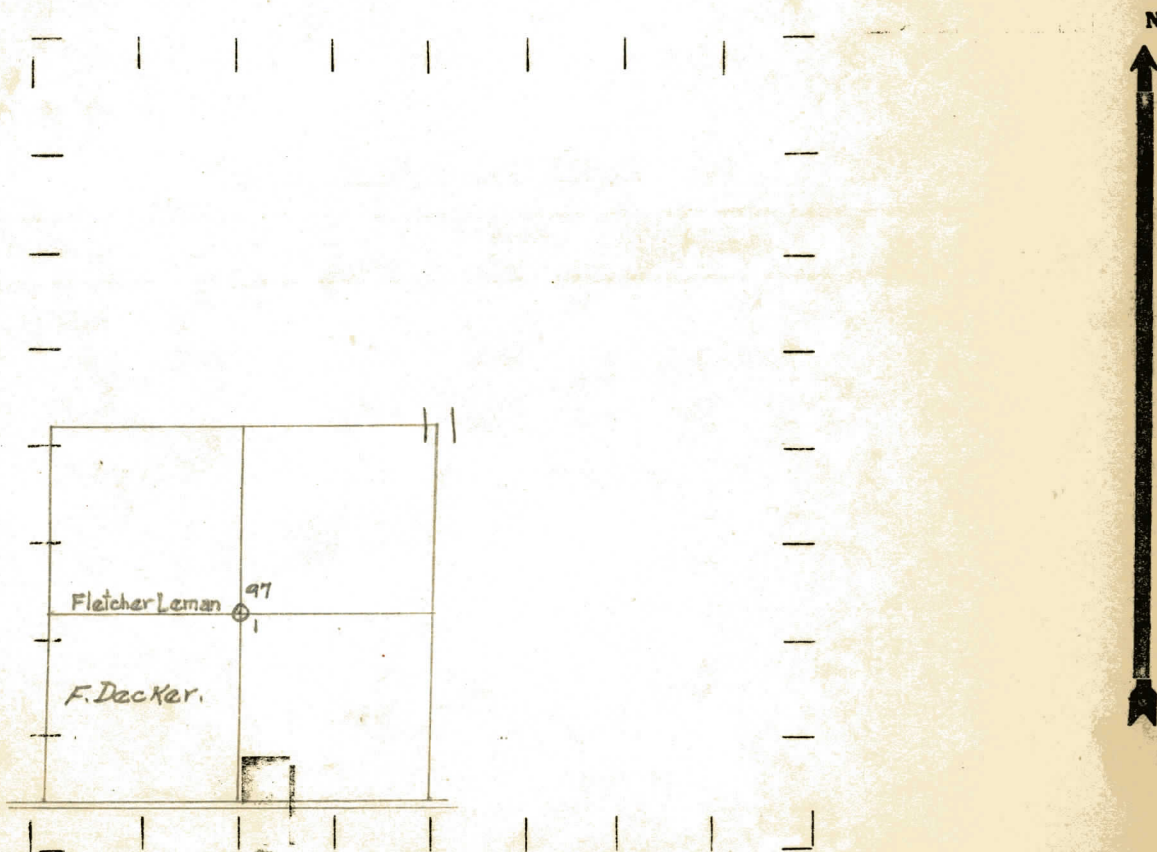

REMARKS:

SIGNED \_\_\_\_\_

Superintendent or Foreman.



## ГОСУДИОН ВЕЬОН

Date well started 7-23-57 Date well completed 8-5-57 Elevation 811.1

## PRODUCTION RECORD

2nd 24 hours natural

[illegible]

1st 24 hours after acid

2nd 24 hours after acid

# FORMATION AND CASING RECORD

[illegible]

Date	Locality	Collector	No.	Remarks
1900	...	...	...	...
1901	...	...	...	...
1902	...	...	...	...
1903	...	...	...	...
1904	...	...	...	...
1905	...	...	...	...
1906	...	...	...	...
1907	...	...	...	...
1908	...	...	...	...
1909	...	...	...	...
1910	...	...	...	...
1911	...	...	...	...
1912	...	...	...	...
1913	...	...	...	...
1914	...	...	...	...
1915	...	...	...	...
1916	...	...	...	...
1917	...	...	...	...
1918	...	...	...	...
1919	...	...	...	...
1920	...	...	...	...
1921	...	...	...	...
1922	...	...	...	...
1923	...	...	...	...
1924	...	...	...	...
1925	...	...	...	...
1926	...	...	...	...
1927	...	...	...	...
1928	...	...	...	...
1929	...	...	...	...
1930	...	...	...	...
1931	...	...	...	...
1932	...	...	...	...
1933	...	...	...	...
1934	...	...	...	...
1935	...	...	...	...
1936	...	...	...	...
1937	...	...	...	...
1938	...	...	...	...
1939	...	...	...	...
1940	...	...	...	...
1941	...	...	...	...
1942	...	...	...	...
1943	...	...	...	...
1944	...	...	...	...
1945	...	...	...	...
1946	...	...	...	...
1947	...	...	...	...
1948	...	...	...	...
1949	...	...	...	...
1950	...	...	...	...
1951	...	...	...	...
1952	...	...	...	...
1953	...	...	...	...
1954	...	...	...	...
1955	...	...	...	...
1956	...	...	...	...
1957	...	...	...	...
1958	...	...	...	...
1959	...	...	...	...
1960	...	...	...	...
1961	...	...	...	...
1962	...	...	...	...
1963	...	...	...	...
1964	...	...	...	...
1965	...	...	...	...
1966	...	...	...	...
1967	...	...	...	...
1968	...	...	...	...
1969	...	...	...	...
1970	...	...	...	...
1971	...	...	...	...
1972	...	...	...	...
1973	...	...	...	...
1974	...	...	...	...
1975	...	...	...	...
1976	...	...	...	...
1977	...	...	...	...
1978	...	...	...	...
1979	...	...	...	...
1980	...	...	...	...
1981	...	...	...	...
1982	...	...	...	...
1983	...	...	...	...
1984	...	...	...	...
1985	...	...	...	...
1986	...	...	...	...
1987	...	...	...	...
1988	...	...	...	...
1989	...	...	...	...
1990	...	...	...	...
1991	...	...	...	...
1992	...	...	...	...
1993	...	...	...	...
1994	...	...	...	...
1995	...	...	...	...
1				

Signed D. C. Shackelford