



Western Michigan University  
ScholarWorks at WMU

---

Legacy Scout Tickets from Pure Oil Company

---

8-20-2021

**MGRRE\_PureOilScoutTickets\_DELOS  
MARSH\_1\_21011055230000**

MGRRE  
*Western Michigan University*

Follow this and additional works at: <https://scholarworks.wmich.edu/pure>



Part of the Geology Commons

---

#### WMU ScholarWorks Citation

MGRRE, "MGRRE\_PureOilScoutTickets\_DELOS MARSH\_1\_21011055230000" (2021). *Legacy Scout Tickets from Pure Oil Company*. 149.  
<https://scholarworks.wmich.edu/pure/149>

This Document is brought to you for free and open access via ScholarWorks at WMU. It has been accepted for inclusion in Legacy Scout Tickets from Pure Oil Company by an authorized administrator of ScholarWorks at WMU. See the National Digital Catalogue - Science Base Catalogue for more collections submitted by MGRRE.



---

**MGRRE\_PureOilScoutTickets\_DELOS MARSH\_1\_21011055230000**

API 21011055230000

Permit Number 5523

Lease Name DELOS MARSH

Well Number 1

County Arenac

Township 19N

Range 3E

Section 26

2021 DEQ or Pure co\_name RAYBURN OIL CO INC

Pure Number 159

Latitude 44.0228764

Longitude -84.0716522

## THE PURE O

159

Arenac

FARM Delos Marsh

WELL NO. 1

## SURVEYS

S. 26 T. 19N R. 3E

LOC. SE NW NE

WILDCAT ☐ FIELD ☐ FIELD NAME

MAP NO. \_\_\_\_\_ CO-ORD. \_\_\_\_\_ ELEV \_\_\_\_\_

STATUS

Operators name corrected from:

Will C. Mee

NORTH

[illegible]

1-31-55

JEC

DATE \_\_\_\_\_ SCOUT \_\_\_\_\_

No. 159

DATE October 31, 1938

Corrected

## LOCATION REPORT

No. 159

STATE Michigan COUNTY Arenac ~~DEKX~~ TWP. Adams SEC. 26 TOWN 19 N RANGE 3 E  
WELL No. 1 (SERIAL No. 159) FARM Delos Marsh ACRES

NAME OF STREAM OR WATERS..... QUADRANGLE SE NW NE

OPERATOR Will C. Mee Map Adams Township, Arenac County

Feet from North Line of Farm

“ “ East “ “ “

“ “ South “ “ “

“ “ West “ “ “

Feet from North Line of Section

“ “ East “ “ “

“ “ South “ “ “

“ “ West “ “ “

### LEGEND

## ○ LOCATION

① RIG

⊕ DRILLING

 **GAS WELL**

● OIL WELL

● SMALL OIL WELL

⊙ DRY HOLE

● DRY SHOWING OIL

☀ DRY SHOWING GAS

 **ABANDONED LOCATION**

**ABANDONED GAS WELL.**

## ABANDONED OIL WELL

NOTE: Below make tracing from map. (when no map is obtainable make sketch) showing farm, center of section, this location with measurements and also wells, dry holes, or other locations in the vicinity of this location.

See plat - Serial No. 159.

REMARKS: Change of operator.

SIGNED

.....  
**Superintendent or Foreman.**



OBSERVER MTT C. Nee Map Adams Township, Arenac County  
 NAME OF STREAM OR WATERS QUADRANGLE 2E 11W 1E  
 WELL NO. 1 (SERIAL NO. 159) FARM Dejos Marsh ACRES  
 STATE Michigan COUNTY Arenac TWP. Adams SEC. 26 TOWN 19 N RANGE 3 E  
 PREC. Dejos Marsh  
 NAME OF STREAM OR WATERS QUADRANGLE SE-NW-NE  
 OPERATOR Sterling Drilling Company, Inc. Map Adams Township, Arenac County  
Sterling Drilling Co. Adams - Arenac

Feet from North Line of Farm

280 280 " " East " " "

210 210 " " South " " "

" " West " " "

111 110 Feet from North Line of Section

" " East " " "

" " South " " "

104 1040 " " West " " 1/4

# LEGEND

○ LOCATION

⊙ RIG

⊕ DRILLING

⊗ GAS WELL

● OIL WELL

● SMALL OIL WELL

⊙ DRY HOLE

⊙ DRY SHOWING OIL

⊙ DRY SHOWING GAS

⊙ ABANDONED LOCATION

⊙ ABANDONED GAS WELL

⊙ ABANDONED OIL WELL

NOTE: Below make tracing from map, (when no map is obtainable make sketch) showing farm, center of section, this location with measurements and also wells, dry holes, or other locations in the vicinity of this location.

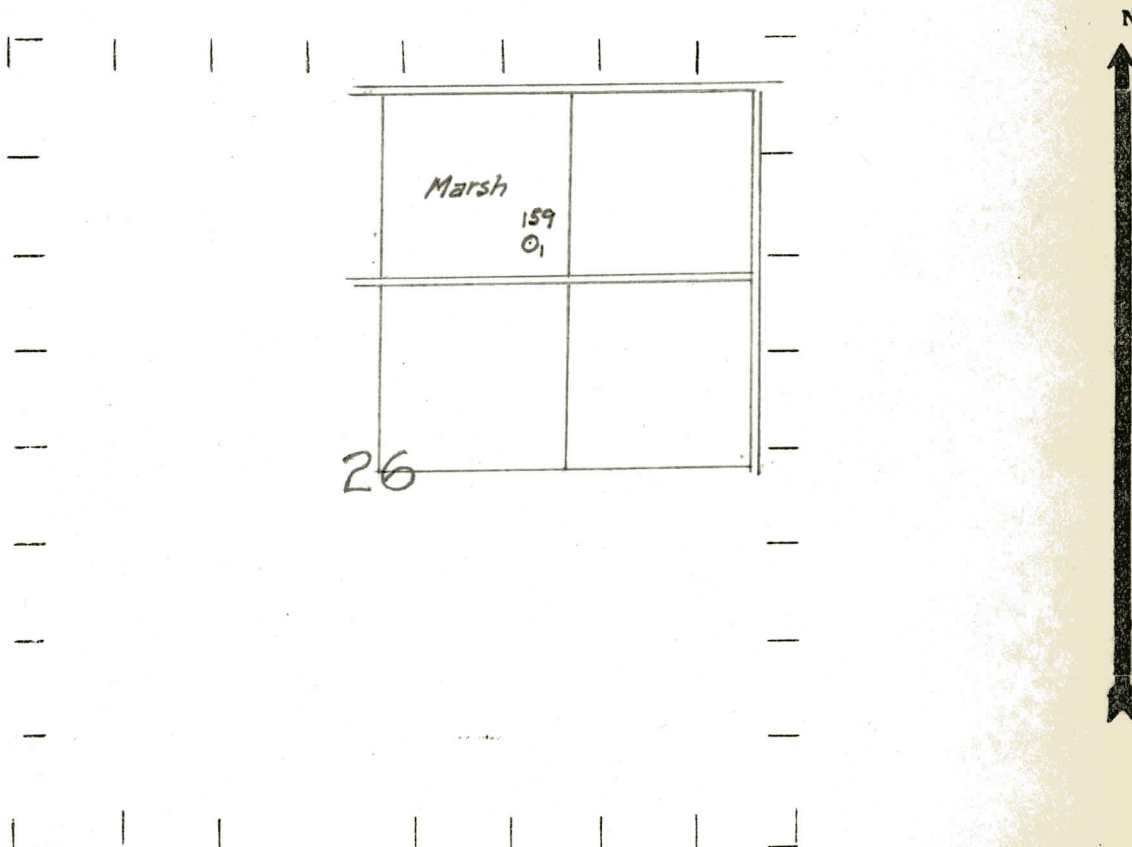

REMARKS:

SIGNED

R. L. J.

Superintendent or Foreman.



Date **March 30, 1939**No. **159**State **Mich.** County **Arenac** Twp. **Adams** Sec. **26** Twp. **19 N** Rge. **3 E**

(Serial No.)

Well No. **1** (~~CONVEYANCE~~) **159** Farm **Delos Marsh** Acres

By

Operator **Sterling Drilling Co., Inc.** Information secured ~~from~~ **Scouting Department**Date well started **10-22-38** Dated well completed **3-15-39** Elevation **741.2**PRODUCTION RECORD1st 24 hours natural **Filled up 900 ft.**

2nd 24 hours natural

Date of shot No. of quarts From to From to

Date of acid **3-22-39** No. of gallons **500**1st 24 hours after acid ~~shot~~ **160 Barrels**

shot

2nd 24 hours after acid

FORMATION AND CASING RECORD

Formation	Top	Bottom	Top Pay	Bottom Pay	Remarks	Casing	
						Size	Set at
<b>Marshall</b>	<b>298</b>			<b>300</b>	<b>Water.</b>	<b>10"</b>	<b>178</b>
<b>Sunbury</b>	<b>1475</b>					<b>8-1/4"</b>	<b>475</b>
<b>Berea</b>	<b>1497</b>	<b>S.L.M.</b>		<b>1565</b>	<b>Show gas &amp; water.</b>	<b>6-5/8"</b>	<b>2006</b>
<b>Antrim</b>	<b>1648</b>					<b>5-5/16"</b> (Liner)	<b>2800</b>
<b>Traverse Lime</b>	<b>2005</b>			<b>2013</b>	<b>Show oil.</b>		
				<b>2027</b>	<b>" " (75')</b>		
			<b>2125</b>	<b>2134</b>	<b>" " (100')</b>		
<b>Dundee</b>	<b>2800</b>	<b>S.L.M.</b>	<b>2953</b>	<b>2958</b>			
<b>Total Depth</b>		<b>2958</b>					

Remarks **Water at 478' - salt water from 2125' to 2134' - show oil 2144'. 1463' C.T.M. equals 1465' S.L.M.; 2955' C.T.M. equals 2958' S.L.M.; 2730' C.T.M. equals 2743' S.L.M.**

Signed

**D. C. Shackelford**