



Western Michigan University  
ScholarWorks at WMU

---

Legacy Scout Tickets from Pure Oil Company

---

8-20-2021

MGRRE\_PureOilScoutTickets\_CRANDELL, S.  
S.\_2\_21011067240000

MGRRE  
*Western Michigan University*

Follow this and additional works at: <https://scholarworks.wmich.edu/pure>



Part of the Geology Commons

---

#### WMU ScholarWorks Citation

MGRRE, "MGRRE\_PureOilScoutTickets\_CRANDELL, S. S.\_2\_21011067240000" (2021). *Legacy Scout Tickets from Pure Oil Company*. 165.  
<https://scholarworks.wmich.edu/pure/165>

This Document is brought to you for free and open access via ScholarWorks at WMU. It has been accepted for inclusion in Legacy Scout Tickets from Pure Oil Company by an authorized administrator of ScholarWorks at WMU. See the National Digital Catalogue - Science Base Catalogue for more collections submitted by MGRRE.



---

**MGRRE\_PureOilScoutTickets\_CRANDELL, S. S.\_2\_21011067240000**

API 21011067240000

Permit Number 6724

Lease Name CRANDELL, S. S.

Well Number 2

County Arenac

Township 20N

Range 4E

Section 10

2021 DEQ or Pure co\_name ROSS W E

Pure Number 176

Latitude 44.15085

Longitude -83.9747

THE PURE OIL COMPANY

DATE September 14, 1939

LOCATION REPORT

No. 176

STATE Michigan COUNTY Arenac TWP. Clayton SEC. 10 TOWN 20 N RANGE 4 E  
PREC. S. S. Crandell

WELL No. 2 (SERIAL No. 176) FARM \_\_\_\_\_ ACRES \_\_\_\_\_

NAME OF STREAM OR WATERS \_\_\_\_\_ QUADRANGLE C SW NE

OPERATOR W. E. Ross Map Clayton Township, Arenac County

660 Feet from North Line of Farm

660 " " East " " "

660 " " South " " "

660 " " West " " "

Feet from North Line of Section

" " East " " "

660 " " South " " "

660 " " West " " "

*Handwritten:*  
340  
Sp 9-8-39  
85/8 184  
65/8 277

- LOCATION
- ⊕ RIG
- ⊕ DRILLING
- ☀ GAS WELL
- OIL WELL
- ⬤ SMALL OIL WELL

LEGEND

- ⊕ DRY HOLE
- ⬤ DRY SHOWING OIL
- ⊕ DRY SHOWING GAS
- ⊕ ABANDONED LOCATION
- ☀ ABANDONED GAS WELL
- ⬤ ABANDONED OIL WELL

NOTE: Below make tracing from map, (when no map is obtainable make sketch) showing farm, center of section, this location with measurements and also wells, dry holes, or other locations in the vicinity of this location.

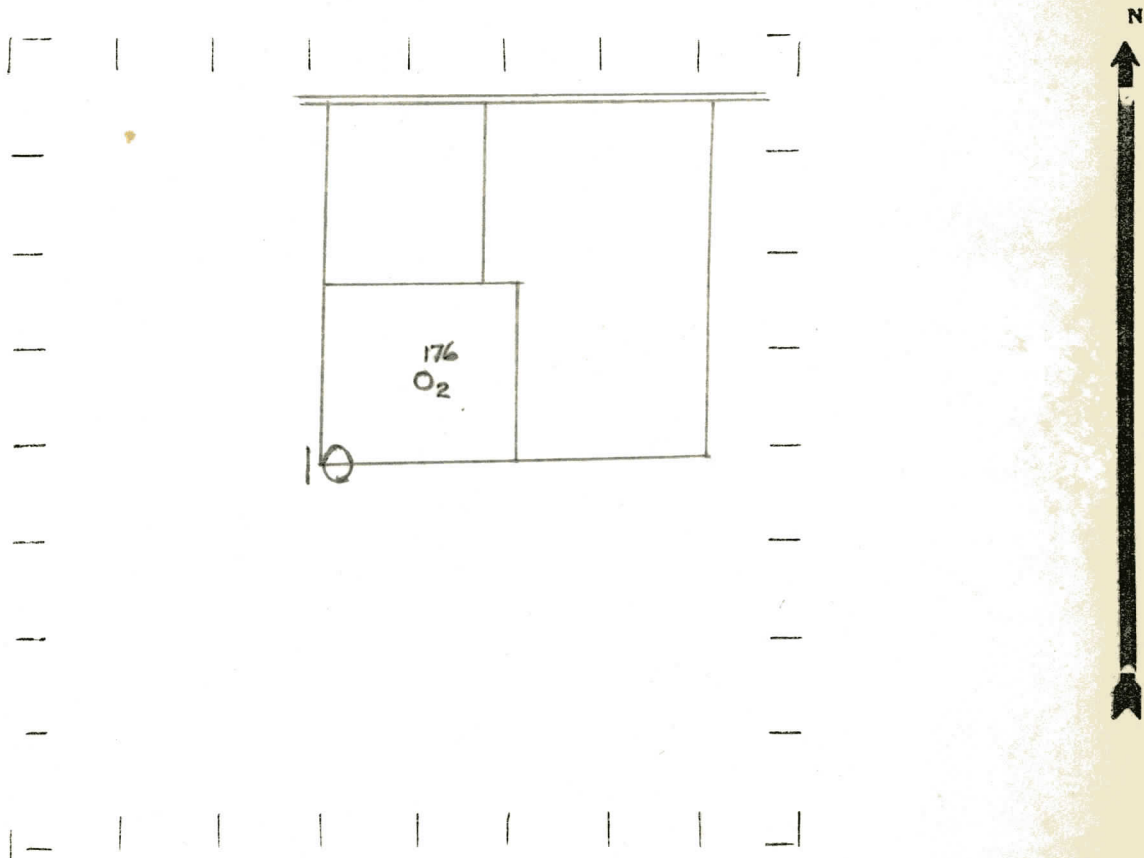

REMARKS:

SIGNED

Superintendent or Foreman.



Michigan Producing Division

## PRODUCTION RECORD

## FORMATION AND CASING RECORD

Remarks

D. C. Shackelford