



Western Michigan University  
ScholarWorks at WMU

---

Legacy Scout Tickets from Pure Oil Company

---

8-20-2021

**MGRRE\_PureOilScoutTickets\_BERGERON, E\_2\_21011072460000**

MGRRE

*Western Michigan University*

Follow this and additional works at: <https://scholarworks.wmich.edu/pure>



Part of the Geology Commons

---

#### WMU ScholarWorks Citation

MGRRE, "MGRRE\_PureOilScoutTickets\_BERGERON, E\_2\_21011072460000" (2021). *Legacy Scout Tickets from Pure Oil Company*. 174.

<https://scholarworks.wmich.edu/pure/174>

This Document is brought to you for free and open access via ScholarWorks at WMU. It has been accepted for inclusion in Legacy Scout Tickets from Pure Oil Company by an authorized administrator of ScholarWorks at WMU. See the National Digital Catalogue - Science Base Catalogue for more collections submitted by MGRRE.



---

**MGRRE\_PureOilScoutTickets\_BERGERON, E\_2\_21011072460000**

API 21011072460000

Permit Number 7246

Lease Name BERGERON, E

Well Number 2

County Arenac

Township 20N

Range 4E

Section 15

2021 DEQ or Pure co\_name RAYBURN DON F

Pure Number 185

Latitude 44.13656

Longitude -83.96961

THE PURE OIL COMPANY

DATE January 10, 1940

LOCATION REPORT

No. 185

STATE Michigan COUNTY Arenac DIST. Clayton TWP. Clayton SEC. 15 TOWN 20 N RANGE 4 E  
WELL No. 2 (SERIAL No. 185) FARM E. Bergeron ACRES

NAME OF STREAM OR WATERS QUADRANGLE CSE NE

OPERATOR Don Rayburn Map Clayton Township, Arenac County

Don Rayburn  
Feet from North Line of Farm

66660 " " East " " "  
710710 " " South " " "  
" " West " " "

Feet from North Line of Section

66660 " " East " " "  
710 710 " " South " 1 1/4 "  
" " West " " "

- LOCATION  
⊕ RIG  
⊕ DRILLING  
⊗ GAS WELL  
● OIL WELL  
● SMALL OIL WELL

LEGEND

- ⊗ DRY HOLE  
⊗ DRY SHOWING OIL  
⊗ DRY SHOWING GAS  
⊗ ABANDONED LOCATION  
⊗ ABANDONED GAS WELL  
⊗ ABANDONED OIL WELL

NOTE: Below make tracing from map, (when no map is obtainable make sketch) showing farm, center of section, this location with measurements and also wells, dry holes, or other locations in the vicinity of this location.

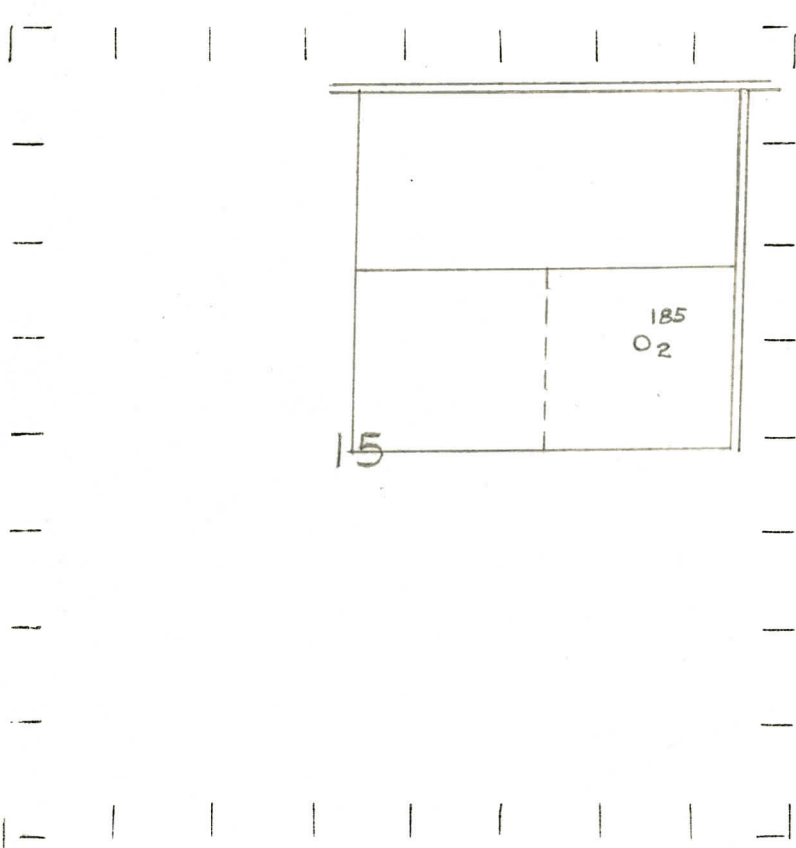

REMARKS:

SIGNED

Superintendent or Foreman.



D. C. Shackelford