



Western Michigan University
ScholarWorks at WMU

Legacy Scout Tickets from Pure Oil Company

8-20-2021

MGRRE_PureOilScoutTickets_Country Club_unk_unk

MGRRE

Western Michigan University

Follow this and additional works at: <https://scholarworks.wmich.edu/pure>



Part of the Geology Commons

WMU ScholarWorks Citation

MGRRE, "MGRRE_PureOilScoutTickets_Country Club_unk_unk" (2021). *Legacy Scout Tickets from Pure Oil Company*. 10743.

<https://scholarworks.wmich.edu/pure/10743>

This Document is brought to you for free and open access via ScholarWorks at WMU. It has been accepted for inclusion in Legacy Scout Tickets from Pure Oil Company by an authorized administrator of ScholarWorks at WMU. See the National Digital Catalogue - Science Base Catalogue for more collections submitted by MGRRE.



MGRRE_PureOilScoutTickets_Country Club_unk_unk

API unk

Permit Number unk

Lease Name Country Club

Well Number unk

County Wayne

Township 01S

Range 13E

Section 9

2021 DEQ or Pure co_name Detroit Natural Gas Co.

Pure Number 4

Latitude 42.4278

Longitude -82.91567

Feb 1 - 1934

THE PURE OIL COMPANY

LOCATION REPORT

No. 4

DATE 2/1/34

STATE Mich COUNTY Wayne DIST. Gratiot TWP. Gratiot SEC. 9 TOWN 15 RANGE 13 E

WELL No. (SERIAL No. 4) FARM Country Club ACRES

NAME OF STREAM OR WATERS QUADRANGLE

OPERATOR Detroit Natural Gas Company MAP Gratiot Twp - Wayne Co.

Feet from North Line of Farm

East

South

West

Feet from North Line of Section

East

South

West

LEGEND

- LOCATION, RIG, DRILLING, GAS WELL, OIL WELL, SMALL OIL WELL, DRY HOLE, DRY SHOWING OIL, DRY SHOWING GAS, ABANDONED LOCATION, ABANDONED GAS WELL, ABANDONED OIL WELL

NOTE: Below make tracing from map, (when no map is obtainable make sketch) showing farm, center of section, this location with measurements and also wells, dry holes, or other locations in the vicinity of this location. Make copy to keep for reference and send original to Columbus office.

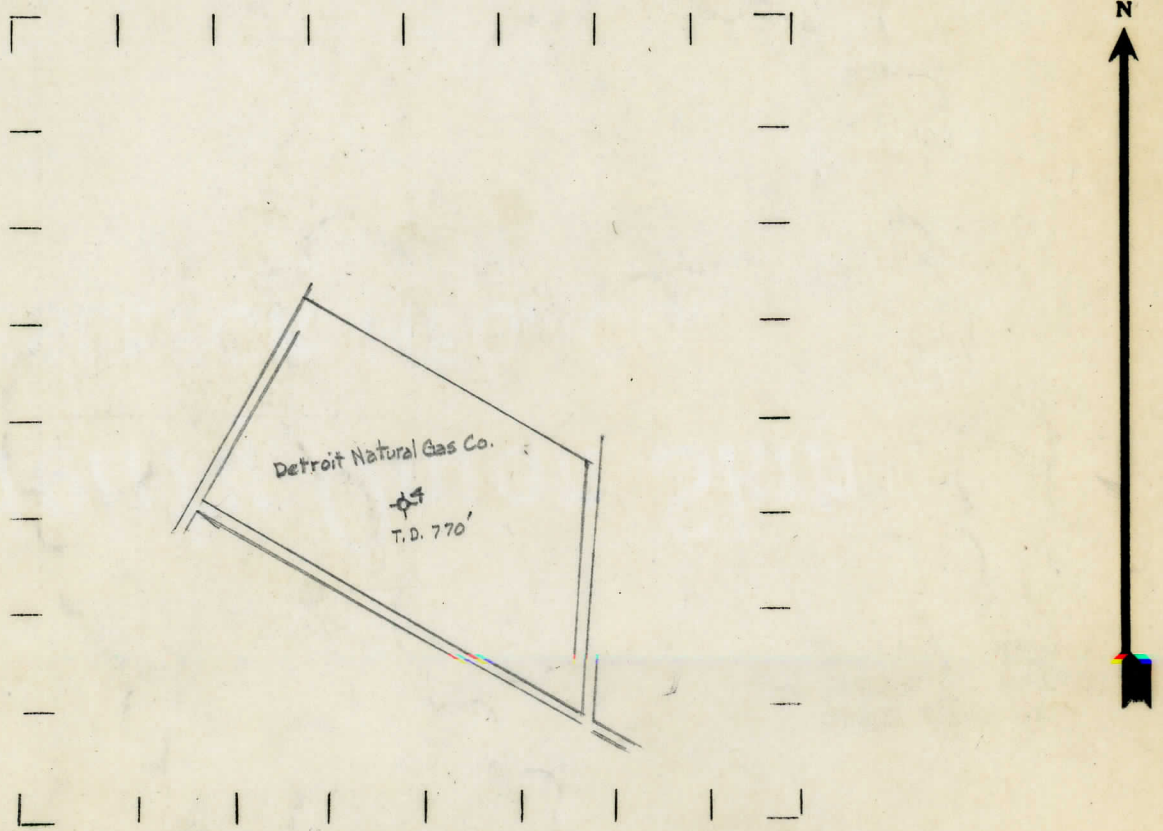

REMARKS: Location data from Geological records. T.D. 770'

Location data from Geological records T. D. 770'

SIGNED R. D. Yeager Superintendent or Foreman.

DATE January 2, 1934

LOCATION REPORT

No. 4

STATE Michigan COUNTY Wayne DIST. Gratiot TWP. SEC. 9 TOWN 1-S RANGE 13 E

WELL No. (SERIAL No. 4) FARM ACRES

NAME OF STREAM OR WATERS QUADRANGLE C-NE-SW

OPERATOR Detroit Natural Gas Co. MAP Gratiot Township, Wayne County

Feet from North Line of Farm

East

South

West

Feet from North Line of Section

East

South

West

2000

2000

LEGEND

- LOCATION, RIG, DRILLING, GAS WELL, OIL WELL, SMALL OIL WELL, DRY HOLE, DRY SHOWING OIL, DRY SHOWING GAS, ABANDONED LOCATION, ABANDONED GAS WELL, ABANDONED OIL WELL

NOTE: Below make tracing from map, (when no map is obtainable make sketch) showing farm, center of section, this location with measurements and also wells, dry holes, or other locations in the vicinity of this location. Make copy to keep for reference and send original to Columbus office.

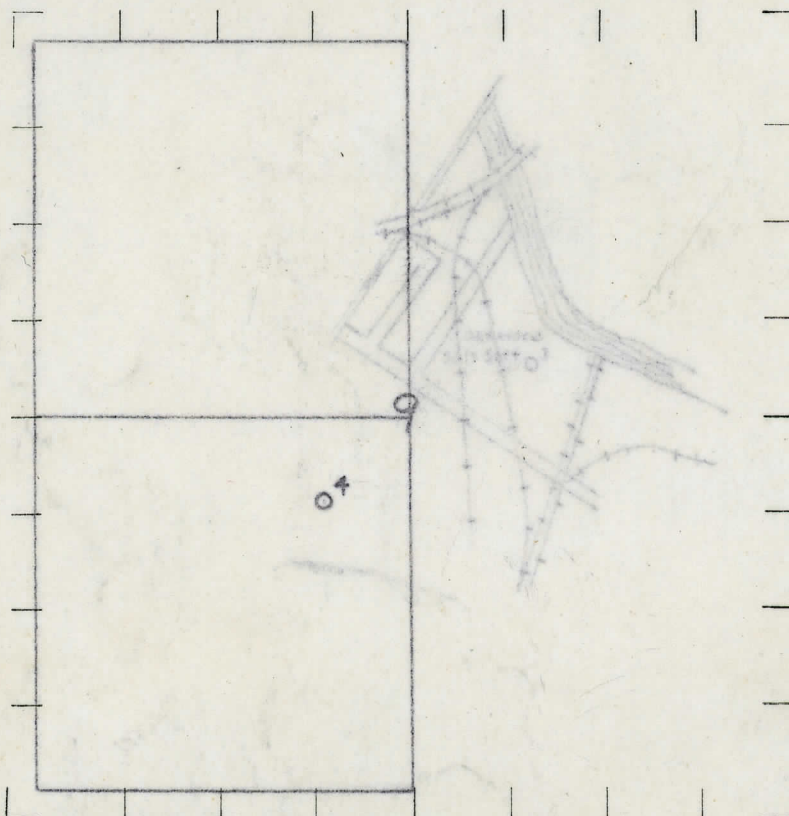

Traverse 192-475
Dundee 475-580
Total Depth 770'

REMARKS:

Pub. #14 - pp. 104

SIGNED

R. L. Yeager
Superintendent or Foreman.