



Western Michigan University
ScholarWorks at WMU

Legacy Scout Tickets from Pure Oil Company

8-20-2021

MGRRE_PureOilScoutTickets_Solvay Process Company_4_unk

MGRRE

Western Michigan University

Follow this and additional works at: <https://scholarworks.wmich.edu/pure>



Part of the Geology Commons

WMU ScholarWorks Citation

MGRRE, "MGRRE_PureOilScoutTickets_Solvay Process Company_4_unk" (2021). *Legacy Scout Tickets from Pure Oil Company*. 10749.

<https://scholarworks.wmich.edu/pure/10749>

This Document is brought to you for free and open access via ScholarWorks at WMU. It has been accepted for inclusion in Legacy Scout Tickets from Pure Oil Company by an authorized administrator of ScholarWorks at WMU. See the National Digital Catalogue - Science Base Catalogue for more collections submitted by MGRRE.



MGRRE_PureOilScoutTickets_Solvay Process Company_4_unk

API unk

Permit Number unk

Lease Name Solvay Process Company

Well Number 4

County Wayne

Township 04S

Range 10E

Section 7

2021 DEQ or Pure co_name Church & Company

Pure Number 14

Latitude 42.1595787

Longitude -83.2957548

Feb-1-1934

THE PURE OIL COMPANY

LOCATION REPORT

No. 14

DATE 2/1/34

STATE Michigan COUNTY Wayne DIST. Monguagon TWP. Monguagon SEC. 7 TOWN 4 S RANGE 10 E

WELL No. 4 (SERIAL No. 14) FARM Solvay Process Company ACRES

NAME OF STREAM OR WATERS QUADRANGLE

OPERATOR Church & Company MAP Monguagon Township, Wayne County

Feet from North Line of Farm

East

South

West

Feet from North Line of Section

East

South

West

LEGEND

- LOCATION, RIG, DRILLING, GAS WELL, OIL WELL, SMALL OIL WELL, DRY HOLE, DRY SHOWING OIL, DRY SHOWING GAS, ABANDONED LOCATION, ABANDONED GAS WELL, ABANDONED OIL WELL

NOTE: Below make tracing from map, (when no map is obtainable make sketch) showing farm, center of section, this location with measurements and also wells, dry holes, or other locations in the vicinity of this location. Make copy to keep for reference and send original to Columbus office.

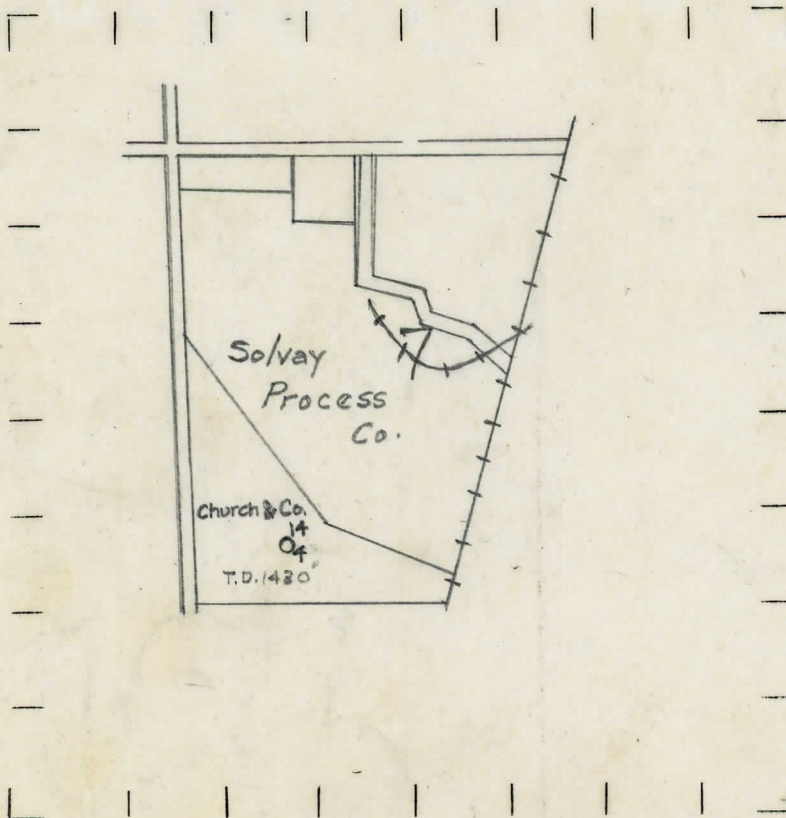

REMARKS: Locations conforming to Geol. Dept. records. T.D. 1430'

Locations conforming to Geological Dept.'s records T. D. 1430'

SIGNED

R. L. Yeager Superintendent or Foreman.

DATE 5/1/34

LOCATION REPORT

No. 14

DATE January 2, 1934

LOCATION REPORT

No. 14

STATE Michigan COUNTY Wayne DIST. Monguagon SEC. 7 TOWN 4 S RANGE 11 E

WELL No. 4 (SERIAL No. 14) FARM ACRES

NAME OF STREAM OR WATERS QUADRANGLE SW-SW-SW

OPERATOR Church & Company MAP Monguagon Township, Wayne County

Feet from North Line of Farm

East

South

West

Feet from North Line of Section

East

300 South

300 West

LEGEND

- LOCATION, RIG, DRILLING, GAS WELL, OIL WELL, SMALL OIL WELL, DRY HOLE, DRY SHOWING OIL, DRY SHOWING GAS, ABANDONED LOCATION, ABANDONED GAS WELL, ABANDONED OIL WELL

NOTE: Below make tracing from map, (when no map is obtainable make sketch) showing farm, center of section, this location with measurements and also wells, dry holes, or other locations in the vicinity of this location. Make copy to keep for reference and send original to Columbus office.

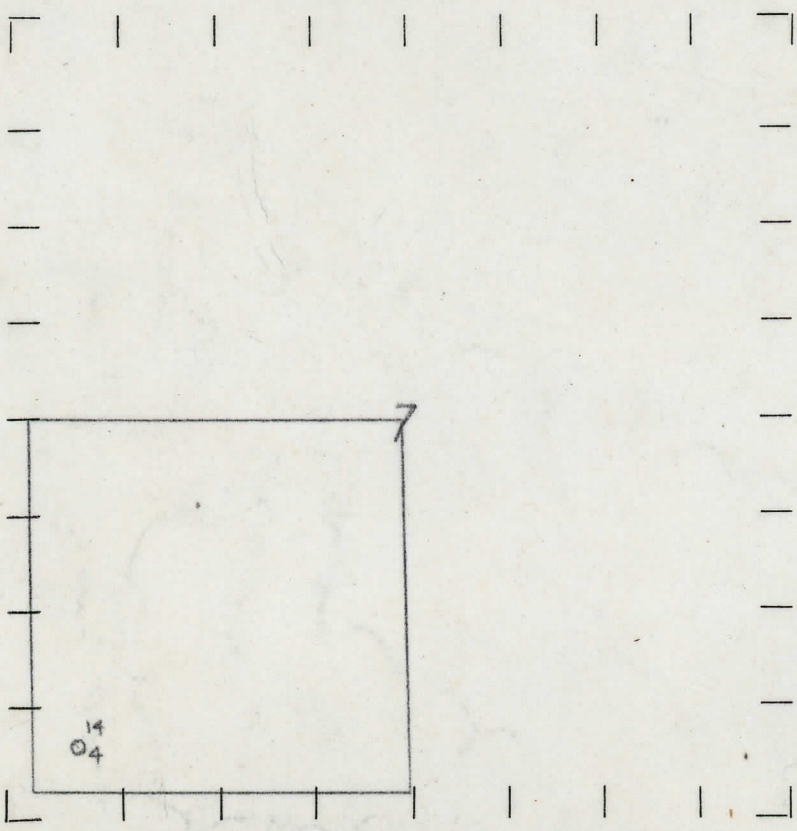

Surface 0-30
Dundee 30-100
Smell Gas 1310-1340
Sylvania 279-434
Salina 1185
Total Depth 1430'

REMARKS: Pub. #24 - pp.255

SIGNED

R. P. Meyer
Superintendent or Foreman.