



Western Michigan University
ScholarWorks at WMU

Legacy Scout Tickets from Pure Oil Company

8-20-2021

MGRRE_PureOilScoutTickets_Ford, H. H._1_unk

MGRRE

Western Michigan University

Follow this and additional works at: <https://scholarworks.wmich.edu/pure>



Part of the Geology Commons

WMU ScholarWorks Citation

MGRRE, "MGRRE_PureOilScoutTickets_Ford, H. H._1_unk" (2021). *Legacy Scout Tickets from Pure Oil Company*. 10750.

<https://scholarworks.wmich.edu/pure/10750>

This Document is brought to you for free and open access via ScholarWorks at WMU. It has been accepted for inclusion in Legacy Scout Tickets from Pure Oil Company by an authorized administrator of ScholarWorks at WMU. See the National Digital Catalogue - Science Base Catalogue for more collections submitted by MGRRE.



MGRRE_PureOilScoutTickets_Ford, H. H._1_unk

API unk

Permit Number unk

Lease Name Ford, H. H.

Well Number 1

County Wayne

Township 02S

Range 10E

Section 22

2021 DEQ or Pure co_name Ford, H. F,

Pure Number 15

Latitude 42.30604

Longitude -83.24264

THE PURE OIL COMPANY

LOCATION REPORT

No. 115

DATE 2/1/34

STATE Michigan COUNTY Wayne DIST. Dearborne TWP. Dearborn SEC. 22 TOWN 2 S RANGE 10 E. WELL No. 1 (SERIAL No. 15) FARM Dearborn Plant ACRES

NAME OF STREAM OR WATERS OPERATOR H. F. Ford H. F. Ford MAP Dearborn Township, Wayne County

Feet from North Line of Farm ... Feet from North Line of Section ...

LEGEND

- LOCATION, RIG, DRILLING, GAS WELL, OIL WELL, SMALL OIL WELL, DRY HOLE, DRY SHOWING OIL, DRY SHOWING GAS, ABANDONED LOCATION, ABANDONED GAS WELL, ABANDONED OIL WELL

NOTE: Below make tracing from map, (when no map is obtainable make sketch) showing farm, center of section, this location with measurements and also wells, dry holes, or other locations in the vicinity of this location. Make copy to keep for reference and send original to Columbus office.

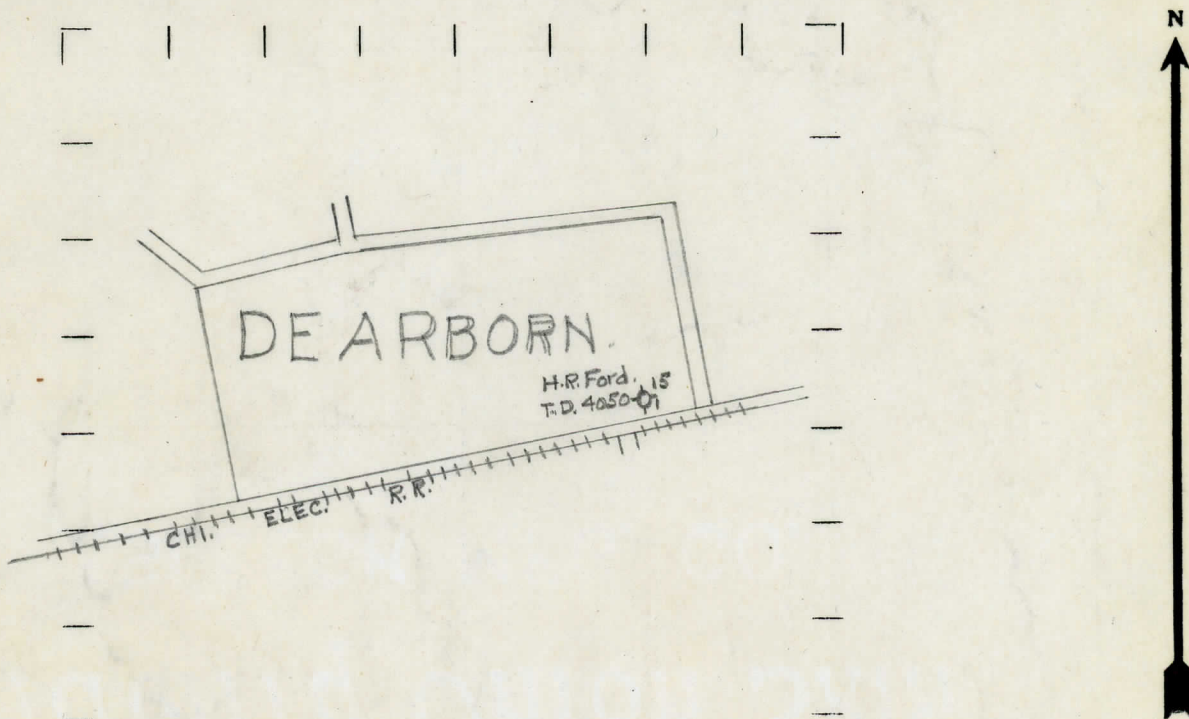

REMARKS: Loc. data from Geological records Location data from Geological records T.D. 4050' T. D. 4050'

SIGNED

R. L. Yagse Superintendent or Foreman

DATE January 2, 1934

LOCATION REPORT

No. 15

STATE Michigan COUNTY Wayne DIST. Dearborn SEC. 22 TOWN 25 RANGE 10 E

WELL No. 1 (SERIAL No. 15) FARM H. H. Ford ACRES

NAME OF STREAM OR WATERS QUADRANGLE SE-SW-NE

OPERATOR H. H. Ford MAP Dearborn Township, Wayne County

Feet from North Line of Farm
 " " East " " "
 " " South " " "
 " " West " " "
2300 Feet from North Line of Section
1400 " " East " " "
 " " South " " "
 " " West " " "

- LEGEND**
- LOCATION
 - ⊙ RIG
 - ⊕ DRILLING
 - ⊗ GAS WELL
 - OIL WELL
 - ⬤ SMALL OIL WELL
 - ⊖ DRY HOLE
 - ⬢ DRY SHOWING OIL
 - ⊗ DRY SHOWING GAS
 - ⊖ ABANDONED LOCATION
 - ⊗ ABANDONED GAS WELL
 - ⬢ ABANDONED OIL WELL

NOTE: Below make tracing from map, (when no map is obtainable make sketch) showing farm, center of section, this location with measurements and also wells, dry holes, or other locations in the vicinity of this location. Make copy to keep for reference and send original to Columbus office.

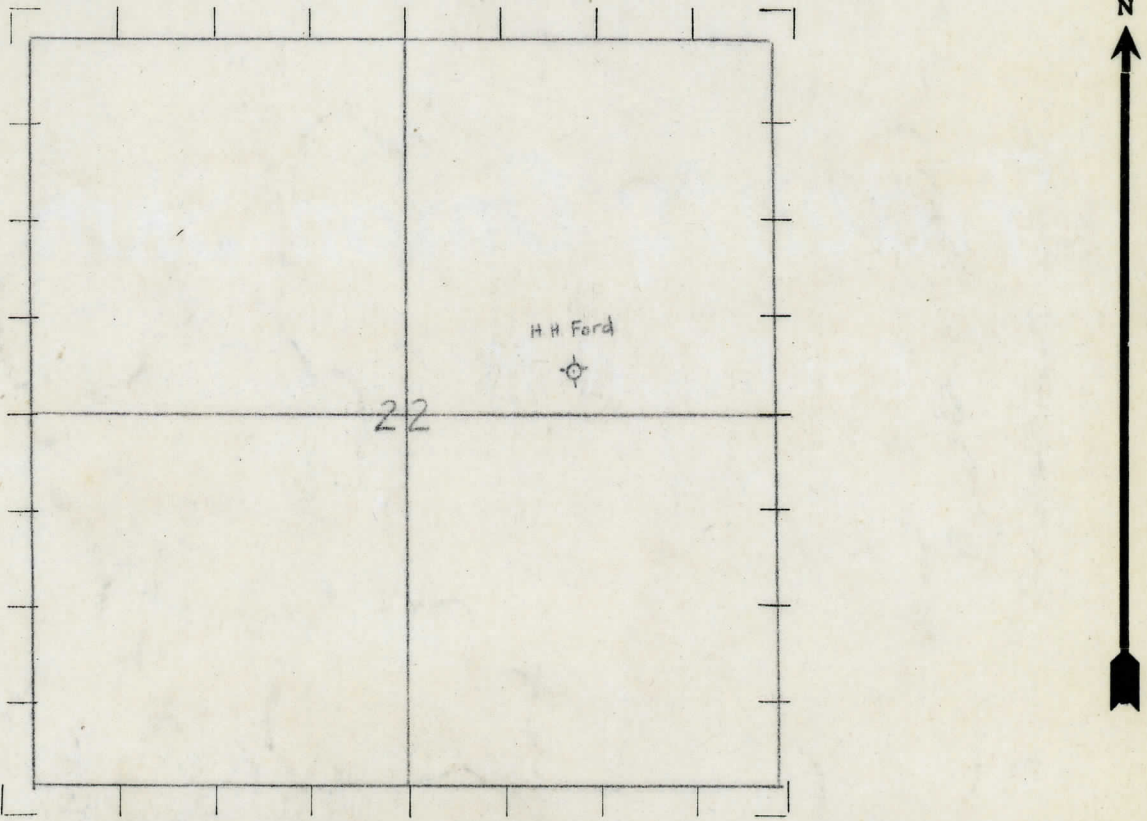

REMARKS: Drilled 100' S. of Henry Ford Machine Shop - Dearborn
Date Started 6/14/15.

Surface 0-125
 Dundee 125-215
 Sylvania 495-620
 Salina 990'
 Trenton 3050-3925
 Total Depth 4050'

SIGNED

R. L. Yeager
 Superintendent or Foreman.