



Western Michigan University
ScholarWorks at WMU

Legacy Scout Tickets from Pure Oil Company

8-20-2021

MGRRE_PureOilScoutTickets_Janner,
Herman_1_21163027790000

MGRRE
Western Michigan University

Follow this and additional works at: <https://scholarworks.wmich.edu/pure>



Part of the Geology Commons

WMU ScholarWorks Citation

MGRRE, "MGRRE_PureOilScoutTickets_Janner, Herman_1_21163027790000" (2021). *Legacy Scout Tickets from Pure Oil Company*. 10757.
<https://scholarworks.wmich.edu/pure/10757>

This Document is brought to you for free and open access via ScholarWorks at WMU. It has been accepted for inclusion in Legacy Scout Tickets from Pure Oil Company by an authorized administrator of ScholarWorks at WMU. See the National Digital Catalogue - Science Base Catalogue for more collections submitted by MGRRE.



MGRRE_PureOilScoutTickets_Janner, Herman_1_21163027790000

API 21163027790000

Permit Number 2779

Lease Name Janner, Herman

Well Number 1

County Wayne

Township 02S

Range 09E

Section 16

2021 DEQ or Pure co_name Michigan Montana Oil Company

Pure Number 26

Latitude 42.31835

Longitude -83.37285

The Pure Oil Company
THE PURE OIL COMPANYDATE September 26, 1935

LOCATION REPORT

No. 26STATE Michigan COUNTY Wayne DIST. Nankin TWP. Nankin SEC. 16 TOWN 2S RANGE 9EWELL No. 1 (SERIAL No. 26) FARM Herman Jenner ACRESNAME OF STREAM OR WATERS QUADRANGLE SW-SE-NEOPERATOR Michigan-Montana Oil Company Map Nankin Township, Wayne County
Mich. Montana Oil Co. Nankin - Wayne Co.

Feet from North Line of Farm

330 330 " " East " " "330 330 " " South " " "

" " West " " "

Feet from North Line of Section

990 990 " " East " " "330 330 " " South " " $\frac{1}{4}$ "

" " West " " "

LEGEND

○ LOCATION

① RIG

⊕ DRILLING

☼ GAS WELL

● OIL WELL

● SMALL OIL WELL

⊙ DRY HOLE

⊙ DRY SHOWING OIL

⊙ DRY SHOWING GAS

⊙ ABANDONED LOCATION

☼ ABANDONED GAS WELL

● ABANDONED OIL WELL

NOTE: Below make tracing from map, (when no map is obtainable make sketch) showing farm, center of section, this location with measurements and also wells, dry holes, or other locations in the vicinity of this location.

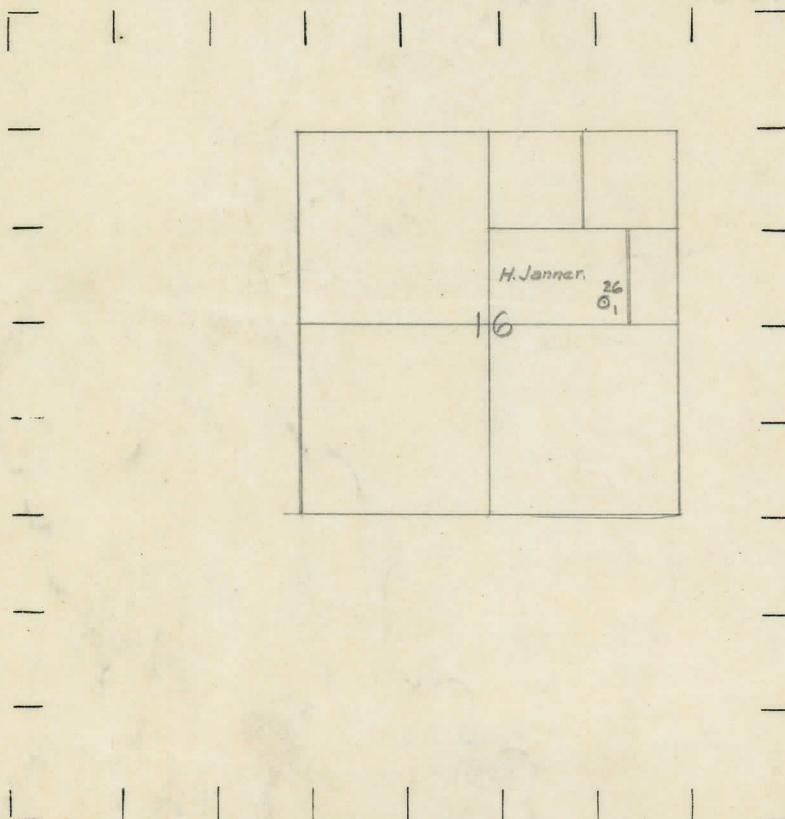

REMARKS:

SIGNED

Superintendent or Foreman.

