



Western Michigan University  
ScholarWorks at WMU

---

Legacy Scout Tickets from Pure Oil Company

---

8-20-2021

## MGRRE\_PureOilScoutTickets\_Gyda\_1\_na

MGRRE

*Western Michigan University*

Follow this and additional works at: <https://scholarworks.wmich.edu/pure>



Part of the Geology Commons

---

### WMU ScholarWorks Citation

MGRRE, "MGRRE\_PureOilScoutTickets\_Gyda\_1\_na" (2021). *Legacy Scout Tickets from Pure Oil Company*. 10759.

<https://scholarworks.wmich.edu/pure/10759>

This Document is brought to you for free and open access via ScholarWorks at WMU. It has been accepted for inclusion in Legacy Scout Tickets from Pure Oil Company by an authorized administrator of ScholarWorks at WMU. See the National Digital Catalogue - Science Base Catalogue for more collections submitted by MGRRE.



---

## MGRRE\_PureOilScoutTickets\_Gyda\_1\_na

API na

Permit Number na

Lease Name Gyda

Well Number 1

County Wayne

Township 02S

Range 08E

Section 5

2021 DEQ or Pure co\_name Brown, Lee

Pure Number 28

Latitude 42.342936

Longitude -83.5180267

## THE PURE OIL COMPANY

DATE 12-12-35

## LOCATION REPORT

No. 28STATE Mich. COUNTY WayneDIST. CantonTWP. CantonSEC. 5TOWN 2-SRANGE 8 EWELL No. 1 1 (SERIAL No. 28) FARM Cyda ACRES

NAME OF STREAM OR WATERS

QUADRANGLE

NW NW SWOPERATOR Lee Brown

Map

Canton Twp., Wayne CountyLee Brown.Canton Twp - Wayne Co.

Feet from North Line of Farm

990 990 " " East " " "990 990 " " South " " "

" " West " " "

330 330 Feet from North Line of Section

" " East " " "

" " South " " "

330 330 " " West " " "

## LEGEND

O LOCATION

① RIG

⊕ DRILLING

☀ GAS WELL

● OIL WELL

⬮ SMALL OIL WELL

⊙ DRY HOLE

⬮ DRY SHOWING OIL

⊙ DRY SHOWING GAS

⊙ ABANDONED LOCATION

☀ ABANDONED GAS WELL

⬮ ABANDONED OIL WELL

NOTE: Below make tracing from map, (when no map is obtainable make sketch) showing farm, center of section, this location with measurements and also wells, dry holes, or other locations in the vicinity of this location.

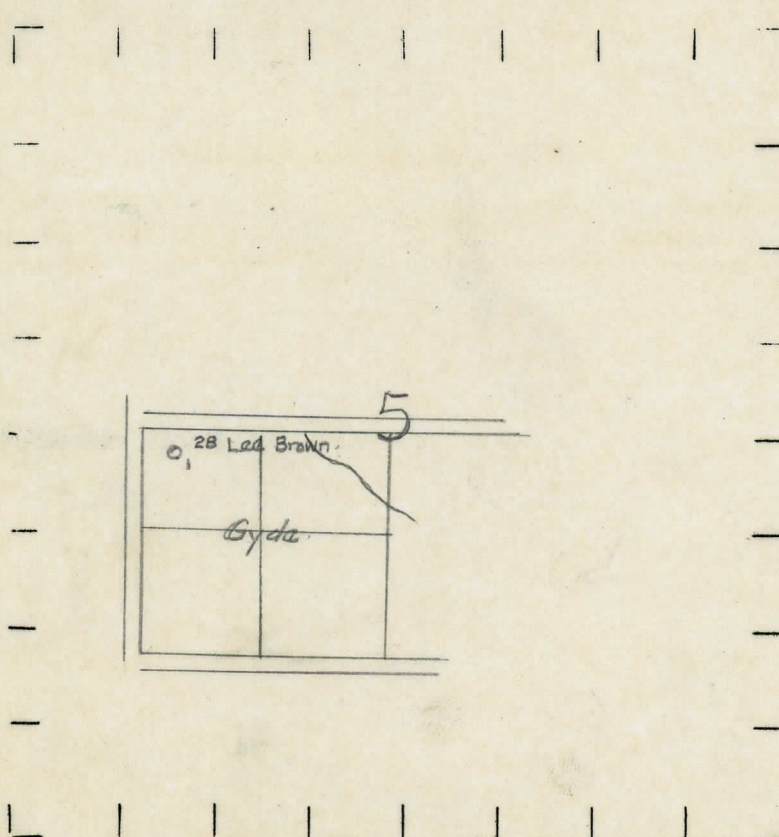

REMARKS:

SIGNED

Superintendent or Foreman.

## COMPLETION RECORD OF WELLS DRILLED BY OTHER OPERATORS

Michigan Producing Division

Date 1-16-36 No. 28  
State Mich. County Wayne Dist. Canton  
Twp. Sec. 5 Twp. 2 N Rge. 8 E  
(Serial No.)  
Well No. 1 (County No.) 28 Farm Cyde Acres  
Operator Lee Brown by  
Information secured from Scouting Dept.  
Date well started Not started Date well completed Not completed Elevation

# PRODUCTION RECORD

1st 24 hours natural Location abandoned

2nd 24 hours natural

Date of shot No. of  
quarts From to From to

Date of acid No. of gallons

1st 24 hours after acid shot

2nd 24 hours after acid shot

FORMATION AND CASING RECORD

Formation	Top	Bottom	Top Pay	Bottom Pay	Remarks	Casing	
						Size	Set at
Location abandoned 1-15-36.							

[illegible]

Signed .....