



Western Michigan University
ScholarWorks at WMU

Legacy Scout Tickets from Pure Oil Company

8-20-2021

**MGRRE_PureOilScoutTickets_Boynton, Mrs.
Ann_1_21163037010000**

MGRRE
Western Michigan University

Follow this and additional works at: <https://scholarworks.wmich.edu/pure>



Part of the Geology Commons

WMU ScholarWorks Citation

MGRRE, "MGRRE_PureOilScoutTickets_Boynton, Mrs. Ann_1_21163037010000" (2021). *Legacy Scout Tickets from Pure Oil Company*. 10763.
<https://scholarworks.wmich.edu/pure/10763>

This Document is brought to you for free and open access via ScholarWorks at WMU. It has been accepted for inclusion in Legacy Scout Tickets from Pure Oil Company by an authorized administrator of ScholarWorks at WMU. See the National Digital Catalogue - Science Base Catalogue for more collections submitted by MGRRE.



MGRRE_PureOilScoutTickets_Boynton, Mrs. Ann_1_21163037010000

API 21163037010000

Permit Number 3701

Lease Name Boynton, Mrs. Ann

Well Number 1

County Wayne

Township 04S

Range 08E

Section 27

2021 DEQ or Pure co_name Pontchartrain Petroleum Corporation

Pure Number 32

Latitude 42.11163

Longitude -83.46385

DATE November 27, 1936

LOCATION REPORT

No. 32STATE Michigan

COUNTY

Wayne
Wayne

DIST.

Sumpter
Sumpter

TWP.

SEC.

27
27

TOWN

45
45

RANGE

8E
8EWELL No. 1(SERIAL No. 32)

FARM

PREC.

Ann Boynton
Ann Boynton

ACRES

NAME OF STREAM OR WATERS

QUADRANGLE

NW-SE-NE
NW SE NEOPERATOR Pontchartrain Petroleum Corporation

Map

Sumpter Township, Wayne County330330Pontchartrain Pet. Corp.Sumpter - Wayne Co.

Feet from North Line of Farm

990990

" " East " " "

" " South " " "

" " West " " "

Feet from North Line of Section

990990

" " East " " "

990990" " South " 1/4 "

" " West " " "

LEGEND

○ LOCATION

① RIG

⊕ DRILLING

☼ GAS WELL

● OIL WELL

⬮ SMALL OIL WELL

⊖ DRY HOLE

⬮ DRY SHOWING OIL

⊖ DRY SHOWING GAS

⊖ ABANDONED LOCATION

☼ ABANDONED GAS WELL

⬮ ABANDONED OIL WELL

NOTE: Below make tracing from map, (when no map is obtainable make sketch) showing farm, center of section, this location with measurements and also wells, dry holes, or other locations in the vicinity of this location.

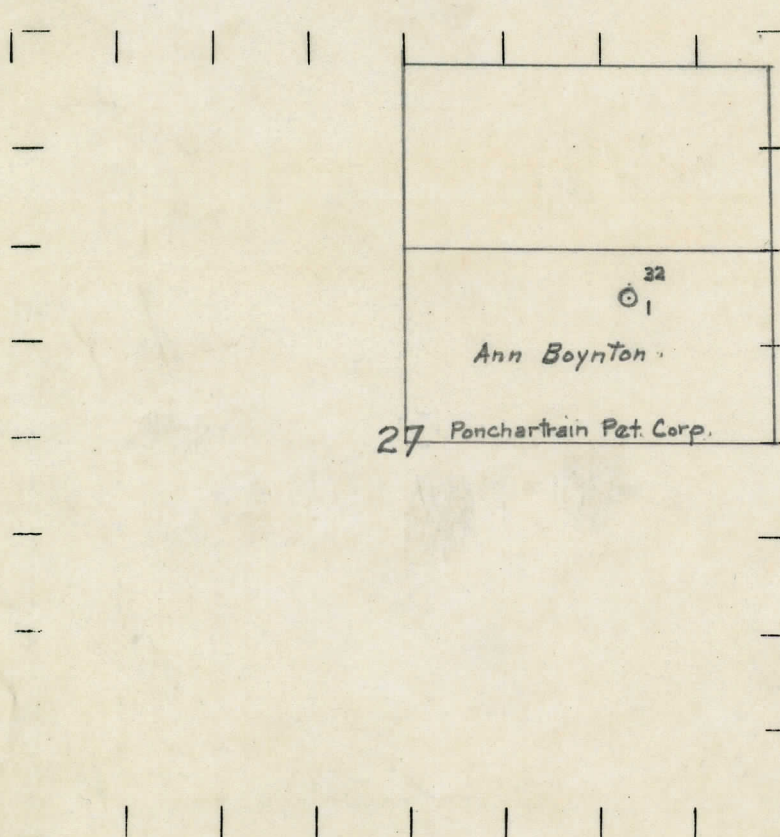

REMARKS:

SIGNED

R. L. Yeager
 Superintendent or Foreman

Michigan Producing Division

PRODUCTION RECORD

2nd 24 hours after acid

FORMATION AND CASING RECORD

Remarks

Signed D. C. Shackelford