



Western Michigan University
ScholarWorks at WMU

Legacy Scout Tickets from Pure Oil Company

8-20-2021

MGRRE_PureOilScoutTickets_Truesdell,
Lewis_1_21163038130000

MGRRE
Western Michigan University

Follow this and additional works at: <https://scholarworks.wmich.edu/pure>



Part of the Geology Commons

WMU ScholarWorks Citation

MGRRE, "MGRRE_PureOilScoutTickets_Truesdell, Lewis_1_21163038130000" (2021). *Legacy Scout Tickets from Pure Oil Company*. 10765.
<https://scholarworks.wmich.edu/pure/10765>

This Document is brought to you for free and open access via ScholarWorks at WMU. It has been accepted for inclusion in Legacy Scout Tickets from Pure Oil Company by an authorized administrator of ScholarWorks at WMU. See the National Digital Catalogue - Science Base Catalogue for more collections submitted by MGRRE.



MGRRE_PureOilScoutTickets_Truesdell, Lewis_1_21163038130000

API 21163038130000

Permit Number 3813

Lease Name Truesdell, Lewis

Well Number 1

County Wayne

Township 02S

Range 08E

Section 25

2021 DEQ or Pure co_name Darke Brothers

Pure Number 34

Latitude 42.28019

Longitude -83.44569

THE PURE OIL COMPANY
LOCATION REPORT

DATE January 20, 1937

No. 34

STATE Michigan

COUNTY Wayne

DIST. Canton

TWP. Canton

SEC. 25

TOWN 2 S

RANGE 8 E

WELL No. 1 (SERIAL No. 34) FARM

PREC. Lewis Truesdell

ACRES

NAME OF STREAM OR WATERS

QUADRANGLE SW-SW-SW
SW-SW-SW

OPERATOR Darke Bros.

Map Canton Twp., Wayne County

Darke Bros.

Canton - Wayne Co.

Feet from North Line of Farm

990 990 " " East " " "

330 330 " " South " " "

" " West " " "

Feet from North Line of Section

" " East " " "

330 330 " " South " " "

330 330 " " West " " "

LEGEND

○ LOCATION

⊕ RIG

⊕ DRILLING

⊕ GAS WELL

● OIL WELL

⊕ SMALL OIL WELL

⊕ DRY HOLE

⊕ DRY SHOWING OIL

⊕ DRY SHOWING GAS

⊕ ABANDONED LOCATION

⊕ ABANDONED GAS WELL

⊕ ABANDONED OIL WELL

NOTE: Below make tracing from map, (when no map is obtainable make sketch) showing farm, center of section, this location with measurements and also wells, dry holes, or other locations in the vicinity of this location.

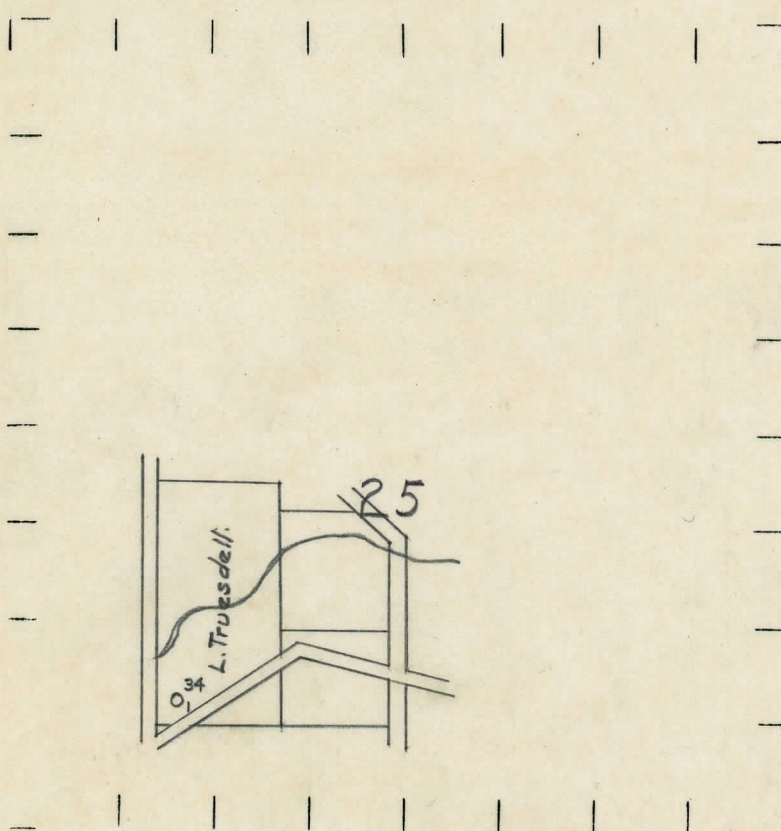

REMARKS:

SIGNED

R. L. Yeager
Superintendent or Foreman.

Geo. H. Bell