



Western Michigan University  
ScholarWorks at WMU

---

Legacy Scout Tickets from Pure Oil Company

---

9-14-2021

## MGRRE\_PureOilScoutTickets\_Freedman & Strauss\_1\_21127011720000

MGRRE

*Western Michigan University*

Follow this and additional works at: <https://scholarworks.wmich.edu/pure>



Part of the Geology Commons

---

### WMU ScholarWorks Citation

MGRRE, "MGRRE\_PureOilScoutTickets\_Freedman & Strauss\_1\_21127011720000" (2021). *Legacy Scout Tickets from Pure Oil Company*. 10822.

<https://scholarworks.wmich.edu/pure/10822>

This Document is brought to you for free and open access via ScholarWorks at WMU. It has been accepted for inclusion in Legacy Scout Tickets from Pure Oil Company by an authorized administrator of ScholarWorks at WMU. See the National Digital Catalogue - Science Base Catalogue for more collections submitted by MGRRE.



---

**MGRRE\_PureOilScoutTickets\_Freedman & Strauss\_1\_21127011720000**

API 21127011720000

Permit Number 1172

Lease Name Freedman & Strauss

Well Number 1

County Oceana

Township 13N

Range 16W

Section 35

2021 DEQ or Pure co\_name Fruitvale Land and Lot Owners

Pure Number 23

Latitude 43.48202

Longitude -86.19675

DATE 6-27-31

LOCATION REPORT

No. 23

STATE Michigan COUNTY Oceana DIST. Otto SEC. 35 TOWN 13-N RANGE 16-W

WELL No. 1 (SERIAL No. 23) FARM Freedman & Strauss ACRES

NAME OF STREAM OR WATERS \_\_\_\_\_ QUADRANGLE NW $\frac{1}{4}$  - NW $\frac{1}{4}$

OPERATOR Adolph Anderson, Trustee MAP Otto Township, Oceana Co. 4" = 1 mile

500 Feet from North Line of Farm

\_\_\_\_\_ " " East " " "

\_\_\_\_\_ " " South " " "

500 " " West " " "

500 Feet from North Line of Section

\_\_\_\_\_ " " East " " "

\_\_\_\_\_ " " South " " "

500 " " West " " "

LEGEND

- LOCATION
- ① RIG
- ⊕ DRILLING
- ⊗ GAS WELL
- OIL WELL
- ⦿ SMALL OIL WELL
- ◇ DRY HOLE
- ◆ DRY SHOWING OIL
- ⊗ DRY SHOWING GAS
- ⊗ ABANDONED LOCATION
- ⊗ ABANDONED GAS WELL
- ⦿ ABANDONED OIL WELL

NOTE: Below make tracing from map, (when no map is obtainable make sketch) showing farm, center of section, this location with measurements and also wells, dry holes, or other locations in the vicinity of this location. Make copy to keep for reference and send original to Columbus office.

Elevation

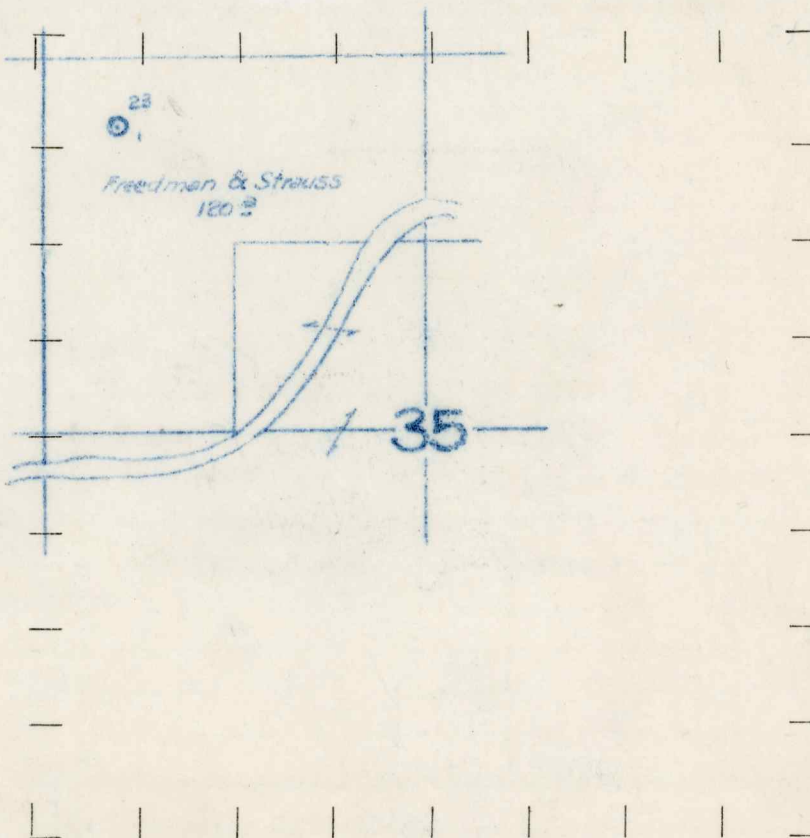

Permit #1172



REMARKS:

\_\_\_\_\_  
\_\_\_\_\_  
\_\_\_\_\_

SIGNED

\_\_\_\_\_  
Superintendent or Foreman.

THE PURE OIL COMPANY

Michigan Producing DIVISION

COMPLETION RECORD

No. 23

DATE 12/23/32

STATE Michigan COUNTY Oceana DIST. TWP. Otto SEC. 35 TOWN 13N RANGE 16W  
 PREC.

WELL No. 1 (SERIAL No. 23) FARM Freidman & Straus ACRES

NAME OF STREAM OR WATERS QUADRANGLE NW $\frac{1}{4}$ -NW $\frac{1}{4}$

OPERATOR Adolph Anderson, Trustee MAP Otto Twp. - Oceana Co.

LOCATION REPORT SENT IN (DATE) 6-27-31

WELL STARTED (DATE) 7-2-31 WELL COMPLETED (DATE) 12-21-32

OIL WELL
  GAS WELL
  DRY HOLE
  ABANDONED WELL

CROSS OUT THREE OF THE ABOVE

Elevation 625'

WELL RECORD

DATE OF SHOT NUMBER OF QUARTS

1st 24 HOURS PRODUCTION	BARRELS OR FEET
Dry Hole	" " "
" " "	" " "
" " "	" " "
" " "	" " "
" " "	" " "

SAND AND CASING

CASING SIZE	WEIGHT	CASING Feet Inches	SAND Name and Nature	TOP	BOTTOM	TOP PAY	BOTTOM PAY	SALT WATER
10"		310'	Drift	0	206			
			Red Rock	1017	1041			
			Traverse Formation	1853	1898			
			" Lime	1898				
			Dundee	2282				
			Total Depth		2342			

REMARKS Show oil, gas and water 1898-1905.  
 By L.H. Green dated 21 Jan 1950 10-24-31  $\phi$  1710 (corrected depth) —  
 10-31-31 shut down: Tr Fm 1853; Th 1898; 50 G & W 1898-1905 — 12-5-31  
 $\phi$  1965' — 2-6-32 shut down 1965; fishing job cleaned up — 2-20-32  
 $\phi$  1924 SLM previously reported 1965' — 2-26-32 fishing 1935'.

NOTE: MAKE COPY TO KEEP FOR REFERENCE AND SEND ORIGINAL TO CHICAGO OFFICE. LIST MATERIAL CHARGEABLE TO WELL ON OTHER SIDE.

SIGNED *GMBell* SUPT. OR FOREMAN