



Western Michigan University
ScholarWorks at WMU

Legacy Scout Tickets from Pure Oil Company

10-21-2021

MGRRE_PureOilScoutTickets_Ackerman_1_21127019060000

MGRRE

Western Michigan University

Follow this and additional works at: <https://scholarworks.wmich.edu/pure>



Part of the Geology Commons

WMU ScholarWorks Citation

MGRRE, "MGRRE_PureOilScoutTickets_Ackerman_1_21127019060000" (2021). *Legacy Scout Tickets from Pure Oil Company*. 10859.

<https://scholarworks.wmich.edu/pure/10859>

This Document is brought to you for free and open access via ScholarWorks at WMU. It has been accepted for inclusion in Legacy Scout Tickets from Pure Oil Company by an authorized administrator of ScholarWorks at WMU. See the National Digital Catalogue - Science Base Catalogue for more collections submitted by MGRRE.



MGRRE_PureOilScoutTickets_Ackerman_1_21127019060000

API 21127019060000

Permit Number 1906

Lease Name Ackerman

Well Number 1

County Oceana

Township 15N

Range 16W

Section 31

2021 DEQ or Pure co_name Nelson, H. C.

Pure Number 60

Latitude 43.65007

Longitude -86.2769

THE PURE OIL COMPANY

LOCATION REPORT

No. 60

DATE February 23, 1934

STATE Michigan COUNTY Oceana DIST. TWP. Elbridge SEC. 31 TOWN 15 N RANGE 16 W

WELL No. 1 (SERIAL No. 60) FARM Mrs. Cozy Ackerman ACRES

NAME OF STREAM OR WATERS QUADRANGLE NW-NW-SW

OPERATOR H. C. Nelson MAP Elbridge Township, Oceana County

210 Feet from North Line of Farm

East " " "

South " " "

250 West " " "

Feet from North Line of Section

East " " "

2430 South " " "

250 West " " "

LEGEND

- LOCATION
- ⊙ RIG
- ⊕ DRILLING
- ⊛ GAS WELL
- OIL WELL
- ⊖ SMALL OIL WELL
- ⊛ DRY HOLE
- ⊖ DRY SHOWING OIL
- ⊛ DRY SHOWING GAS
- ⊖ ABANDONED LOCATION
- ⊛ ABANDONED GAS WELL
- ⊖ ABANDONED OIL WELL

NOTE: Below make tracing from map, (when no map is obtainable make sketch) showing farm, center of section, this location with measurements and also wells, dry holes, or other locations in the vicinity of this location. Make copy to keep for reference and send original to Columbus office.

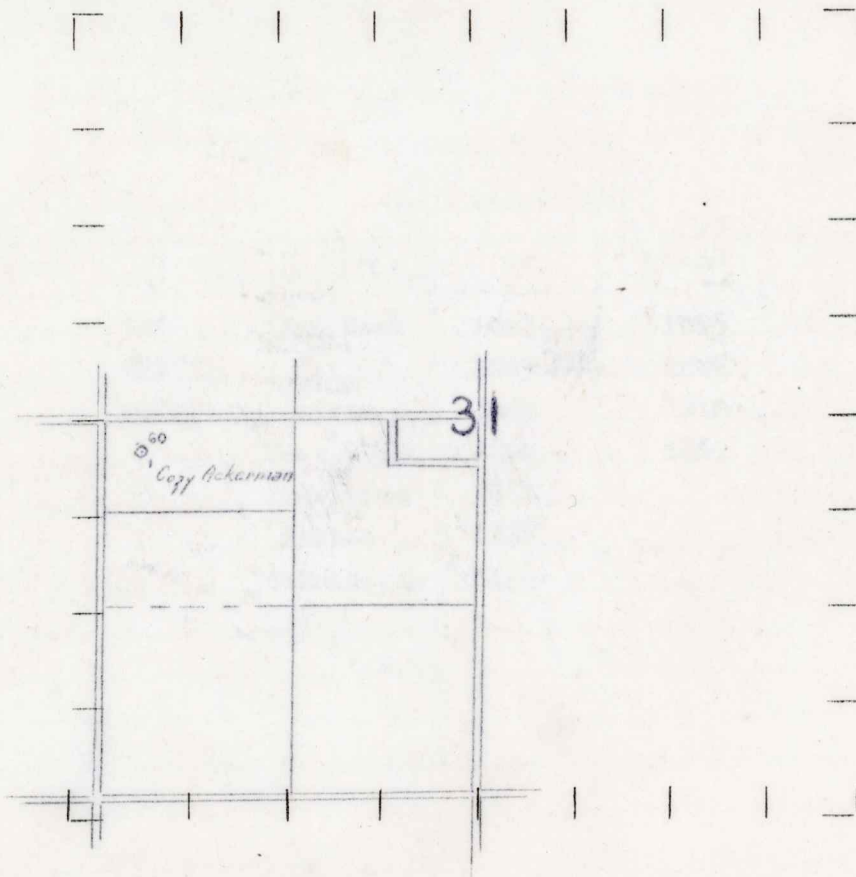

REMARKS:

SIGNED

R. L. Yeager
Superintendent or Foreman.

Form 243 10M 6-19-29 P100 POCO

THE PURE OIL COMPANY

Michigan Producing DIVISION
COMPLETION RECORD

DATE May 10, 1934

No. 60

STATE Michigan COUNTY Oceana DIST. TWP. Elbridge SEC. 31 TOWN 15 N RANGE 16 W
PREC.

WELL No. 1 (SERIAL No. 60) FARM Mrs. Cozy Ackerman ACRES _____

NAME OF STREAM OR WATERS _____ QUADRANGLE NW-NW-SW

OPERATOR H. C. Nelson MAP Elbridge Township, Oceana County

LOCATION REPORT SENT IN (DATE) 2/23/34

WELL STARTED (DATE) 2/28/34 WELL COMPLETED (DATE) 5/8/34

OIL WELLS

GAS WELLS

DRY HOLE

ABANDONED WELLS

Elevation 722.6'

CROSS OUT THREE OF THE ABOVE
WELL RECORD

DATE OF SHOT _____ NUMBER OF QUARTS _____

1st 24 HOURS PRODUCTION Dry Hole BARRELS OR FEET _____

2nd " " " _____ " " "

3rd " " " _____ " " "

4th " " " _____ " " "

5th " " " _____ " " "

SAND AND CASING

CASING SIZE	WEIGHT	CASING Feet Inches	SAND Name and Nature	TOP	BOTTOM	TOP PAY	BOTTOM PAY	SALT WATER
10"		397	Red Rock	1022	1026			
8 1/4"		527	" "	1045	1085			
6-5/8"		2382 1/2	Antrim	1655	1810			
			Trav. Form.	1810	1863			
			Trav. Lime	1863			H.F. 1905-1910	
			Dundee	2382			H.F. 2410	
			Total Depth	2410				

REMARKS _____

NOTE:—MAKE COPY TO KEEP FOR REFERENCE AND SEND ORIGINAL TO CHICAGO OFFICE. LIST MATERIAL CHARGEABLE TO WELL ON OTHER SIDE.

SIGNED S. N. Bell
SUPT. OR FOREMAN