



Western Michigan University  
ScholarWorks at WMU

---

Legacy Scout Tickets from Pure Oil Company

---

10-22-2021

**MGRRE\_PureOilScoutTickets\_Brinen\_1\_21127020080000**

MGRRE

*Western Michigan University*

Follow this and additional works at: <https://scholarworks.wmich.edu/pure>



Part of the Geology Commons

---

#### **WMU ScholarWorks Citation**

MGRRE, "MGRRE\_PureOilScoutTickets\_Brinen\_1\_21127020080000" (2021). *Legacy Scout Tickets from Pure Oil Company*. 10860.

<https://scholarworks.wmich.edu/pure/10860>

This Document is brought to you for free and open access via ScholarWorks at WMU. It has been accepted for inclusion in Legacy Scout Tickets from Pure Oil Company by an authorized administrator of ScholarWorks at WMU. See the National Digital Catalogue - Science Base Catalogue for more collections submitted by MGRRE.



---

**MGRRE\_PureOilScoutTickets\_Brinen\_1\_21127020080000**

API 21127020080000

Permit Number 2008

Lease Name Brinen

Well Number 1

County Oceana

Township 13N

Range 16W

Section 13

2021 DEQ or Pure co\_name Reed Oil Company

Pure Number 61

Latitude 43.52022

Longitude -86.178

THE PURE OIL COMPANY

LOCATION REPORT

No. 61

DATE May 10, 1934

STATE Michigan COUNTY Oceana DIST. Otto TWP. Otto SEC. 13 TOWN 13 N RANGE 16 W

WELL No. 1 (SERIAL No. 61) FARM Wm. J. Brinen ACRES

NAME OF STREAM OR WATERS QUADRANGLE SW-SW-NW

OPERATOR Reed Oil Company MAP Otto Township, Oceana County

Feet from North Line of Farm

East " " "

330 South " " "

330 West " " "

Feet from North Line of Section

East " " "

330 South " " "

330 West " " "

LEGEND

- LOCATION, RIG, DRILLING, GAS WELL, OIL WELL, SMALL OIL WELL, DRY HOLE, DRY SHOWING OIL, DRY SHOWING GAS, ABANDONED LOCATION, ABANDONED GAS WELL, ABANDONED OIL WELL

NOTE: Below make tracing from map, (when no map is obtainable make sketch) showing farm, center of section, this location with measurements and also wells, dry holes, or other locations in the vicinity of this location. Make copy to keep for reference and send original to Columbus office.

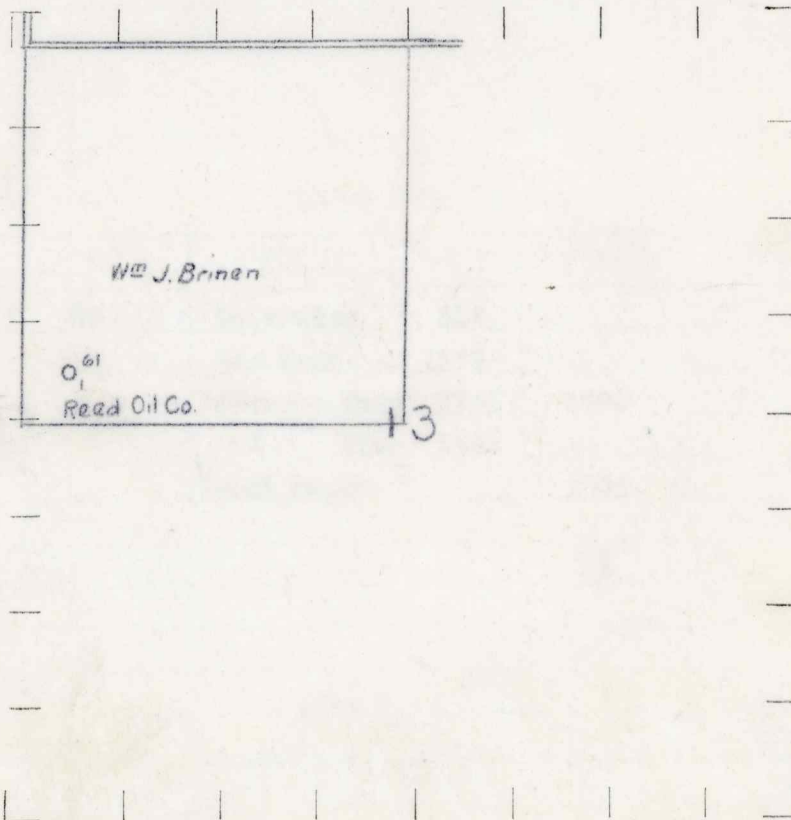

REMARKS:

SIGNED

Superintendent or Foreman.

Per. 2008

Form 243 10M 6-19-29 P100 POCO

THE PURE OIL COMPANY

Michigan Producing DIVISION

COMPLETION RECORD

No. 61

DATE June 14, 1934

STATE Michigan COUNTY Oceana DIST. TWP. Otto SEC. 13 TOWN 13N RANGE 16W

WELL No. 1 (SERIAL No. 61) FARM Wm. J. Brinen ACRES

NAME OF STREAM OR WATERS QUADRANGLE SW-SW-NW

OPERATOR Reed Oil Company MAP Otto Township, Oceana County

LOCATION REPORT SENT IN (DATE) 5/10/34

WELL STARTED (DATE) 5/10/34 WELL COMPLETED (DATE) 6/12/34

<input type="checkbox"/> OIL WELL	<input type="checkbox"/> GAS WELL	<input type="checkbox"/> DRY HOLE	<input type="checkbox"/> ABANDONED WELL
-----------------------------------	-----------------------------------	-----------------------------------	---

CROSS OUT THREE OF THE ABOVE WELL RECORD

Elevation 693.6'

DATE OF SHOT	NUMBER OF QUARTS	BARRELS OR FEET
1st 24 HOURS PRODUCTION	Dry Hole	
2nd " " "		" " "
3rd " " "		" " "
4th " " "		" " "
5th " " "		" " "

SAND AND CASING

CASING SIZE	WEIGHT	CASING Feet Inches	SAND Name and Nature	TOP	BOTTOM	TOP PAY	BOTTOM PAY	SALT WATER
10"		380	Coldwater	614				
8 1/2"		616	Red Rock	1177				
			Traverse Form. 1945		1996			
			" Lime	1996				1998-2000
			Total Depth		2000			

REMARKS

NOTE:—MAKE COPY TO KEEP FOR REFERENCE AND SEND ORIGINAL TO CHICAGO OFFICE. LIST MATERIAL CHARGEABLE TO WELL ON OTHER SIDE.

SIGNED D.H. Bell SUPT. OR FOREMAN