



Western Michigan University  
ScholarWorks at WMU

---

Legacy Scout Tickets from Pure Oil Company

---

11-15-2021

**MGRRE\_PureOilScoutTickets\_Kyncl, Jos &  
Marie\_1\_21127118890000**

MGRRE  
*Western Michigan University*

Follow this and additional works at: <https://scholarworks.wmich.edu/pure>



Part of the Geology Commons

---

#### **WMU ScholarWorks Citation**

MGRRE, "MGRRE\_PureOilScoutTickets\_Kyncl, Jos & Marie\_1\_21127118890000" (2021). *Legacy Scout Tickets from Pure Oil Company*. 10884.

<https://scholarworks.wmich.edu/pure/10884>

This Document is brought to you for free and open access via ScholarWorks at WMU. It has been accepted for inclusion in Legacy Scout Tickets from Pure Oil Company by an authorized administrator of ScholarWorks at WMU. See the National Digital Catalogue - Science Base Catalogue for more collections submitted by MGRRE.



---

**MGRRE\_PureOilScoutTickets\_Kyncl, Jos & Marie\_1\_21127118890000**

API 21127118890000

Permit Number 11889

Lease Name Kyncl, Jos & Marie

Well Number 1

County Oceana

Township 16N

Range 18W

Section 35

2021 DEQ or Pure co\_name Wagenaar, Neil

Pure Number 98

Latitude 43.73918

Longitude -86.4204

# THE PURE OIL COMPANY

## LOCATION REPORT

Date October 17, 1945

A.F.E. No. \_\_\_\_\_

Division Mich. Producing

District \_\_\_\_\_

Lease \_\_\_\_\_

*JOS. & MARIE KYNCL*  
Jos. & Marie Kyncl

Acres \_\_\_\_\_ Lease No. \_\_\_\_\_ Elevation \_\_\_\_\_ Well No. 1 (Serial No. 98)

Quadrangle NE-NE-SE Sec. 35 Twp. 16 N Rge. 18 W **ENX DISTC** Twp. PENTWATER  
NE NE SE

Survey \_\_\_\_\_ County OCEANA State Michigan

Operator Neil Wagenaar Map Pentwater Township, Oceana County

<u>330</u>	<u>330</u>	Feet from North Line of Lease				
<u>330</u>	<u>330</u>	" " East " " "				
		" " South " " "				
		" " West " " "				
<u>330</u>	<u>330</u>	Feet from North Line of Section				
<u>330</u>	<u>330</u>	" " East " " "				
		" " South " " "				
		" " West " " "				

### LEGEND

- Location
- ☀ Gas Well
- Oil Well
- ☀ Gas - Distillate Well
- ∅ or ○ Dry Hole
- Dry Showing Oil
- ☀ Dry Showing Gas
- ⊖ Abandoned Location
- ☀ or ☀ Abandoned Gas Well
- or ● Abandoned Oil Well
- or ○ Input Well

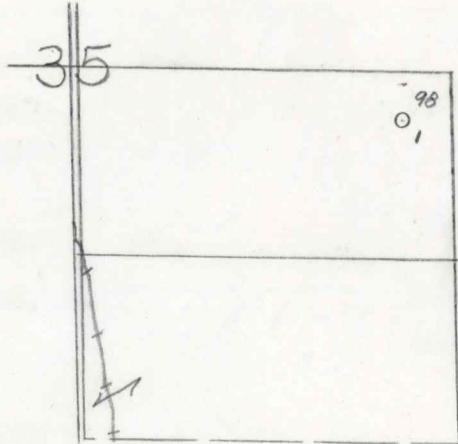

Scale \_\_\_\_\_

Remarks: \_\_\_\_\_  
\_\_\_\_\_  
\_\_\_\_\_

Submitted by \_\_\_\_\_  
Civil Engineer

Approved by \_\_\_\_\_  
Division Manager

Approved by \_\_\_\_\_  
Vice-President - General Manager

THE PURE OIL COMPANY

COMPLETION RECORD OF WELLS DRILLED BY OTHER OPERATORS

Michigan Producing Division

Date January 9, 1946 No. 98  
 State Mich. County Oceana ~~Sixt~~ Twp. Pentwater Sec. 35 Twp. 16 N Rge. 18 W  
 Well No. 1 (~~Serial No.~~) (Serial No.) 98 Farm J. & M. Kyncl Acres  
 Operator Neil Wagenaar Information secured ~~xxxx~~ By Scouting Department  
 Date well started 10-23-45 Date well completed 12-29-45 Elevation 642.6

PRODUCTION BOARD

1st 24 hours natural DRY HOLE  
 2nd 24 hours natural  
 Date of shot No. of quarts From To From to  
 Date of acid No. of gallons  
 1st 24 hours after acid shot  
 2nd 24 hours after acid shot

FORMATION AND CASING RECORD

Formation	Top	Bottom	Top Pay	Bottom Pay	Remarks	Casing	
						Size	Set at
Coldwater Lime	525	540	(+118)		H.F.W. 490-530.	10"	485
Coldw. Red Rock	<del>780</del> 775	785	(-137)		(+153)	8-1/4"	550
Antrim (light)	1275	(-632)				6-5/8" RH	1642
Antrim (dark)	1385	1580	SOM.	(-742)		5-3/16"	2105
Traverse Lime	1630	SOM.	(-987)		100 ft. S.W. 1658.	(-1015)	
Dundee	2138		(-1495)		Show salt water 2170.	(-1527)	
Detroit River	2190	(-1547)					
Sand (Sylvania?)	2660	2670	(-2017)				
Total Depth		3016	(-2373)				
<i>Traverse</i>	1580	(-937)					

Remarks No salt water encountered below 2170'.  
1632' equals 1642' SOM; 3012' equals 3016' SOM.

Signed D. C. Shackelford