



Western Michigan University
ScholarWorks at WMU

Legacy Scout Tickets from Pure Oil Company

8-20-2021

MGRRE_PureOilScoutTickets_Cooper, Frank_1_na

MGRRE

Western Michigan University

Follow this and additional works at: <https://scholarworks.wmich.edu/pure>



Part of the Geology Commons

WMU ScholarWorks Citation

MGRRE, "MGRRE_PureOilScoutTickets_Cooper, Frank_1_na" (2021). *Legacy Scout Tickets from Pure Oil Company*. 11000.

<https://scholarworks.wmich.edu/pure/11000>

This Document is brought to you for free and open access via ScholarWorks at WMU. It has been accepted for inclusion in Legacy Scout Tickets from Pure Oil Company by an authorized administrator of ScholarWorks at WMU. See the National Digital Catalogue - Science Base Catalogue for more collections submitted by MGRRE.



MGRRE_PureOilScoutTickets_Cooper, Frank_1_na

API na

Permit Number na

Lease Name Cooper, Frank

Well Number 1

County Cass

Township 7S

Range 13W

Section 29

2021 DEQ or Pure co_name Scott Stamler

Pure Number 14

Latitude 41.8311803

Longitude -85.8473339

THE PURE OIL COMPANY

LOCATION REPORT

No. 14

DATE 5-12-33STATE Michigan COUNTY Cass DIST. Penn TWP. Penn SEC. 6 TOWN 6S RANGE 14WWELL No. 1 (SERIAL No. 14) FARM Frank Cooper PREC. 56 ACRESNAME OF STREAM OR WATERS _____ QUADRANGLE N.E. - 27E - 77EOPERATOR Scott Stammer MAP __________360____ Feet from North Line of Farm_____385____ " " East " " "_____385____ " " South " " "_____385____ " " West " " "_____360____ Feet from North Line of Section_____385____ " " East " " "_____385____ " " South " " "_____385____ " " West " " "LEGEND

○ LOCATION

① RIG

② DRILLING

⊗ GAS WELL

● OIL WELL

⬮ SMALL OIL WELL

⬮ DRY HOLE

⬮ DRY SHOWING OIL

⬮ DRY SHOWING GAS

⬮ ABANDONED LOCATION

⬮ ABANDONED GAS WELL

⬮ ABANDONED OIL WELL

NOTE: Below make tracing from map, (when no map is obtainable make sketch) showing farm, center of section, this location with measurements and also wells, dry holes, or other locations in the vicinity of this location. Make copy to keep for reference and send original to Columbus office.

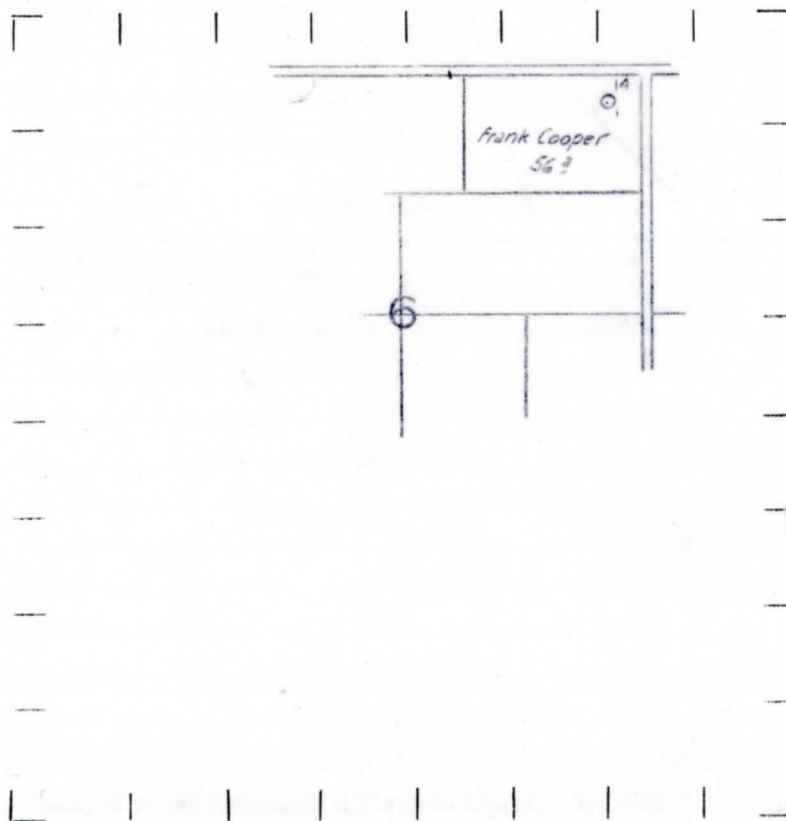

REMARKS:

SIGNED

Superintendent or Foreman.

Michigan Producing DIVISION COMPLETION RECORD

No. 14

NAME OF STREAM OR WATERS _____ QUADRANGLE _____

OPERATOR Scott Stambler MAP Penn Township, Cass County

LOCATION REPORT SENT IN (DATE) 5-19-33

WELL STARTED (DATE) 5-19-33 WELL COMPLETED (DATE) 9-27-33

XXXXXXXXXXXXXXXXXXXX

CROSS OUT THREE OF THE ABOVE
WELL RECORD

DATE OF SHOT _____ NUMBER OF QUARTS _____

1st 24 HOURS PRODUCTION	Dry Hole		BARRELS OR FEET
-------------------------	----------	--	-----------------

[illegible][illegible][illegible][illegible]

SAND AND CASING

[illegible]

REMARKS	Location abandoned after drilling to 352'
---------	---

SIGNED

SUPT. OR FOREMAN