



Western Michigan University
ScholarWorks at WMU

Legacy Scout Tickets from Pure Oil Company

8-20-2021

MGRRE_PureOilScoutTickets_Gebhard,
Henry_1_21027042620000

MGRRE
Western Michigan University

Follow this and additional works at: <https://scholarworks.wmich.edu/pure>



Part of the Geology Commons

WMU ScholarWorks Citation

MGRRE, "MGRRE_PureOilScoutTickets_Gebhard, Henry_1_21027042620000" (2021). *Legacy Scout Tickets from Pure Oil Company*. 11003.
<https://scholarworks.wmich.edu/pure/11003>

This Document is brought to you for free and open access via ScholarWorks at WMU. It has been accepted for inclusion in Legacy Scout Tickets from Pure Oil Company by an authorized administrator of ScholarWorks at WMU. See the National Digital Catalogue - Science Base Catalogue for more collections submitted by MGRRE.



MGRRE_PureOilScoutTickets_Gebhard, Henry_1_21027042620000

API 21027042620000

Permit Number 4262

Lease Name Gebhard, Henry

Well Number 1

County Cass

Township 05S

Range 15W

Section 34

2021 DEQ or Pure co_name Wayne Oil and Gas Company

Pure Number 17

Latitude 41.98633

Longitude -86.03129

THE PURE OIL COMPANY
LOCATION REPORT

DATE June 24, 1937

No. 17

STATE Michigan COUNTY Cass DIST. Wayne SEC. 34 TOWN 5 S RANGE 15 W

WELL No. 1 (SERIAL No. 17) FARM Henry Gebhard ACRES

NAME OF STREAM OR WATERS QUADRANGLE NE SE SE

OPERATOR Wayne Oil & Gas Company Map Wayne Township, Cass County
Wayne Oil & Gas Co. *Wayne Twp - Cass Co.*

Feet from North Line of Farm
330 330 " " East " " "
990 990 " " South " " "
" " West " " "

Feet from North Line of Section
330 330 " " East " " "
990 990 " " South " " "
" " West " " "

LEGEND

- LOCATION
- ① RIG
- ⊕ DRILLING
- ☀ GAS WELL
- OIL WELL
- ⬮ SMALL OIL WELL
- ⊙ DRY HOLE
- ⬮ DRY SHOWING OIL
- ⊙ DRY SHOWING GAS
- ⊙ ABANDONED LOCATION
- ☀ ABANDONED GAS WELL
- ⬮ ABANDONED OIL WELL

NOTE: Below make tracing from map, (when no map is obtainable make sketch) showing farm, center of section, this location with measurements and also wells, dry holes, or other locations in the vicinity of this location.

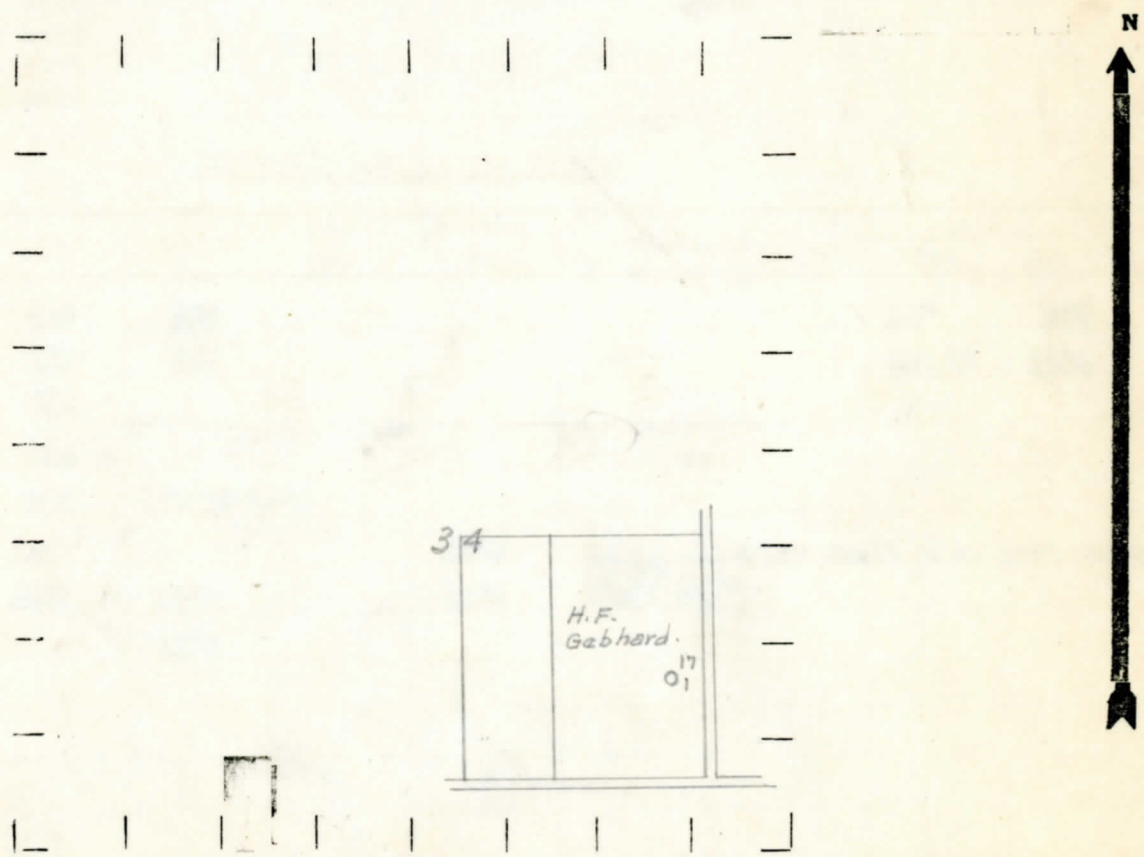

REMARKS:

SIGNED

Superintendent or Foreman.

Michigan Producing Division

No. 17

Well No. **1** (Serial No.) **17** Farm **Henry Gobhard** Acres

Operator **Wayne Oil & Gas Company** Information secured ^{by} ~~Source~~ **Scouting Department**

Date well started 6-18-37 Date well completed 11-23-37 Elevation 884.3

1st 24 hours natural **Dry Hole**

2nd 24 hours natural

	No. of						
Date of shot	quarts	From	to	From	to		

[illegible]

shot
1st 24 hours after acid

shot

2nd 24 hours after acid

Formation	Top	Bottom	Top Pay	Bottom Pay	Remarks	Casing	
						Size	Set
Coldwater							
Red Rock	442	452				10"	386
Borea	452	467				6-5/8"	1164
Antrim	812						
Traverse Form.	934						
Traverse Lime	974	(Corrected)					
Monroe	1121			1045	Small oil-also small show salt water in 36 hrs.		
Sylvania	1266	1276		1274	H.F.S.W.		
Total Depth		1276					

Remarks Small show oil 1074-1076-show sulphur water 1101-1106 - increase in sulphur water from 1132-1136-filled up 500 ft. in 12 hrs.-increase in water from 1142-1146-filled up 1100 ft.-very small show oil from 1241-1243.

Signed D. C. Shackelford