



Western Michigan University  
ScholarWorks at WMU

---

Legacy Scout Tickets from Pure Oil Company

---

8-20-2021

**MGRRE\_PureOilScoutTickets\_Feirek\_1\_21027060230000**

MGRRE

*Western Michigan University*

Follow this and additional works at: <https://scholarworks.wmich.edu/pure>



Part of the Geology Commons

---

#### WMU ScholarWorks Citation

MGRRE, "MGRRE\_PureOilScoutTickets\_Feirek\_1\_21027060230000" (2021). *Legacy Scout Tickets from Pure Oil Company*. 11008.

<https://scholarworks.wmich.edu/pure/11008>

This Document is brought to you for free and open access via ScholarWorks at WMU. It has been accepted for inclusion in Legacy Scout Tickets from Pure Oil Company by an authorized administrator of ScholarWorks at WMU. See the National Digital Catalogue - Science Base Catalogue for more collections submitted by MGRRE.



---

## MGRRE\_PureOilScoutTickets\_Feirek\_1\_21027060230000

API 21027060230000

Permit Number 6023

Lease Name Feirek

Well Number 1

County Cass

Township 07S

Range 14W

Section 9

2021 DEQ or Pure co\_name Dodd, N R

Pure Number 22

Latitude 41.87649

Longitude -85.94713

THE PURE OIL COMPANY

DATE May 18, 1939

COMPLETION RECORD OF WELLS DRILLED BY OTHER OPERATORS

LOCATION REPORT

No. 22STATE MichiganCOUNTY CassTWP. CalvinSEC. 99TOWN 7 SRANGE 14 WWELL No. 11 (SERIAL No. 22) FARMPREC. H. & S. Feirek

ACRES

NAME OF STREAM OR WATERS

QUADRANGLE SW-SE-NWOPERATOR N. R. Dodd

Map

Calvin Township, Cass County

Feet from North Line of Farm

9990

" " East " " "

3330

" " South " " "

" " West " " "

Feet from North Line of Section

9990" " East " " 1/43330" " South " " 1/4

" " West " " "

## LEGEND

○ LOCATION

① RIG

⊕ DRILLING

☼ GAS WELL

● OIL WELL

⦿ SMALL OIL WELL

⊙ DRY HOLE

⦿ DRY SHOWING OIL

⊙ DRY SHOWING GAS

⦿ ABANDONED LOCATION

☼ ABANDONED GAS WELL

⦿ ABANDONED OIL WELL

NOTE: Below make tracing from map, (when no map is obtainable make sketch) showing farm, center of section, this location with measurements and also wells, dry holes, or other locations in the vicinity of this location.

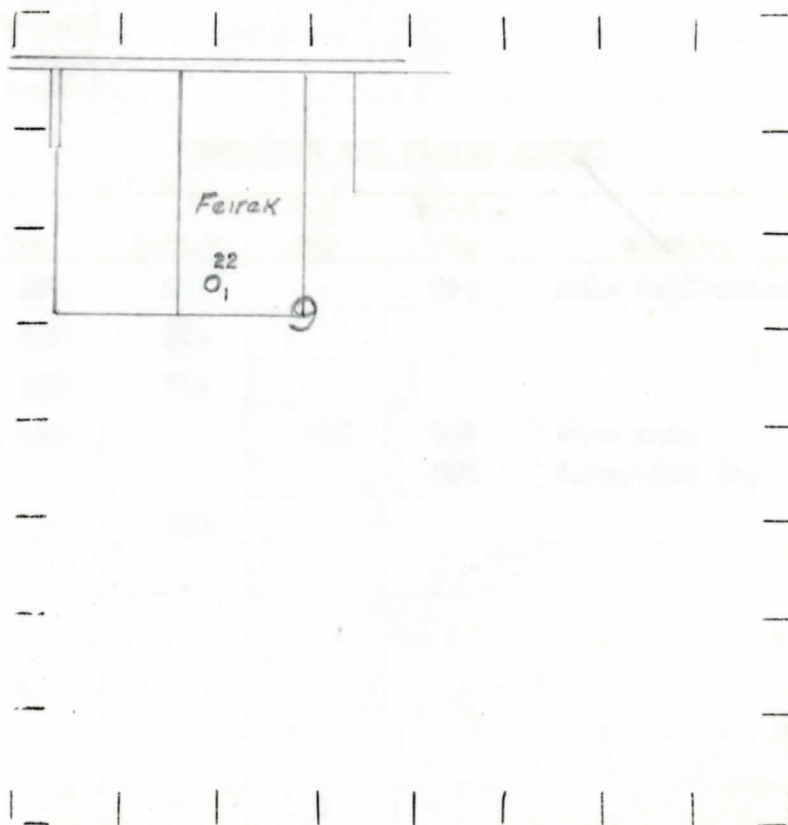

REMARKS:

SIGNED

Superintendent or Foreman.

## Michigan Producing Division

Date June 29, 1939 No. 22

State Mich. County Cass Twp. Calvin Sec. 9 Twp. 7 S Rge. 14 W

Well No. 1 (Serial No.) 22 Farm H. & S. Peirek Acres

Operator W. R. Dodd By Scouting Department

Date well started 5-31-39 Dated well completed 6-20-39 Elevation 838.5

# PRODUCTION RECORD

Dry Hole				
1st 24 hours natural				
2nd 24 hours natural				
Date of shot	No. of quarts	From	to	From to
Date of acid	No. of gallons			
1st 24 hours after acid	shot			
2nd 24 hours after acid	shot			

## FORMATION AND CASING RECORD

[illegible]

Remarks

Signed

D. C. Shackelford