



Western Michigan University
ScholarWorks at WMU

Legacy Scout Tickets from Pure Oil Company

8-20-2021

**MGRRE_PureOilScoutTickets_Simpson, Lewis M. & Rea
J._1_21027062210000**

MGRRE
Western Michigan University

Follow this and additional works at: <https://scholarworks.wmich.edu/pure>



Part of the Geology Commons

WMU ScholarWorks Citation

MGRRE, "MGRRE_PureOilScoutTickets_Simpson, Lewis M. & Rea J._1_21027062210000" (2021). *Legacy Scout Tickets from Pure Oil Company*. 11009.
<https://scholarworks.wmich.edu/pure/11009>

This Document is brought to you for free and open access via ScholarWorks at WMU. It has been accepted for inclusion in Legacy Scout Tickets from Pure Oil Company by an authorized administrator of ScholarWorks at WMU. See the National Digital Catalogue - Science Base Catalogue for more collections submitted by MGRRE.



MGRRE_PureOilScoutTickets_Simpson, Lewis M. & Rea J._1_21027062210000

API 21027062210000

Permit Number 6221

Lease Name Simpson, Lewis M. & Rea J.

Well Number 1

County Cass

Township 07S

Range 13W

Section 20

2021 DEQ or Pure co_name Shimmel, Lester A. Trustee

Pure Number 23

Latitude 41.8393

Longitude -85.85328

THE PURE OIL COMPANY

COMPLETION RECORD OF WELLS DRILLED BY OTHER OPERATORS
LOCATION REPORTDATE May 25, 1939No. 23STATE Michigan COUNTY Cass DIST. Porter TWP. Porter North SEC. 20 TOWN 7 S RANGE 13 W
WELL No. 1 (SERIAL No. 23) FARM L. M. Simpson ACRES

NAME OF STREAM OR WATERS

OPERATOR L. A. Shimmel, Tr.

Map

North
Porter Township, Cass County
Porter - CassQUADRANGLE SE SW SW

Feet from North Line of Farm

330 330 " " East " " "

" " South " " "

" " West " " "

Feet from North Line of Section

" " East " " "

330 330 " " South " " "990 990 " " West " " "

LEGEND

○ LOCATION

① RIG

⊕ DRILLING

☀ GAS WELL

● OIL WELL

● SMALL OIL WELL

⊙ DRY HOLE

⊙ DRY SHOWING OIL

⊙ DRY SHOWING GAS

⊙ ABANDONED LOCATION

⊙ ABANDONED GAS WELL

⊙ ABANDONED OIL WELL

NOTE: Below make tracing from map, (when no map is obtainable make sketch) showing farm, center of section, this location with measurements and also wells, dry holes, or other locations in the vicinity of this location.

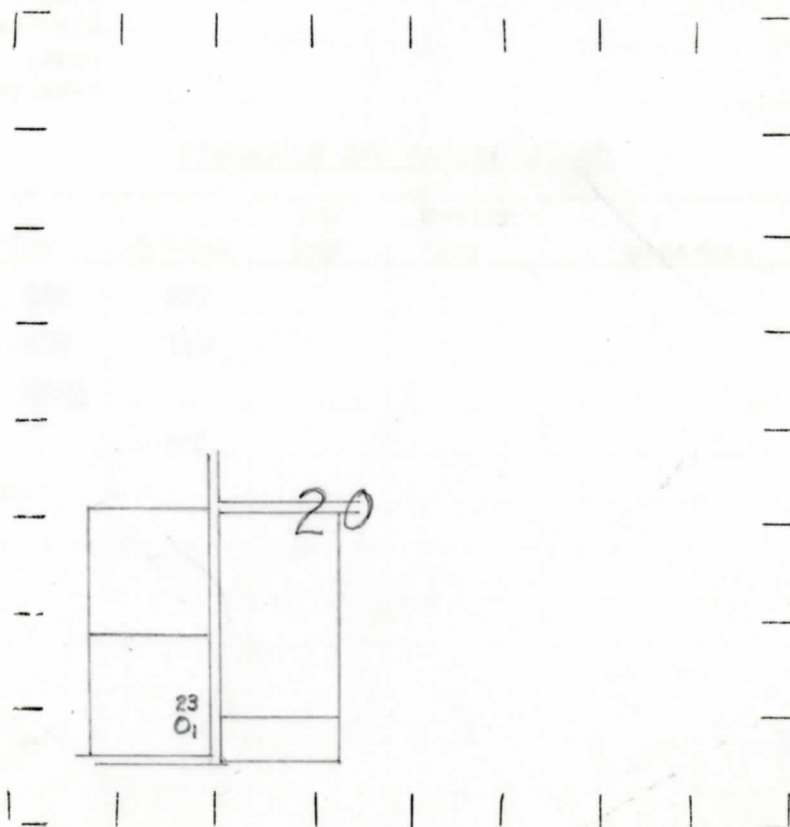

REMARKS:

SIGNED

Superintendent or Foreman.

Michigan Producing , Division

Date August 10, 1939

No. 23

State Mich. County Cass Twp. North Porter Sec. 20 Twp. 7 S Rge. 13 W
(Serial No.)
Well No. 1 (~~County No.~~) 23 Farm Lewis M. Simpson Acres

Operator **Lester A. Shimmel, Trustee** By **Scouting Department**
Information secured ~~from~~

Date well started **7-18-39** Dated well completed **8-2-39** Elevation **884.1**

PRODUCTION RECORD

1st 24 hours natural	Dry Hole
----------------------	-----------------

2nd 24 hours natural

[illegible][illegible]

shot
1st 24 hours after acid

shot

2nd 24 hours after acid

FORMATION AND CASING RECORD

[illegible]

Remarks:

Signed D. C. Shackelford