



Western Michigan University  
ScholarWorks at WMU

---

Legacy Scout Tickets from Pure Oil Company

---

8-20-2021

**MGRRE\_PureOilScoutTickets\_Flynn, Lee\_1\_21027067370000**

MGRRE

*Western Michigan University*

Follow this and additional works at: <https://scholarworks.wmich.edu/pure>



Part of the Geology Commons

---

#### **WMU ScholarWorks Citation**

MGRRE, "MGRRE\_PureOilScoutTickets\_Flynn, Lee\_1\_21027067370000" (2021). *Legacy Scout Tickets from Pure Oil Company*. 11011.

<https://scholarworks.wmich.edu/pure/11011>

This Document is brought to you for free and open access via ScholarWorks at WMU. It has been accepted for inclusion in Legacy Scout Tickets from Pure Oil Company by an authorized administrator of ScholarWorks at WMU. See the National Digital Catalogue - Science Base Catalogue for more collections submitted by MGRRE.



---

**MGRRE\_PureOilScoutTickets\_Flynn, Lee\_1\_21027067370000**

API 21027067370000

Permit Number 6737

Lease Name Flynn, Lee

Well Number 1

County Cass

Township 05S

Range 16W

Section 23

2021 DEQ or Pure co\_name Silver Creek Oil Company

Pure Number 25

Latitude 42.02275

Longitude -86.14504

## THE PURE OIL COMPANY

DATE August 31, 1940

## LOCATION REPORT

No. 25STATE Michigan COUNTY Cass ~~DISP~~ TWP. Silver Creek SEC. 23 TOWN 5 S RANGE 16 W  
~~PREC~~ WELL No. 1 (SERIAL No. 25) FARM Lee Flynn ACRESNAME OF STREAM OR WATERS \_\_\_\_\_ QUADRANGLE NW SW NW  
OPERATOR Silver Creek Oil Company Map Silver Creek Township, Cass County

Feet from North Line of Farm

" " East " " "

" " South " " "

" " West " " "

Feet from North Line of Section

" " East " " "

" " South " " "

" " West " " "

## LEGEND

○ LOCATION

① RIG

⊕ DRILLING

☼ GAS WELL

● OIL WELL

⬮ SMALL OIL WELL

⊙ DRY HOLE

⬮ DRY SHOWING OIL

⊙ DRY SHOWING GAS

⊙ ABANDONED LOCATION

☼ ABANDONED GAS WELL

⬮ ABANDONED OIL WELL

NOTE: Below make tracing from map, (when no map is obtainable make sketch) showing farm, center of section, this location with measurements and also wells, dry holes, or other locations in the vicinity of this location.

Plugged and abandoned 3-12-40.

N

REMARKS:

SIGNED

Superintendent or Foreman.

DATE September 14, 1939

LOCATION RECORD

No. 25

THE PURE OIL COMPANY

LOCATION REPORT

DATE September 14, 1939

STATE Michigan COUNTY Cass DIST. Silver Creek SEC. 23 TOWN 5 S RANGE 16 W

WELL No. 1 (SERIAL No. 25) FARM Lee Flynn ACRES

NAME OF STREAM OR WATERS QUADRANGLE NW SW NW

OPERATOR Silver Creek Oil Company Map Silver Creek Township, Cass County

Feet from North Line of Farm

" " East " " "

990 " " South " " "

330 " " West " " "

Feet from North Line of Section

" " East " " "

990 " " South " 1/4 "

330 " " West " " "

LEGEND

○ LOCATION

⊕ RIG

⊕ DRILLING

⊕ GAS WELL

● OIL WELL

● SMALL OIL WELL

⊕ DRY HOLE

⊕ DRY SHOWING OIL

⊕ DRY SHOWING GAS

⊕ ABANDONED LOCATION

⊕ ABANDONED GAS WELL

⊕ ABANDONED OIL WELL

NOTE: Below make tracing from map. (when no map is obtainable make sketch) showing farm, center of section, this location with measurements and also wells, dry holes, or other locations in the vicinity of this location.

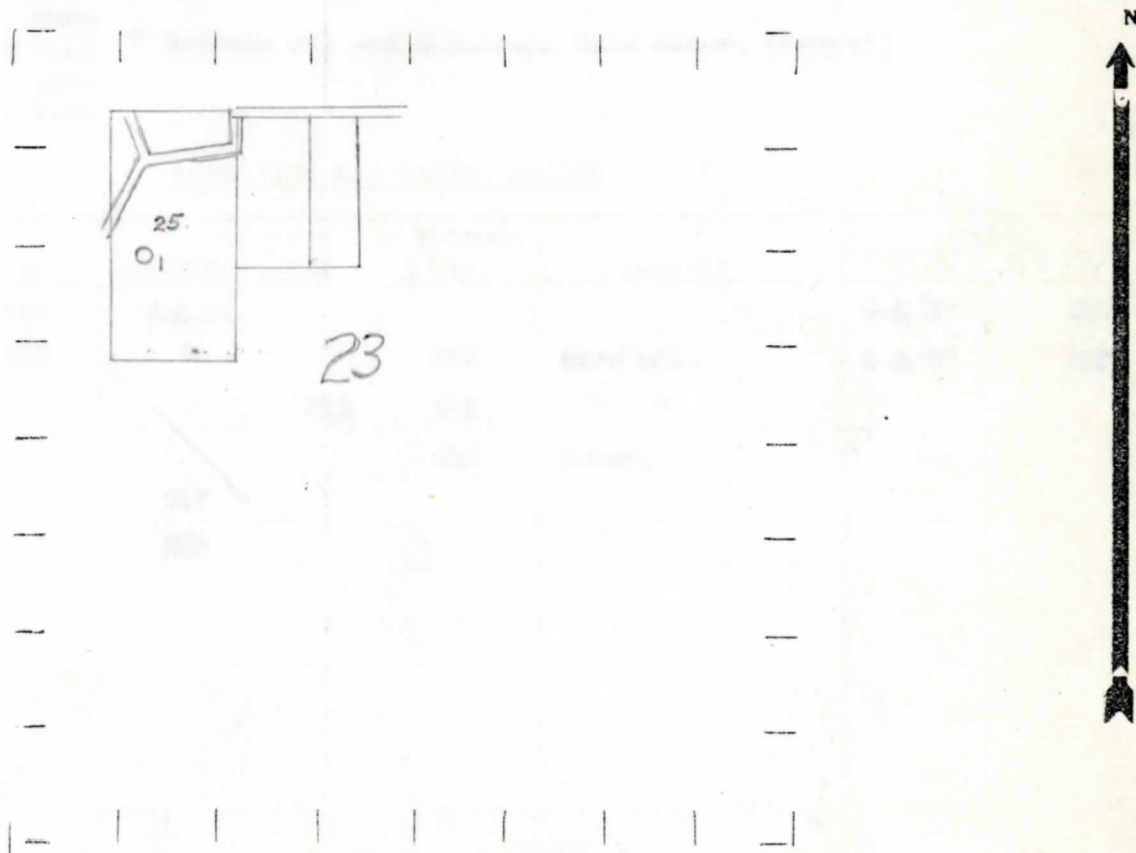

REMARKS:

SIGNED

Superintendent or Foreman.



DATE SEPTEMBER 15, 1960

No. 25

Operator **Silver Creek Oil Company** Information secured ~~xxxx~~ **By Scouting Department**

Date well started **9-16-39** Dated well completed **10-28-39** Elevation **738.9**

# PRODUCTION RECORD

2nd 24 hours natural

Date of acid **11-9-39** No. of gallons **1000**

shot

2nd 24 hours after acid

### FORMATION AND CASING RECORD

[illegible]

Remarks

Signed D. C. Shackelford