



Western Michigan University
ScholarWorks at WMU

Legacy Scout Tickets from Pure Oil Company

8-20-2021

**MGRRE_PureOilScoutTickets_Kujawski,
Steve_1_21027067390000**

MGRRE
Western Michigan University

Follow this and additional works at: <https://scholarworks.wmich.edu/pure>



Part of the Geology Commons

WMU ScholarWorks Citation

MGRRE, "MGRRE_PureOilScoutTickets_Kujawski, Steve_1_21027067390000" (2021). *Legacy Scout Tickets from Pure Oil Company*. 11012.
<https://scholarworks.wmich.edu/pure/11012>

This Document is brought to you for free and open access via ScholarWorks at WMU. It has been accepted for inclusion in Legacy Scout Tickets from Pure Oil Company by an authorized administrator of ScholarWorks at WMU. See the National Digital Catalogue - Science Base Catalogue for more collections submitted by MGRRE.



MGRRE_PureOilScoutTickets_Kujawski, Steve_1_21027067390000

API 21027067390000

Permit Number 6739

Lease Name Kujawski, Steve

Well Number 1

County Cass

Township 08S

Range 14W

Section 21

2021 DEQ or Pure co_name Tamblyn, R. B. Development Company

Pure Number 26

Latitude 41.76079

Longitude -85.94455

THE PURE OIL COMPANY

DATE September 14, 1939

LOCATION REPORT

No. 26STATE MichiganCOUNTY CassTWP. MasonSEC. 21TOWN 8 SRANGE 14 WWELL No. 1 (SERIAL No. 26) FARMSteve Kujawski

ACRES

NAME OF STREAM OR WATERS

QUADRANGLE SW SW NEOPERATOR R. B. Tamblin Development Company

Map

Mason-Township, Cass County

Feet from North Line of Farm

" " East " " "

" " South " " "

" " West " " "

Feet from North Line of Section

" " East " " "

" " South " " $\frac{1}{4}$ " " West " " $\frac{1}{4}$

LEGEND

○ LOCATION

① RIG

⊕ DRILLING

☼ GAS WELL

● OIL WELL

⦿ SMALL OIL WELL

⊙ DRY HOLE

⦿ DRY SHOWING OIL

⦿ DRY SHOWING GAS

⦿ ABANDONED LOCATION

⦿ ABANDONED GAS WELL

⦿ ABANDONED OIL WELL

NOTE: Below make tracing from map, (when no map is obtainable make sketch) showing farm, center of section, this location with measurements and also wells, dry holes, or other locations in the vicinity of this location.

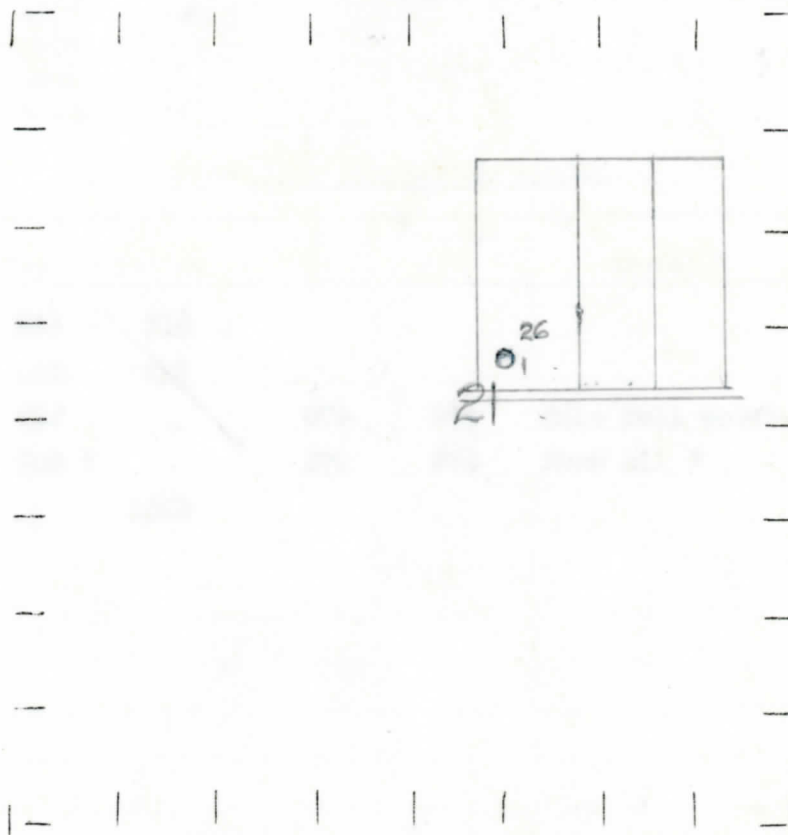

REMARKS:

SIGNED

Superintendent or Foreman.

D. C. Shackelford