



Western Michigan University
ScholarWorks at WMU

Legacy Scout Tickets from Pure Oil Company

8-20-2021

**MGRRE_PureOilScoutTickets_Woolverton, John
J._1_21027079170000**

MGRRE
Western Michigan University

Follow this and additional works at: <https://scholarworks.wmich.edu/pure>



Part of the Geology Commons

WMU ScholarWorks Citation

MGRRE, "MGRRE_PureOilScoutTickets_Woolverton, John J._1_21027079170000" (2021). *Legacy Scout Tickets from Pure Oil Company*. 11020.
<https://scholarworks.wmich.edu/pure/11020>

This Document is brought to you for free and open access via ScholarWorks at WMU. It has been accepted for inclusion in Legacy Scout Tickets from Pure Oil Company by an authorized administrator of ScholarWorks at WMU. See the National Digital Catalogue - Science Base Catalogue for more collections submitted by MGRRE.



MGRRE_PureOilScoutTickets_Woolverton, John J._1_21027079170000

API 21027079170000

Permit Number 7917

Lease Name Woolverton, John J.

Well Number 1

County Cass

Township 08S

Range 15W

Section 22

2021 DEQ or Pure co_name Tamblyn, R. B. Development Company

Pure Number 34

Latitude 41.76451

Longitude -86.03632

THE PURE OIL COMPANY

DATE 10-1-41 28, 1940 *Corrected*

LOCATION REPORT

No. 34STATE Michigan COUNTY Cass ~~DISCK~~ TWP. Ontwa SEC. 22 TOWN 8 S RANGE 15 W
~~PREC.~~ WELL No. 1 (SERIAL No. 34) FARM Woolverton ACRESNAME OF STREAM OR WATERS _____ QUADRANGLE SE NW NEOPERATOR R. B. Tambllyn Development Company Map Ontwa Township, Cass County_____
Feet from North Line of Farm_____
" " East " " "_____
" " South " " "_____
" " West " " "_____
Feet from North Line of Section_____
" " East " " "_____
" " South " " "_____
" " West " " "

LEGEND

○ LOCATION

① RIG

⊕ DRILLING

⊗ GAS WELL

● OIL WELL

⬮ SMALL OIL WELL

⊙ DRY HOLE

⬮ DRY SHOWING OIL

⊙ DRY SHOWING GAS

⊙ ABANDONED LOCATION

⬮ ABANDONED GAS WELL

⬮ ABANDONED OIL WELL

NOTE: Below make tracing from map. (when no map is obtainable make sketch) showing farm, center of section, this location with measurements and also wells, dry holes, or other locations in the vicinity of this location.

Plugged and abandoned 2-25-41.

Total Depth 673' ?

REMARKS:

SIGNED

Superintendent or Foreman.

OBSERVATION R. B. Tamblin Development Co. WAB Ontwa Township, Cass County
 NAME OF SURVEYOR OR MEASURER LOCATION REPORT CLAYTONVILLE SE 1/4 NE
 WELL No. 1 (SERIAL No. 34) WAB MOOTASLOH 22 TOWN 3 S RANGE 15 E VCRES
 STATE MO COUNTY WAB Woolverton
 WELL No. 1 (SERIAL No. 34) FARM Woolverton ACRES SE NW NE
 NAME OF STREAM OR WATERS QUADRANGLE

OPERATOR R. B. Tamblin Development Co. Map Ontwa Township, Cass County
990 990 R.B. Tamblin Dev. Co. Ontwa Cass
 Feet from North Line of Farm

1650 1650 " " East " " "
 " " South " " "
 " " West " " "
 990 990 Feet from North Line of Section

" " East " " "
 " " South " " "
 " " West " " "
 990 990 Feet from North Line of Section

" " East " " "
 " " South " " "
 " " West " " "
 990 990 Feet from North Line of Section

" " East " " "
 " " South " " "
 " " West " " "
 990 990 Feet from North Line of Section

LEGEND

- LOCATION
- ① RIG
- ⊕ DRILLING
- ☼ GAS WELL
- OIL WELL
- ◆ SMALL OIL WELL

- ⊙ DRY HOLE
- ◆ DRY SHOWING OIL
- ☼ DRY SHOWING GAS
- ⊙ ABANDONED LOCATION
- ☼ ABANDONED GAS WELL
- ◆ ABANDONED OIL WELL

NOTE: Below make tracing from map. (when no map is obtainable make sketch) showing farm, center of section, this location with measurements and also wells, dry holes, or other locations in the vicinity of this location.

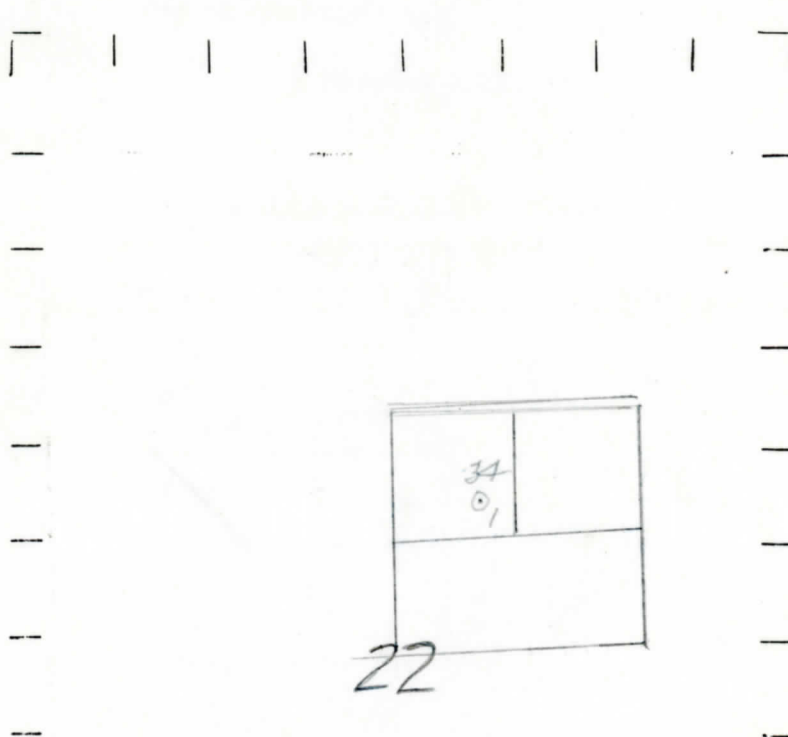

REMARKS: Correcting location. Correcting location

SIGNED

W

Superintendent or Foreman.

NAME OF SURVEYOR OR ADVISOR
NAME OF SURVEYOR OR ADVISOR
WELL No. 1 (SERIAL No. 34) FARM
STATE Michigan COUNTY Cass TWP. Ontwa SEC. 22 TOWN 8 S RANGE 15 W
WELL No. 1 (SERIAL No. 34) FARM John J. Woolverton ACRES

NAME OF STREAM OR WATERS QUADRANGLE SE NE NE

OPERATOR R. B. Tambllyn Development Company Map Ontwa Township, Cass County

990 990 Feet from North Line of Farm

330 330 " " East " " "

" " South " " "

" " West " " "

990 990 Feet from North Line of Section

330 330 " " East " " "

" " South " " "

" " West " " "

LEGEND

○ LOCATION

① RIG

⊕ DRILLING

☼ GAS WELL

● OIL WELL

◆ SMALL OIL WELL

⊙ DRY HOLE

◆ DRY SHOWING OIL

⊙ DRY SHOWING GAS

⊙ ABANDONED LOCATION

☼ ABANDONED GAS WELL

◆ ABANDONED OIL WELL

NOTE: Below make tracing from map. (when no map is obtainable make sketch) showing farm, center of section, this location with measurements and also wells, dry holes, or other locations in the vicinity of this location.

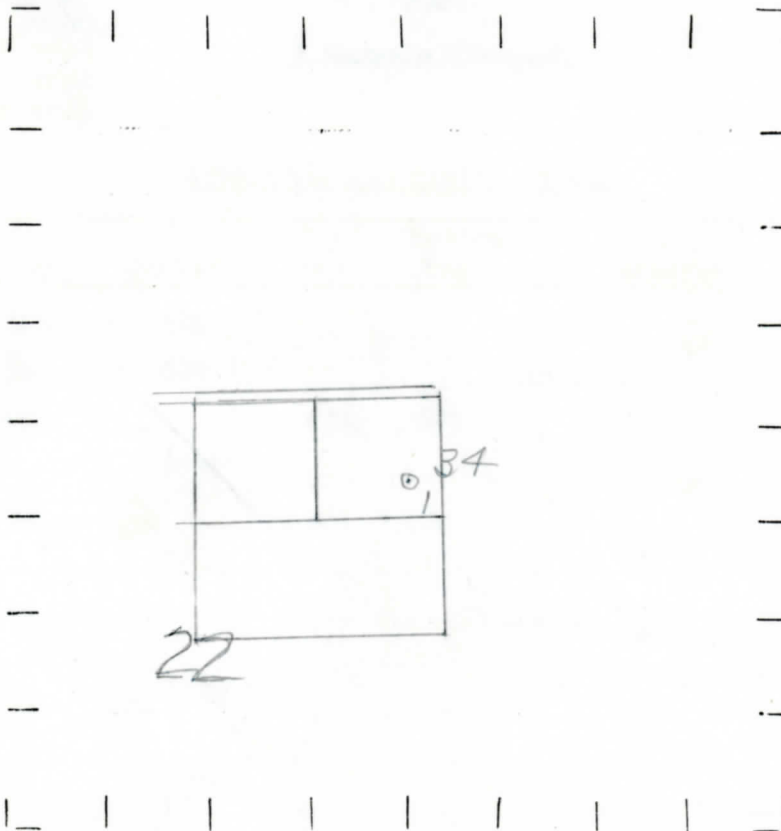

REMARKS:

SIGNED

Superintendent or Foreman.

Signed D. C. Shackelford