



Western Michigan University  
ScholarWorks at WMU

---

Legacy Scout Tickets from Pure Oil Company

---

8-20-2021

**MGRRE\_PureOilScoutTickets\_Waage, Olle\_1\_21027079440000**

MGRRE

*Western Michigan University*

Follow this and additional works at: <https://scholarworks.wmich.edu/pure>



Part of the Geology Commons

---

#### WMU ScholarWorks Citation

MGRRE, "MGRRE\_PureOilScoutTickets\_Waage, Olle\_1\_21027079440000" (2021). *Legacy Scout Tickets from Pure Oil Company*. 11022.

<https://scholarworks.wmich.edu/pure/11022>

This Document is brought to you for free and open access via ScholarWorks at WMU. It has been accepted for inclusion in Legacy Scout Tickets from Pure Oil Company by an authorized administrator of ScholarWorks at WMU. See the National Digital Catalogue - Science Base Catalogue for more collections submitted by MGRRE.



---

**MGRRE\_PureOilScoutTickets\_Waage, Olle\_1\_21027079440000**

API 21027079440000

Permit Number 7944

Lease Name Waage, Olle

Well Number 1

County Cass

Township 05S

Range 16W

Section 22

2021 DEQ or Pure co\_name Little Four Oil Company

Pure Number 36

Latitude 42.0228

Longitude -86.15471

THE PURE OIL COMPANY

DATE August 28, 1940

## LOCATION REPORT

No.

STATE Michigan COUNTY Cass DISTRICT Silver Creek TWP. Silver Creek SEC. 22 TOWN 5 S RANGE 16 W  
 WELL No. 1 (SERIAL No. 36) FARM Olle Waage ACRES

NAME OF STREAM OR WATERS

QUADRANGLE NW SW NEOPERATOR Little Four Oil CompanyMap Silver Creek Township, Cass County

330 330 Feet from North Line of Farm  
Little Four Oil Co.

" " East " " "

" " South " " "

330 330 " " West " " "

Feet from North Line of Section

" " East " " "

990 990 " " South " " 1/4

330 330 " " West " " "

## LEGEND

○ LOCATION

① RIG

⊕ DRILLING

☼ GAS WELL

● OIL WELL

⬮ SMALL OIL WELL

⊙ DRY HOLE

⬮ DRY SHOWING OIL

⊙ DRY SHOWING GAS

⊙ ABANDONED LOCATION

⬮ ABANDONED GAS WELL

⬮ ABANDONED OIL WELL

NOTE: Below make tracing from map. (when no map is obtainable make sketch) showing farm, center of section, this location with measurements and also wells, dry holes, or other locations in the vicinity of this location.

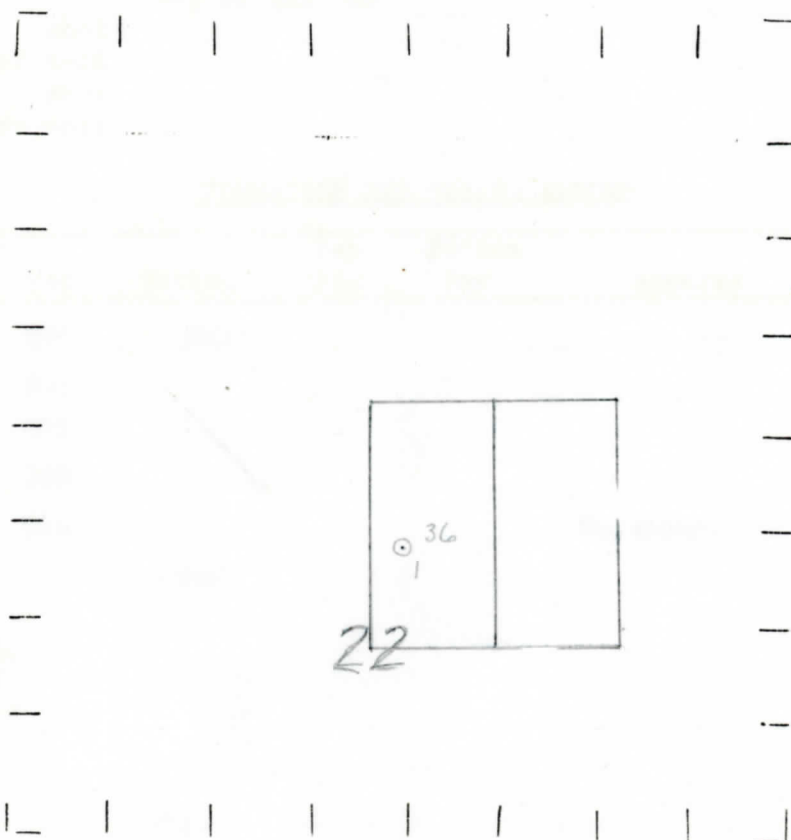

REMARKS:

SIGNED

Subintendent or Foreman.

Michigan Producing Division

# PRODUCTION RECORD

### FORMATION AND CASING RECORD

Remarks

Signed D. C. Shackelford