



Western Michigan University
ScholarWorks at WMU

Legacy Scout Tickets from Pure Oil Company

8-20-2021

MGRRE_PureOilScoutTickets_Flynn_3_21027080120000

MGRRE

Western Michigan University

Follow this and additional works at: <https://scholarworks.wmich.edu/pure>



Part of the Geology Commons

WMU ScholarWorks Citation

MGRRE, "MGRRE_PureOilScoutTickets_Flynn_3_21027080120000" (2021). *Legacy Scout Tickets from Pure Oil Company*. 11023.

<https://scholarworks.wmich.edu/pure/11023>

This Document is brought to you for free and open access via ScholarWorks at WMU. It has been accepted for inclusion in Legacy Scout Tickets from Pure Oil Company by an authorized administrator of ScholarWorks at WMU. See the National Digital Catalogue - Science Base Catalogue for more collections submitted by MGRRE.



MGRRE_PureOilScoutTickets_Flynn_3_21027080120000

API 21027080120000

Permit Number 8012

Lease Name Flynn

Well Number 3

County Cass

Township 05S

Range 16W

Section 23

2021 DEQ or Pure co_name Silver Creek Oil Company

Pure Number 37

Latitude 42.02274

Longitude -86.14261

THE PURE OIL COMPANY

LOCATION REPORT

No.

DATE September 18, 1940
Date February 1, 1944

A.F.E. No. _____

Division Mich. Producing District _____ Lease FlynnAcres _____ Lease No. _____ Elevation _____ Well No. 3 (Serial No. 37)Quadrangle NE SW NW Sec. 23 Twp. 5 S Rge. 16 W Twp. Silver CreekSurvey _____ County Cass State MichiganOperator Silver Creek Oil Company Map Silver Creek Township, Cass County

____ Feet from North Line of Lease

____ " " East " " "

____ " " South " " "

____ " " West " " "

____ Feet from North Line of Section

____ " " East " " "

____ " " South " " "

____ " " West " " "

LEGEND

○ Location



Gas Well



Oil Well



Gas-Distillate Well



Dry Hole



Dry Showing Oil



Dry Showing Gas



Abandoned Location

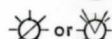

Abandoned Gas Well

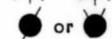

Abandoned Oil Well



Input Well

Plugged and abandoned 6-24-43.

Total Depth 1115'.

N

Remarks: _____ Scale _____

Submitted by _____ Civil Engineer Approved by _____ Division Manager

Approved by _____ Vice-President-General Manager

Division Michigan District Division
Date 6-24-43
WELL No. 3 (Serial No. 33)
TOWN 53 RANGE 18 W
STATE Michigan COUNTY Cass TWP. Silver Creek SEC. 23
WELL No. 3 (SERIAL No. 37) FARM Flynn ACRES

NAME OF STREAM OR WATERS QUADRANGLE NE 51 NW
OPERATOR Silver Creek Oil Company Map Silver Creek Township, Cass County
Silver Creek Oil Co. Silver Creek - Cass

Feet from North Line of Farm
330 330 " " East " " "
990 990 " " South " " "
" " West " " "
Feet from North Line of Section
990 990 " " East " " "
990 990 " " South " 1/4 "
990 990 " " West " " "

- LEGEND
- LOCATION
 - ① RIG
 - ⊕ DRILLING
 - ☼ GAS WELL
 - OIL WELL
 - SMALL OIL WELL
 - ⊙ DRY HOLE
 - ⊕ DRY SHOWING OIL
 - ⊙ DRY SHOWING GAS
 - ⊙ ABANDONED LOCATION
 - ☼ ABANDONED GAS WELL
 - ABANDONED OIL WELL

NOTE: Below make tracing from map. (when no map is obtainable make sketch) showing farm, center of section, this location with measurements and also wells, dry holes, or other locations in the vicinity of this location.

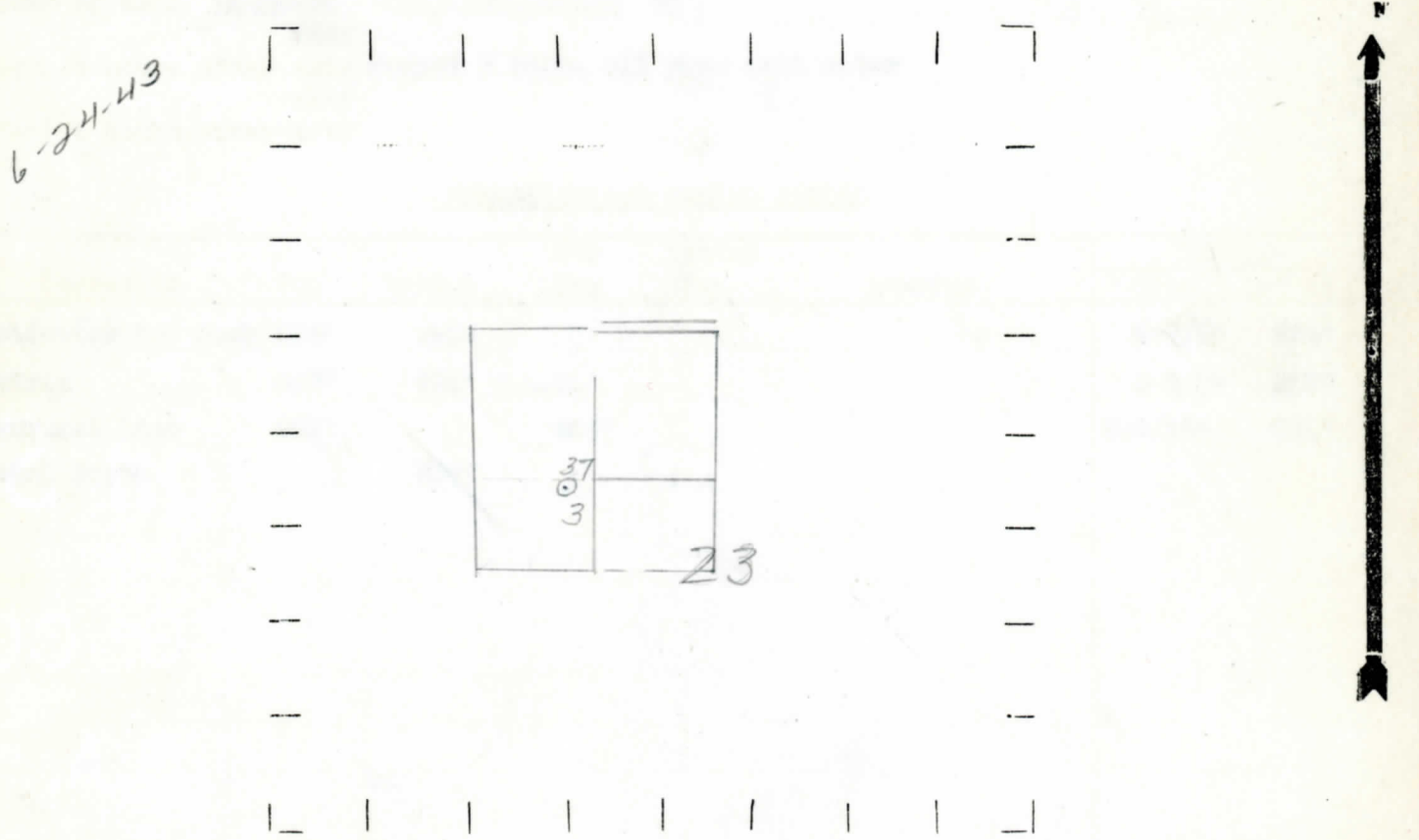

REMARKS:

2975-92
590-4990
SIGNED
Superintendent or Foreman

Michigan Producing Division

Date June 23, 1943 No. 37
State Mich. County Cass Dist. Twp. Silver Creek Sec. 23 Twp. 5 S Rge. 16 W
(Serial No.)
Well No. 3 (County No.) 37 Farm Flynn Acres
Operator Silver Creek Oil Company By
Information secured from Scouting Department
Date well started Date well completed 6-20-43 Elevation 735.4

PRODUCTION RECORD

Dry Hole

1st 24 hours natural

2nd 24 hours natural

Date of shot	No. of quarts	From	to	From	to
Date of acid	No. of gallons				
1st 24 hours after acid	shot				
2nd 24 hours after acid	shot				

FORMATION AND CASING RECORD

[illegible]

Remarks Hole full black sulphur water 822 - show gas 850' ?. Recently deepened from its old total depth of 807' with no results - additional information to our former Completion Report.

Signed D. C. Shackelford