



Western Michigan University  
ScholarWorks at WMU

---

Legacy Scout Tickets from Pure Oil Company

---

8-20-2021

**MGRRE\_PureOilScoutTickets\_Good, John J.\_1\_21027080750000**

MGRRE

*Western Michigan University*

Follow this and additional works at: <https://scholarworks.wmich.edu/pure>



Part of the Geology Commons

---

#### WMU ScholarWorks Citation

MGRRE, "MGRRE\_PureOilScoutTickets\_Good, John J.\_1\_21027080750000" (2021). *Legacy Scout Tickets from Pure Oil Company*. 11025.

<https://scholarworks.wmich.edu/pure/11025>

This Document is brought to you for free and open access via ScholarWorks at WMU. It has been accepted for inclusion in Legacy Scout Tickets from Pure Oil Company by an authorized administrator of ScholarWorks at WMU. See the National Digital Catalogue - Science Base Catalogue for more collections submitted by MGRRE.



---

**MGRRE\_PureOilScoutTickets\_Good, John J.\_1\_21027080750000**

API 21027080750000

Permit Number 8075

Lease Name Good, John J.

Well Number 1

County Cass

Township 08S

Range 15W

Section 15

2021 DEQ or Pure co\_name Tamblyn, R. B. Development Company

Pure Number 39

Latitude 41.76815

Longitude -86.04358

THE PURE OIL COMPANY

DATE October 2, 1940

## LOCATION REPORT

No. 39

STATE Michigan COUNTY Cass DIST. Ontwa TWP. Ontwa SEC. 15 TOWN 8 S RANGE 15 W  
 WELL No. 1 (SERIAL No. 339) FARM John J. Good ACRES 15

NAME OF STREAM OR WATERS \_\_\_\_\_ QUADRANGLE SW SE SWOPERATOR R. B. Tambllyn Development Company Map Ontwa Township, Cass County

Feet from North Line of Farm

330 330 " " East " " "  
 330 330 " " South " " "  
 " " West " " "

Feet from North Line of Section

990 990 " " East " " "  
 330 330 " " South " " "  
 " " West " " "

## LEGEND

○ LOCATION

① RIG

⊕ DRILLING

⊗ GAS WELL

● OIL WELL

◆ SMALL OIL WELL

⊙ DRY HOLE

⊕ DRY SHOWING OIL

⊗ DRY SHOWING GAS

⊙ ABANDONED LOCATION

⊗ ABANDONED GAS WELL

◆ ABANDONED OIL WELL

NOTE: Below make tracing from map. (when no map is obtainable make sketch) showing farm, center of section, this location with measurements and also wells, dry holes, or other locations in the vicinity of this location.

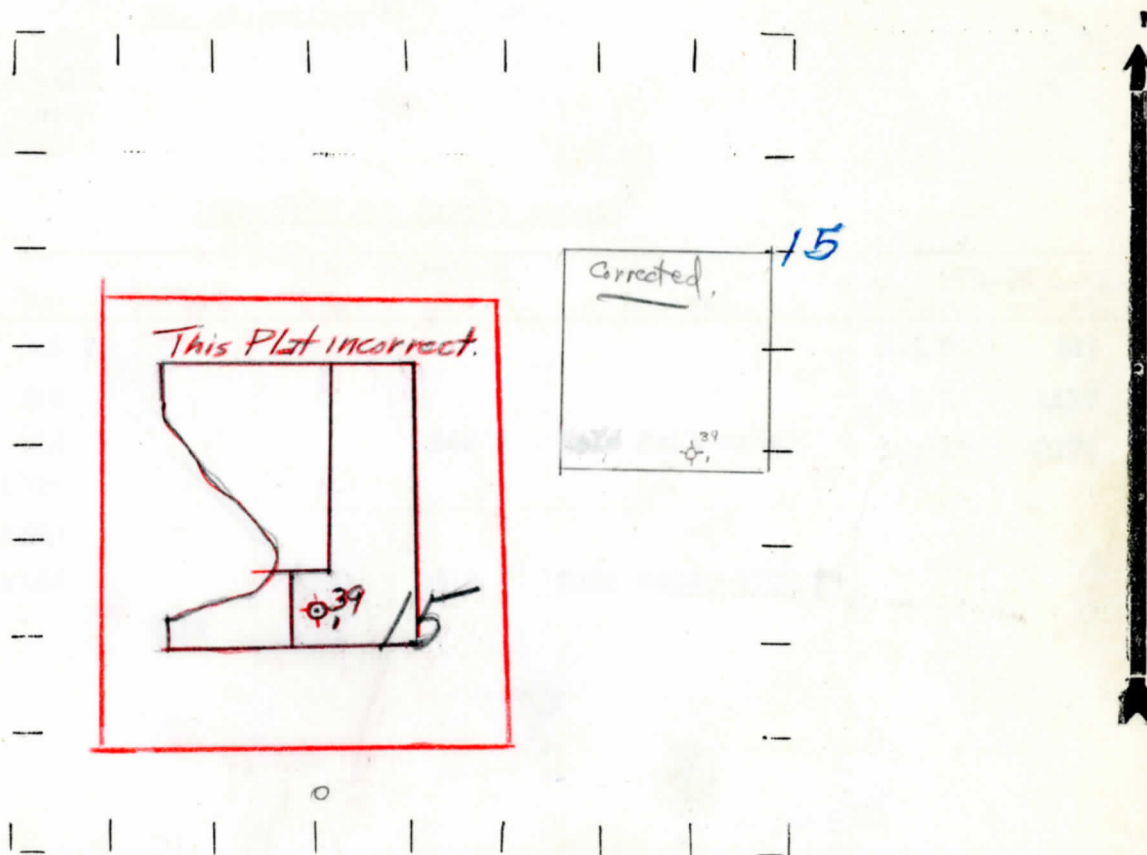

REMARKS:

SIGNED

Superintendent or Foreman.

D. C. Shackelford