



Western Michigan University
ScholarWorks at WMU

Legacy Scout Tickets from Pure Oil Company

8-20-2021

MGRRE_PureOilScoutTickets_Wilhelm, John_1_21027086270000

MGRRE

Western Michigan University

Follow this and additional works at: <https://scholarworks.wmich.edu/pure>



Part of the Geology Commons

WMU ScholarWorks Citation

MGRRE, "MGRRE_PureOilScoutTickets_Wilhelm, John_1_21027086270000" (2021). *Legacy Scout Tickets from Pure Oil Company*. 11029.

<https://scholarworks.wmich.edu/pure/11029>

This Document is brought to you for free and open access via ScholarWorks at WMU. It has been accepted for inclusion in Legacy Scout Tickets from Pure Oil Company by an authorized administrator of ScholarWorks at WMU. See the National Digital Catalogue - Science Base Catalogue for more collections submitted by MGRRE.



MGRRE_PureOilScoutTickets_Wilhelm, John_1_21027086270000

API 21027086270000

Permit Number 8627

Lease Name Wilhelm, John

Well Number 1

County Cass

Township 08S

Range 15W

Section 12

2021 DEQ or Pure co_name Smith, N. N.

Pure Number 43

Latitude 41.78403

Longitude -85.99962

THE PURE OIL COMPANY

DATE May 21, 1941

LOCATION REPORT

No. 43

STATE Michigan COUNTY Cass TWP. Ontwa SEC. 122 TOWN 8 S RANGE 15 W
 WELL No. 1 (SERIAL No. 43) FARM John Wilhelm ACRES 154

NAME OF STREAM OR WATERS _____ QUADRANGLE NW SW SE SW - SEOPERATOR N. N. Smith Map Ontwa Township, Cass County

Feet from North Line of Farm

250 250 " " North East " " "

" " South " " "

330 330 " " West " " "

Feet from North Line of Section

" " East " " "

750 750 " " South " 1/4 "

431 431 " " West " " "

LEGEND

○ LOCATION

① RIG

⊕ DRILLING

☼ GAS WELL

● OIL WELL

◆ SMALL OIL WELL

⊙ DRY HOLE

◆ DRY SHOWING OIL

⊙ DRY SHOWING GAS

⊙ ABANDONED LOCATION

☼ ABANDONED GAS WELL

◆ ABANDONED OIL WELL

NOTE: Below make tracing from map, (when no map is obtainable make sketch) showing farm, center of section, this location with measurements and also wells, dry holes, or other locations in the vicinity of this location.

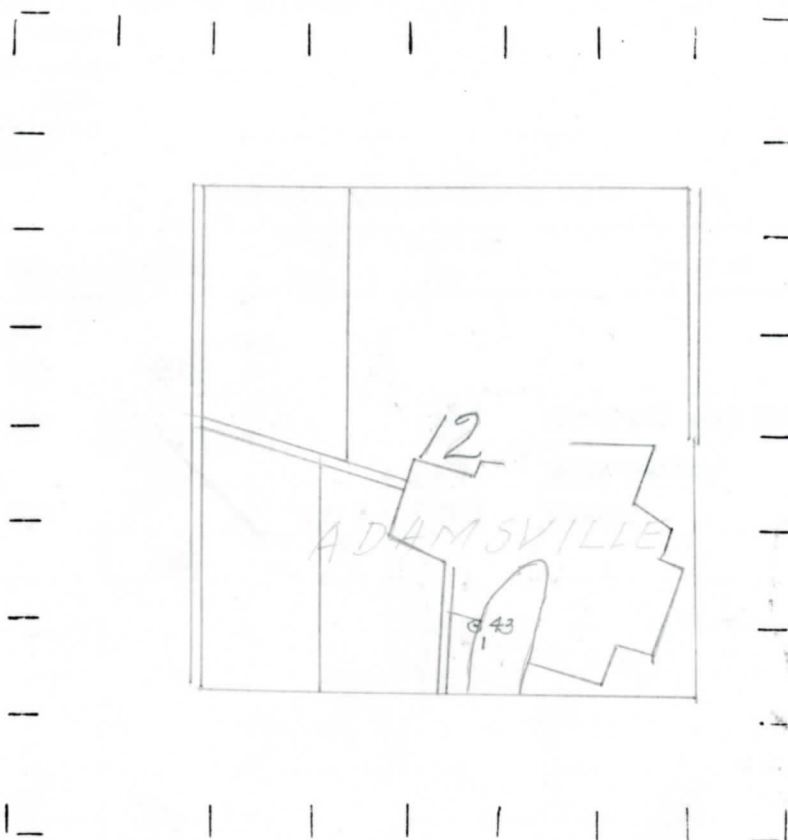

REMARKS:

SIGNED

Superintendent or Foreman.

No. 43

(Serial No.)

By _____

Date well started 6-4-41 Date well completed 6-20-41 Elevation 807.5

1st 24 hours natural	Dry Hole
----------------------	----------

2nd 24 hours natural

[illegible]

shot

1st 24 hours after acid

shot

2nd 24 hours after acid

[illegible]

Remarks

Signed D. C. Shackelford