



Western Michigan University  
ScholarWorks at WMU

---

Legacy Scout Tickets from Pure Oil Company

---

8-20-2021

**MGRRE\_PureOilScoutTickets\_Smith, Grace  
E.\_1\_21027087030000**

MGRRE  
*Western Michigan University*

Follow this and additional works at: <https://scholarworks.wmich.edu/pure>



Part of the Geology Commons

---

#### **WMU ScholarWorks Citation**

MGRRE, "MGRRE\_PureOilScoutTickets\_Smith, Grace E.\_1\_21027087030000" (2021). *Legacy Scout Tickets from Pure Oil Company*. 11031.  
<https://scholarworks.wmich.edu/pure/11031>

This Document is brought to you for free and open access via ScholarWorks at WMU. It has been accepted for inclusion in Legacy Scout Tickets from Pure Oil Company by an authorized administrator of ScholarWorks at WMU. See the National Digital Catalogue - Science Base Catalogue for more collections submitted by MGRRE.



---

**MGRRE\_PureOilScoutTickets\_Smith, Grace E.\_1\_21027087030000**

API 21027087030000

Permit Number 8703

Lease Name Smith, Grace E.

Well Number 1

County Cass

Township 07S

Range 13W

Section 29

2021 DEQ or Pure co\_name Phillips, Sue Stradley

Pure Number 45

Latitude 41.8356

Longitude -85.8389

## THE PURE OIL COMPANY

DATE June 25, 1941

## LOCATION REPORT

No. 45

STATE Michigan COUNTY Cass DISTRICT North Porter TWP. North Porter SEC. 29 9 TOWN 7 S RANGE 13 W  
 WELL No. 11 (SERIAL No. 45) FARM Grace E. Smith ACRES

NAME OF STREAM OR WATERS \_\_\_\_\_ QUADRANGLE SE NE NE

OPERATOR Sue Stradley Phillips Map North Porter Township, Cass County  
Sue Stradley Phillips North Porter Twp

Feet from North Line of Farm

330 330 " " East " " "330 330 " " South " " "

" " West " " "

990 990 Feet from North Line of Section 1/4 1/4330 330 " " East " " "

" " South " " "

" " West " " "

## LEGEND

○ LOCATION

⊙ RIG

⊕ DRILLING

☀ GAS WELL

● OIL WELL

⬮ SMALL OIL WELL

⊙ DRY HOLE

⬮ DRY SHOWING OIL

⊙ DRY SHOWING GAS

⊙ ABANDONED LOCATION

☀ ABANDONED GAS WELL

⬮ ABANDONED OIL WELL

NOTE: Below make tracing from map. (when no map is obtainable make sketch) showing farm, center of section, this location with measurements and also wells, dry holes, or other locations in the vicinity of this location.

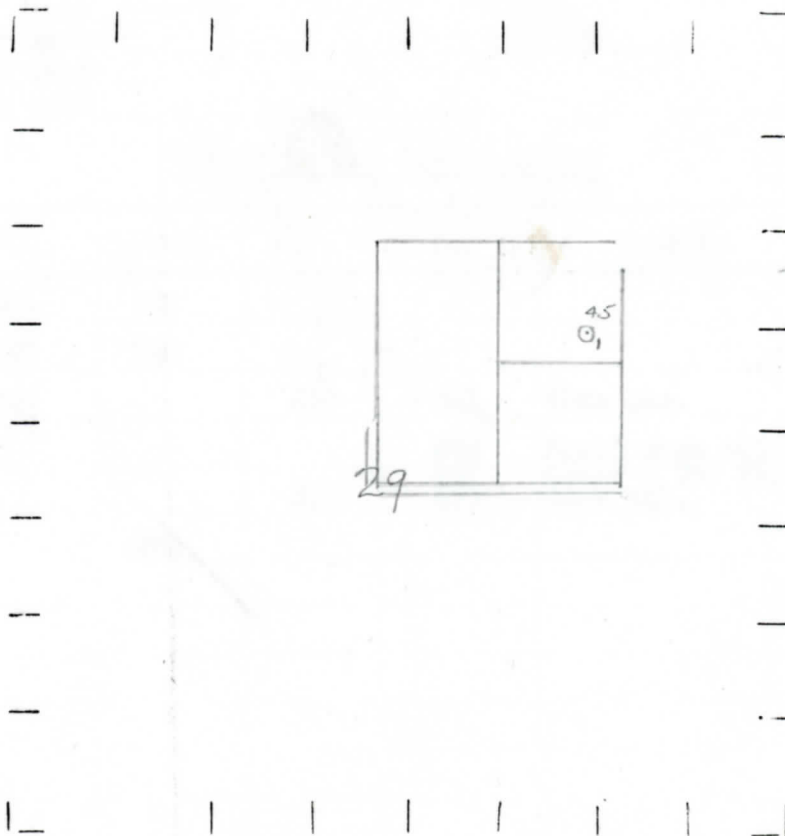

REMARKS:

SIGNED

W  
 Superintendent or Foreman.

