



Western Michigan University  
ScholarWorks at WMU

---

Legacy Scout Tickets from Pure Oil Company

---

8-20-2021

## MGRRE\_PureOilScoutTickets\_Marks & Stutsman\_1\_21027088340000

MGRRE  
*Western Michigan University*

Follow this and additional works at: <https://scholarworks.wmich.edu/pure>



Part of the Geology Commons

---

### WMU ScholarWorks Citation

MGRRE, "MGRRE\_PureOilScoutTickets\_Marks & Stutsman\_1\_21027088340000" (2021). *Legacy Scout Tickets from Pure Oil Company*. 11033.  
<https://scholarworks.wmich.edu/pure/11033>

This Document is brought to you for free and open access via ScholarWorks at WMU. It has been accepted for inclusion in Legacy Scout Tickets from Pure Oil Company by an authorized administrator of ScholarWorks at WMU. See the National Digital Catalogue - Science Base Catalogue for more collections submitted by MGRRE.



---

## MGRRE\_PureOilScoutTickets\_Marks & Stutsman\_1\_21027088340000

API 21027088340000

Permit Number 8834

Lease Name Marks & Stutsman

Well Number 1

County Cass

Township 07S

Range 13W

Section 32

2021 DEQ or Pure co\_name Doblinger, M J

Pure Number 47

Latitude 41.82077

Longitude -85.85333

DATE August 13, 1941

## LOCATION REPORT

No. 47

STATE Michigan COUNTY Cass DIST. North Porter TWP. North Porter SEC. 32 TOWN 7S RANGE 13W  
 WELL No. 1 (SERIAL No. 47) FARM Marks and Stutsman ACRES

NAME OF STREAM OR WATERS \_\_\_\_\_ QUADRANGLE SE NW NWOPERATOR M. J. Dobliger Map North Porter Township, Cass CountyM. J. Dobliger

Feet from North Line of Farm

750 750 " " East " " "215 215 " " South " " "

" " West " " "

1160 1160 Feet from North Line of Section 1/4

" " East " " "

" " South " " "

1010 1010 " " West " " "

## LEGEND

○ LOCATION

⊙ RIG

⊕ DRILLING

☼ GAS WELL

● OIL WELL

⬮ SMALL OIL WELL

⊙ DRY HOLE

⬮ DRY SHOWING OIL

☼ DRY SHOWING GAS

⊙ ABANDONED LOCATION

☼ ABANDONED GAS WELL

⬮ ABANDONED OIL WELL

NOTE: Below make tracing from map. (when no map is obtainable make sketch) showing farm, center of section, this location with measurements and also wells, dry holes, or other locations in the vicinity of this location.

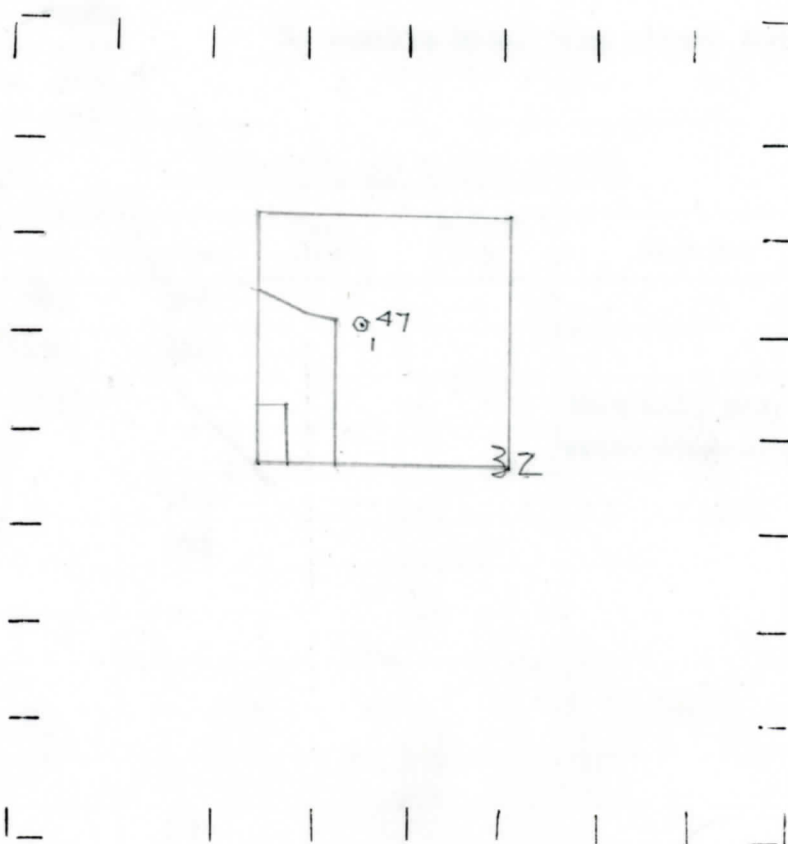

REMARKS:

SIGNED

Superintendent or Foreman.

