



Western Michigan University
ScholarWorks at WMU

Legacy Scout Tickets from Pure Oil Company

8-20-2021

MGRRE_PureOilScoutTickets_Roberts_2_21027088590000

MGRRE

Western Michigan University

Follow this and additional works at: <https://scholarworks.wmich.edu/pure>



Part of the Geology Commons

WMU ScholarWorks Citation

MGRRE, "MGRRE_PureOilScoutTickets_Roberts_2_21027088590000" (2021). *Legacy Scout Tickets from Pure Oil Company*. 11034.

<https://scholarworks.wmich.edu/pure/11034>

This Document is brought to you for free and open access via ScholarWorks at WMU. It has been accepted for inclusion in Legacy Scout Tickets from Pure Oil Company by an authorized administrator of ScholarWorks at WMU. See the National Digital Catalogue - Science Base Catalogue for more collections submitted by MGRRE.



MGRRE_PureOilScoutTickets_Roberts_2_21027088590000

API 21027088590000

Permit Number 8859

Lease Name Roberts

Well Number 2

County Cass

Township 08S

Range 15W

Section 23

2021 DEQ or Pure co_name Barnaby, Horace T. Trustee

Pure Number 48

Latitude 41.76348

Longitude -86.02903

WELL REPORT - OUTSIDE OPERATIONS

SERIAL NO. 48

STATE Michigan ^{PSM} _{CO.} Cass
OPERATOR Horace T. Barnaby, Tr.
FARM Roberts WELL NO. 2
TWP. Ontwa S. 23 T. 8 S R. 15 W
~~xxxxxx~~
LOC. NW SW NW

WILDCAT ☐ FIELD ☒ FIELD NAME Edwardsburg

MAP NO. _____ CO-ORD. _____ ELEV. _____

STATUS Plugged and Abandoned 10-28-47Total Depth 627' - Deepended to 652'.

NORTH

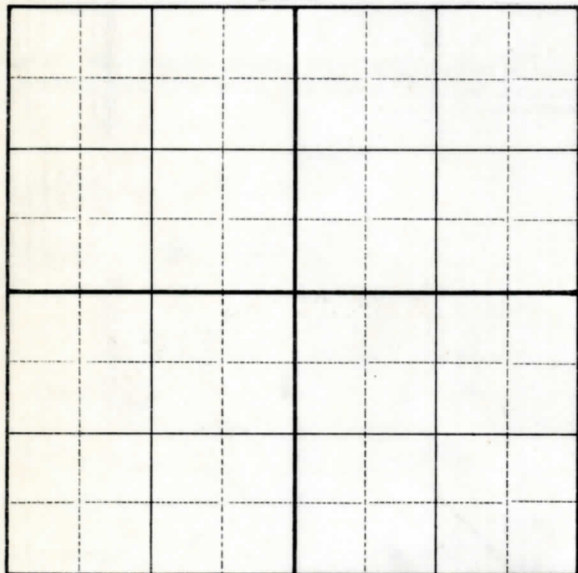
DATE 11-12-47 SCOUT H.J.G.

DATE August 20, 1941

THE PURE OIL COMPANY

LOCATION REPORT

No. 48

STATE Michigan COUNTY Cass DIST. Ontwa TWP. Ontwa SEC. 23 TOWN 8 S RANGE 15 W
WELL No. 22 (SERIAL No. 48) FARM Roberts ACRES

NAME OF STREAM OR WATERS QUADRANGLE NW 1/4 SW 1/4 - NW 1/4

OPERATOR Horace T. Barnaby, Tr. Map Ontwa Township, Cass County
Horace T. Barnaby Tr. Ontwa Cass

Feet from North Line of Farm

990	990	"	"	East	"	"	"
330	330	"	"	South	"	"	"
		"	"	West	"	"	"

Feet from North Line of Section

1122	1122	"	"	East	"	"	"
330	330	"	"	South	"	"	"
		"	"	West	"	"	"

- LEGEND
- LOCATION
 - ① RIG
 - ⊕ DRILLING
 - ☼ GAS WELL
 - OIL WELL
 - ◆ SMALL OIL WELL

- ⊙ DRY HOLE
- ◆ DRY SHOWING OIL
- ⊙ DRY SHOWING GAS
- ⊙ ABANDONED LOCATION
- ☼ ABANDONED GAS WELL
- ◆ ABANDONED OIL WELL

NOTE: Below make tracing from map. (when no map is obtainable make sketch) showing farm, center of section, this location with measurements and also wells, dry holes, or other locations in the vicinity of this location.

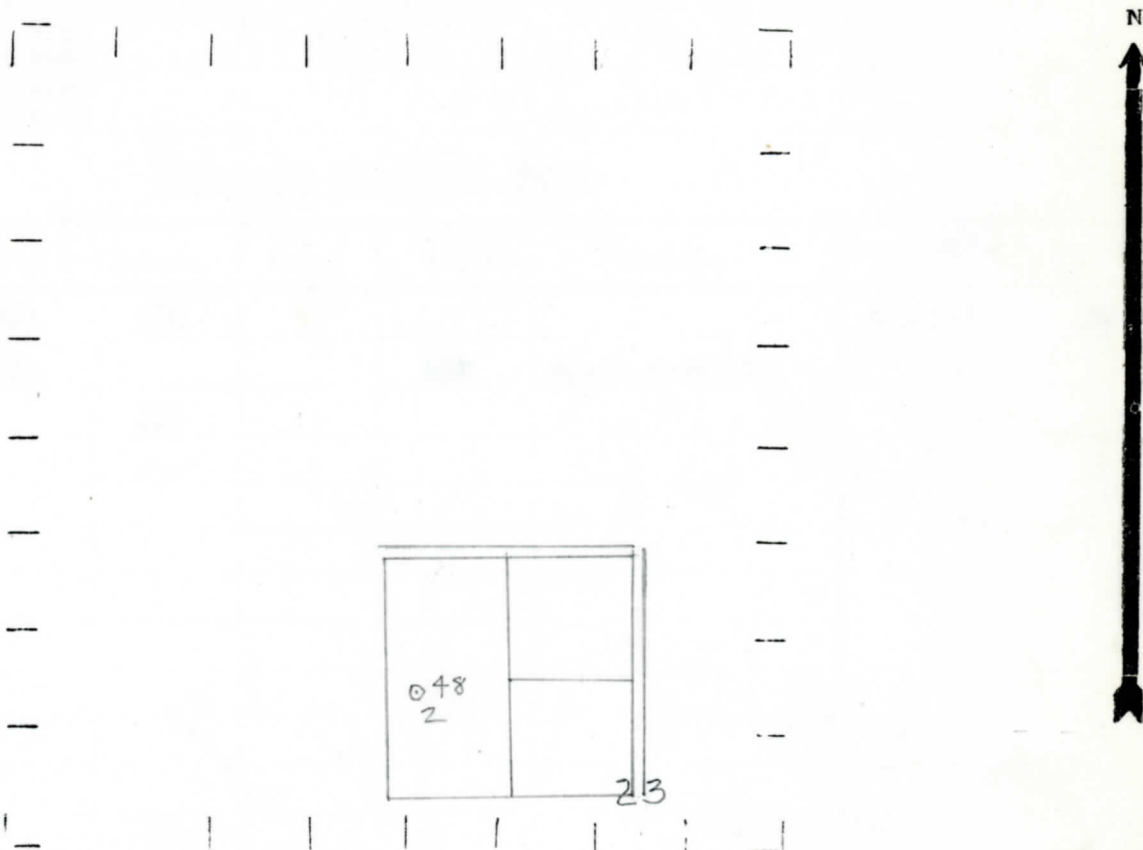

REMARKS:

SIGNED

W

Superintendent or Foreman.

