



Western Michigan University
ScholarWorks at WMU

Legacy Scout Tickets from Pure Oil Company

8-20-2021

MGRRE_PureOilScoutTickets_Berkley_1_21027088930000

MGRRE

Western Michigan University

Follow this and additional works at: <https://scholarworks.wmich.edu/pure>



Part of the Geology Commons

WMU ScholarWorks Citation

MGRRE, "MGRRE_PureOilScoutTickets_Berkley_1_21027088930000" (2021). *Legacy Scout Tickets from Pure Oil Company*. 11036.

<https://scholarworks.wmich.edu/pure/11036>

This Document is brought to you for free and open access via ScholarWorks at WMU. It has been accepted for inclusion in Legacy Scout Tickets from Pure Oil Company by an authorized administrator of ScholarWorks at WMU. See the National Digital Catalogue - Science Base Catalogue for more collections submitted by MGRRE.



MGRRE_PureOilScoutTickets_Berkley_1_21027088930000

API 21027088930000

Permit Number 8893

Lease Name Berkley

Well Number 1

County Cass

Township 05S

Range 14W

Section 19

2021 DEQ or Pure co_name Murray, Alton C.

Pure Number 50

Latitude 42.01708

Longitude -85.98212

DATE August 27, 1941

LOCATION REPORT

No. 50

STATE Michigan COUNTY Cass Violina TWP. Violina Division 19 SEC. 19 TOWN 55 RANGE 14 W
 WELL No. 1 (SERIAL No. 50) FARM Berkey ACRES

NAME OF STREAM OR WATERS

QUADRANGLE 34 NW SEOPERATOR Alton C. Murray

Map

Violina Township, Cass County990 990 Feet from North Line of Farm

" " East " " "

" " South " " "

330 330 " " West " " "990 990 Feet from North Line of Section 1/4 114

" " East " " "

" " South " " "

330 330 " " West " " "

LEGEND

○ LOCATION

① RIG

⊕ DRILLING

☀ GAS WELL

● OIL WELL

◆ SMALL OIL WELL

⊙ DRY HOLE

◆ DRY SHOWING OIL

⊙ DRY SHOWING GAS

⊙ ABANDONED LOCATION

☀ ABANDONED GAS WELL

◆ ABANDONED OIL WELL

NOTE: Below make tracing from map. (when no map is obtainable make sketch) showing farm, center of section, this location with measurements and also wells, dry holes, or other locations in the vicinity of this location.

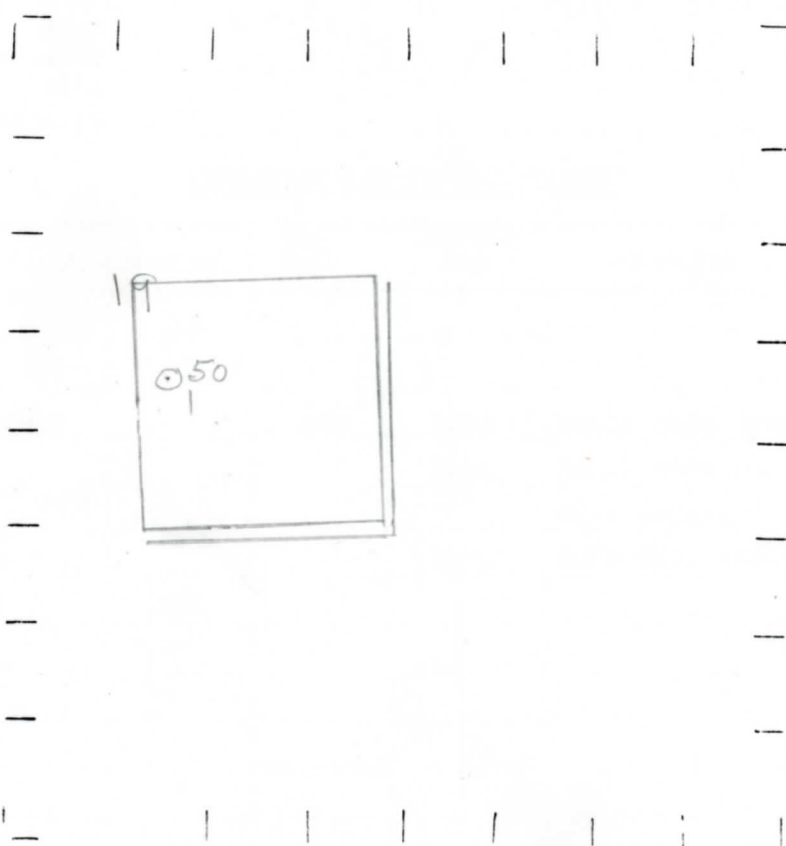

REMARKS:

SIGNED

Superintendent or Foreman.

