



Western Michigan University
ScholarWorks at WMU

Legacy Scout Tickets from Pure Oil Company

8-20-2021

**MGRRE_PureOilScoutTickets_Ostrom,
Wallace_1_21027109260000**

MGRRE
Western Michigan University

Follow this and additional works at: <https://scholarworks.wmich.edu/pure>



Part of the Geology Commons

WMU ScholarWorks Citation

MGRRE, "MGRRE_PureOilScoutTickets_Ostrom, Wallace_1_21027109260000" (2021). *Legacy Scout Tickets from Pure Oil Company*. 11042.
<https://scholarworks.wmich.edu/pure/11042>

This Document is brought to you for free and open access via ScholarWorks at WMU. It has been accepted for inclusion in Legacy Scout Tickets from Pure Oil Company by an authorized administrator of ScholarWorks at WMU. See the National Digital Catalogue - Science Base Catalogue for more collections submitted by MGRRE.



MGRRE_PureOilScoutTickets_Ostrom, Wallace_1_21027109260000

API 21027109260000

Permit Number 10926

Lease Name Ostrom, Wallace

Well Number 1

County Cass

Township 08S

Range 14W

Section 22

2021 DEQ or Pure co_name Lee and Ostrom Syndicate

Pure Number 56

Latitude 41.76258

Longitude -85.93476

THE PURE OIL COMPANY

LOCATION REPORT

Date July 26, 1944 A.F.E. No. Wallace Ostrom
 Division Mich. Producing District _____ Lease Wallace Ostrom
 Acres _____ Lease No. _____ Elevation 14W Well No. 1 (Serial No. 56)
 Quadangle NW-SW-NW Sec. 22 Twp. 8 S Rge. 14 W Twp. Mason
 Survey Lee & Ostrom Syndicate County Cass State Michigan
 Operator Lee & Ostrom Syndicate Map Mason Township, Cass County

330 330 Feet from North Line of Lease
 " " East " " "
 " " South " " "
330 330 " " West " " "
 Feet from North Line of Section
 " " East " " "
990 990 " " South " " 1/4
330 330 " " West " " "

LEGEND

○ Location



Gas Well



Oil Well



Gas-Distillate Well



Dry Hole



Dry Showing Oil



Dry Showing Gas



Abandoned Location

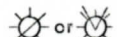

Abandoned Gas Well



Abandoned Oil Well

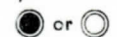

Input Well

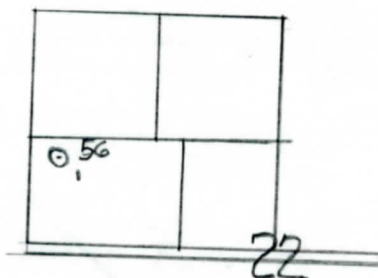

N

Scale _____

Remarks: _____

Submitted by RN Civil Engineer

Approved by _____ Division Manager

Approved by _____ Vice-President-General Manager

A.E.E. NO

COMPLETION RECORD OF WELLS DRILLED BY OTHER OPERATORS

Michigan Producing Division

Date **August 22, 1945**

No. 56

State **Michigan** Co. **Cass** Twp. **Mason** Sec. **22** Twp. **8 S** Rge. **14 W**

Well No. 1 Serial No. 56 Farm Wallace Ostrom Acres

Operator **Lee and Ostrom Syndicate**

Date started 4-3-45 Date completed 6-18-45 Elevation 784.3

PRODUCTION RECORD

1st 24 hours natural

	No. of						
Date of shot	quarts	From	To	From	to		

Date of acid	No. of gallons
shot	
1st 24 hours after acid	

Completed as: Oil Well _____ Gas Well _____ Dry Hole **X**

FORMATION AND CASING RECORD

Formation	Top	Bottom	Top Pay	Bottom Pay	Remarks	Casing	
						Size	Set at
Coldw. Red Rock	210	220	(+574)			10"	176
Antrim (light)	547	(+237)				6-5/8"	237
Antrim (dark)	567	635	(+217)			4"	625
Traverse Lime	670	(+114)			200 ft. salt water		
Traverse Lm.	635	(+149)			in 10 min. 675-677.	(+109)	
Total Depth		850	(-66)				

Remarks

Signed

D. C. Shackelford