



Western Michigan University  
ScholarWorks at WMU

---

Legacy Scout Tickets from Pure Oil Company

---

8-20-2021

MGRRE\_PureOilScoutTickets\_Barrett,  
Richard\_1\_21027111650000

MGRRE  
*Western Michigan University*

Follow this and additional works at: <https://scholarworks.wmich.edu/pure>



Part of the Geology Commons

---

#### WMU ScholarWorks Citation

MGRRE, "MGRRE\_PureOilScoutTickets\_Barrett, Richard\_1\_21027111650000" (2021). *Legacy Scout Tickets from Pure Oil Company*. 11044.  
<https://scholarworks.wmich.edu/pure/11044>

This Document is brought to you for free and open access via ScholarWorks at WMU. It has been accepted for inclusion in Legacy Scout Tickets from Pure Oil Company by an authorized administrator of ScholarWorks at WMU. See the National Digital Catalogue - Science Base Catalogue for more collections submitted by MGRRE.



---

**MGRRE\_PureOilScoutTickets\_Barrett, Richard\_1\_21027111650000**

API 21027111650000

Permit Number 11165

Lease Name Barrett, Richard

Well Number 1

County Cass

Township 07S

Range 13W

Section 6

2021 DEQ or Pure co\_name Elliot, Walter A

Pure Number 58

Latitude 41.88994

Longitude -85.87421

Form 243 3M 9-10-41 P50 Poco

# THE PURE OIL COMPANY

## LOCATION REPORT

Date October 25, 1944

A.F.E. No. \_\_\_\_\_

Division Michigan Producing

District \_\_\_\_\_

Lease \_\_\_\_\_

Richard Barrett  
Richard Barrett

Acres \_\_\_\_\_

Lease No. \_\_\_\_\_

Elevation \_\_\_\_\_

Well No. 1(Serial No. 58)Quadrangle SW-SW-NW

SW SW NW

Sec. 6Twp. 7 SRge. 13 WTwp. North PorterNorth Porter  
North Porter

Survey \_\_\_\_\_

County Cass

Cass

State MichiganOperator Walter A. Elliot

Map \_\_\_\_\_

North Porter Twp - Cass Co  
North Porter Township, Cass County

Feet from North Line of Lease

" " East " " "

" " South " " "

" " West " " "

Feet from North Line of Section

" " East " " "

" " South " " "

" " West " " "

## LEGEND

○ Location



Gas Well



Oil Well



Gas - Distillate Well

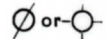

Dry Hole



Dry Showing Oil



Dry Showing Gas



Abandoned Location

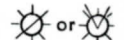

Abandoned Gas Well

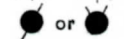

Abandoned Oil Well

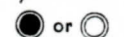

Input Well

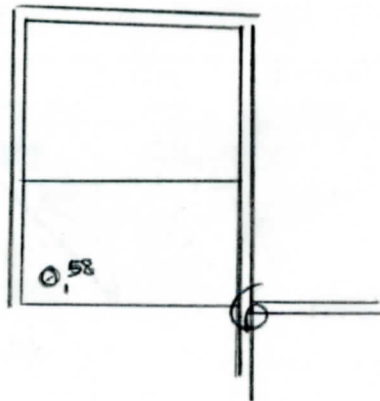

N



Remarks: \_\_\_\_\_ Scale \_\_\_\_\_

Submitted by RN \_\_\_\_\_

Civil Engineer

Approved by \_\_\_\_\_

Division Manager

Approved by \_\_\_\_\_

Vice-President - General Manager

