



Western Michigan University  
ScholarWorks at WMU

---

Legacy Scout Tickets from Pure Oil Company

---

8-20-2021

**MGRRE\_PureOilScoutTickets\_BROOKS, BYRON  
W.\_1\_21011084760000**

MGRRE  
*Western Michigan University*

Follow this and additional works at: <https://scholarworks.wmich.edu/pure>



Part of the Geology Commons

---

#### **WMU ScholarWorks Citation**

MGRRE, "MGRRE\_PureOilScoutTickets\_BROOKS, BYRON W.\_1\_21011084760000" (2021). *Legacy Scout Tickets from Pure Oil Company*. 217.  
<https://scholarworks.wmich.edu/pure/217>

This Document is brought to you for free and open access via ScholarWorks at WMU. It has been accepted for inclusion in Legacy Scout Tickets from Pure Oil Company by an authorized administrator of ScholarWorks at WMU. See the National Digital Catalogue - Science Base Catalogue for more collections submitted by MGRRE.



---

MGRRE\_PureOilScoutTickets\_BROOKS, BYRON W.\_1\_21011084760000

API 21011084760000

Permit Number 8476

Lease Name BROOKS, BYRON W.

Well Number 1

County Arenac

Township 19N

Range 4E

Section 9

2021 DEQ or Pure co\_name FISHER WILLIAM AND LAFLEUR HERBERT AND SHCILLER

Pure Number 236

Latitude 44.0603

Longitude -83.98862

## THE PURE OIL COMPANY

## LOCATION REPORT

No.

236

DATE March 12, 1941

STATE Michigan

COUNTY

Arenac

TWP

Deep River

SEC

9

TOWN

19<sup>th</sup> N

RANGE

4<sup>th</sup> E

WELL No. 1 (SERIAL No. 236) FARM

BYRON W. BROOKS

Byron W. Brooks

ACRES

NAME OF STREAM OR WATERS

QUADRANGLE C E 1/2 NE SE

OPERATOR Wm. Fisher, Herbert LaFleur and

Map

Deep River Township, Arenac County

660

Albert Schiller, Tr. Herbert LaFleur and

Deep River - Arenac

Feet from North Line of Farm

330

330

" " East " " "

" " South " " "

" " West " " "

660

660

Feet from North Line of Section

330

330

" " East " " "

" " South " " "

" " West " " "

## LEGEND

○ LOCATION

① RIG

⊕ DRILLING

☼ GAS WELL

● OIL WELL

● SMALL OIL WELL

⊙ DRY HOLE

⊙ DRY SHOWING OIL

⊙ DRY SHOWING GAS

⊙ ABANDONED LOCATION

⊙ ABANDONED GAS WELL

⊙ ABANDONED OIL WELL

NOTE: Below make tracing from map, (when no map is obtainable make sketch) showing farm, center of section, this location with measurements and also wells, dry holes, or other locations in the vicinity of this location.

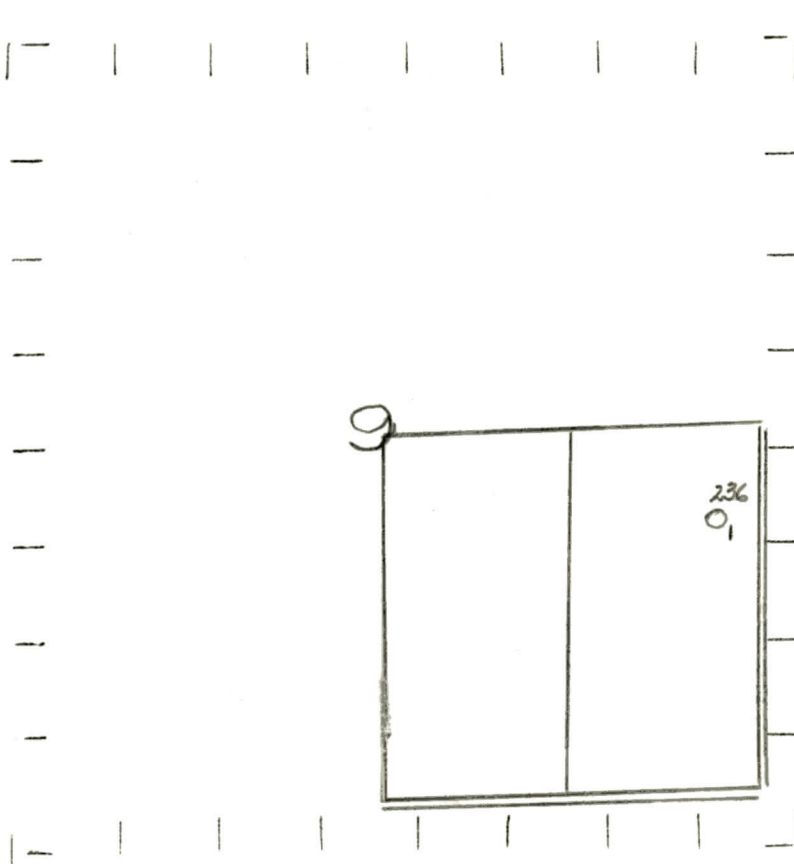

REMARKS:

SIGNED

Superintendent or Foreman.



Michigan Producing Division

Date September 10, 1941

No. 236

State Mich. County Arenac Twp. Deep River Sec. 9 Twp. 19 N Rge. 4 E

Well No. 1 (Serial No.) 236 Farm Byron W. Brooks Acres

Operator **Fisher-LaFleur-Schiller, Tr.** Information secured <sup>By</sup> ~~from~~ **Scouting Department**

Date well started 3-22-41 Date well completed 7-20-41 Elevation 747.9

## PRODUCTION RECORD

	Dry Hole
1st 24 hours natural	

2nd 24 hours natural

Date of shot ..... No. of  
quarts ..... From ..... to ..... From ..... to .....

Date of acid	No. of gallons
1911	100
1912	100
1913	100
1914	100
1915	100
1916	100
1917	100
1918	100
1919	100
1920	100
1921	100
1922	100
1923	100
1924	100
1925	100
1926	100
1927	100
1928	100
1929	100
1930	100
1931	100
1932	100
1933	100
1934	100
1935	100
1936	100
1937	100
1938	100
1939	100
1940	100
1941	100
1942	100
1943	100
1944	100
1945	100
1946	100
1947	100
1948	100
1949	100
1950	100
1951	100
1952	100
1953	100
1954	100
1955	100
1956	100
1957	100
1958	100
1959	100
1960	100
1961	100
1962	100
1963	100
1964	100
1965	100
1966	100
1967	100
1968	100
1969	100
1970	100
1971	100
1972	100
1973	100
1974	100
1975	100
1976	100
1977	100
1978	100
1979	100
1980	100
1981	100
1982	100
1983	100
1984	100
1985	100
1986	100
1987	100
1988	100
1989	100
1990	100
1991	100
1992	100
1993	100
1994	100
1995	100
1996	100
1997	100
1998	100
1999	100
2000	100
2001	100
2002	100
2003	100
2004	100
2005	100
2006	100
2007	100
2008	100
2009	100
2010	100
2011	100
2012	100
2013	100
2014	100
2015	100
2016	100
2017	100
2018	100
2019	100
2020	100
2021	100
2022	100
2023	100
2024	100
2025	100
2026	100
2027	100
2028	100
2029	100
2030	100
2031	100
2032	100
2033	100
2034	100
2035	100
2036	100
2037	100
2038	100
2039	100
2040	100
2041	100
2042	100
2043	100
2044	100
2045	100
2046	100
2047	100
2048	100
2049	100
2050	100
2051	100
2052	100
2053	100
2054	100
2055	100
2056	100
2057	100
2058	100
2059	100
2060	100
2061	100
2062	100
2063	100
2064	100
2065	100
2066	100

shot  
1st 24 hours after acid

shot  
2nd 24 hours after acid.....

## FORMATION AND CASING RECORD

Formation	Top	Bottom	Top Pay	Bottom Pay	Remarks	Casing	
						Size	Set at
Marshall	235	385				10"	145
Coldw. Red Rock	1295	1296	S.L.M.			8-1/4"	412
Sunbury	1450					6-5/8"	2496
Berea	1476			1631	Water-5 bailers		
Antrim	1631	1997					
Traverse Lime	2002		2002	2004	Small show oil and gas.		
				2150	H.F.S.W.		
Dundee	2805		2950	2955	Water.		
Total Depth		3037					

Remarks 1320' C.T.M. equals 1302' S.L.M.; 1907' C.T.M. equals 1917' S.L.M.; 2440' C.T.M. equals 2439' S.L.M.; 2746' C.T.M. equals 2749' S.L.M.; 2892' C.T.M. equals 2896' S.L.M.; 2959' C.T.M. equals 2959' S.L.M.

Signed D. C. Shackelford